

# OTTAWA COUNTY ENGINEERS OFFICE

**REFERENCE NO.** 8-6-15-1  
 SE CORNER POST SECTION 8  
 SALEM TWP.  
**SHEET** 1 OF 1.

**ROUTE:** STATE ROUTE #19  
 @ T-107 CULLMAN RD.

**TOWNSHIP:** SALEM

**SECTION:** 8

**T** 6 **NR** 15 **E.**

**PERSONNEL:**  
 M. WITTMAN, P.S.  
 J. ALLEN

**NORTHING:**

**EASTING:**

**DATUM:**

**DATE / WEATHER / TEMP:**  
 NOVEMBER 5, 2013  
 CLOUDY  
 54° F

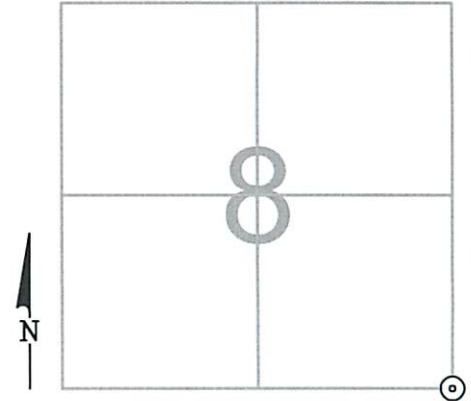

### MONUMENT INFORMATION

MONUMENT TYPE: FD PK NAIL AND WASHER  
 ON SURFACE - BELOW:  
LEFT - CL PAV'T - RIGHT: 0.50'



### MISC. INFORMATION

NO STONE FOUND. NAIL AND WASHER WAS  
 VERIFIED IN ALL FOUR DIRECTIONS AND ACCEPTED  
 AS POINT. THIS POINT HAS BEEN HISTORICALLY  
 REFERRED TO AS A NAIL AND SHINER PER COUNTY  
 SURVEY RECORDS.

AUGUST 5, 2014  
 SET 1" Ø IRON PIN IN  
 MONUMENT BOX

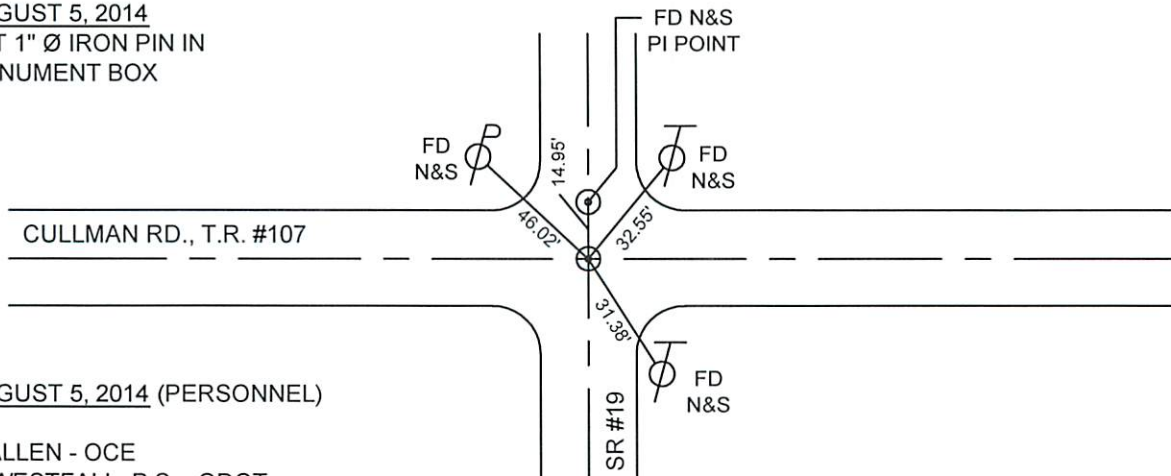

AUGUST 5, 2014 (PERSONNEL)

J. ALLEN - OCE  
 E. WESTFALL, P.S. - ODOT  
 J. LEU, J. THOMAS - ODOT  
 M&B CONSTRUCTION CREW