

# OTTAWA COUNTY ENGINEERS OFFICE

**REFERENCE NO.** 24-6-15-A  
 NW CORNER POST SEC. 24  
 SALEM TWP.  
**SHEET** 1 OF 1.

**ROUTE:** T-217 MUDDY CREEK NORTH RD.

**TOWNSHIP:** SALEM

**SECTION:** 24

**T** 6 **NR** 15 **E.**

**NORTHING:**

**EASTING:**

**DATUM:**

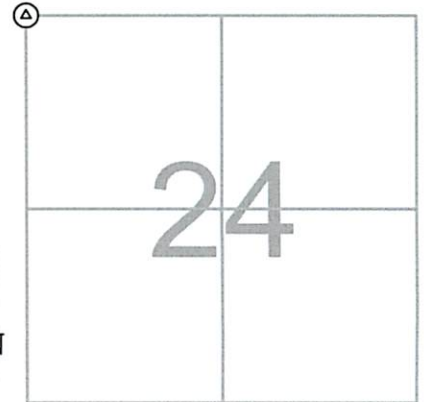

**PERSONNEL:**  
 M. WITTMAN, P.S.  
 J. ALLEN

**DATE / WEATHER / TEMP:**  
 APRIL 21, 2014  
 SUNNY - SW  
 70° F

### MONUMENT INFORMATION

MONUMENT TYPE: SET 5/8" Ø IRON PIN IN MON BOX  
ON SURFACE - BELOW:  
LEFT - CL PAV'T - RIGHT: 8.30'

FD CONCRETE MONUMENT WITH BRASS DISK  
 SEVERELY LEANING IN NORTHWESTERLY  
 DIRECTION RESET IRON PIN.



### MISC. INFORMATION

FD PK NAIL AND SHINER ON SURFACE OVER A FD CONCRETE  
 MONUMENT LEANING NORTHWESTERLY, SET BY D. GULAU PER  
 1993 SURVEY. FD PK NAIL AND SHINER CHECKED CLOSELY WITH  
 1939 WPA TIES FROM ESTABLISHMENT OF CONCRETE MONUMENT.  
 DUG UP 6" Ø CONC MON AND VERIFIED IT IS DISTURBED AND  
 LEANING. EXPOSED THE TOP 18" OF MONUMENT AND USED PROD  
 TO FIND SE MOST EDGE OF BOTTOM OF MONUMENT. MEASURED  
 3" IN LINE FROM FD SE EDGE NW TO CENTER OF TOP OF  
 MONUMENT TO DETERMINE CENTER OF MONUMENT IF IT WERE  
 UPRIGHT, A 5/8" Ø IRON PIN IN A MONUMENT BOX WAS SET AT  
 THIS POINT AS SECTION CORNER.

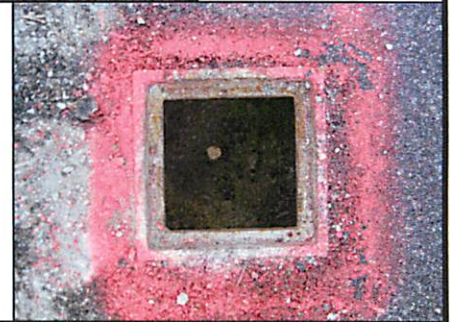

APRIL 21, 2014

SET 5/8" Ø IRON PIN IN  
 MONUMENT BOX

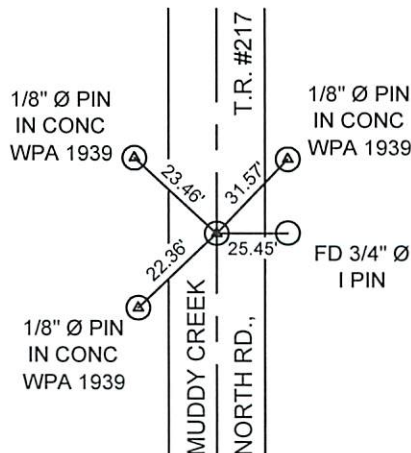

**NOTE:**  
 NW WPA 1939 WITNESS MONUMENT  
 HAS BEEN DISTURBED. NE & SW WPA  
 1939 WITNESS MONUMENT DISTANCES  
 DID NOT INTERSECT WHICH MEANS  
 ONE OR BOTH HAVE ALSO BEEN  
 DISTURBED. ARCS FROM ALL THREE  
 WITNESS MONUMENTS CREATED A  
 TRIANGULAR GAP THEREFORE A POINT  
 COULD NOT BE RESET BASED FROM  
 TIES. THE SURFACE PK NAIL AND  
 SHINER WAS LOCATED IN THE CENTER  
 OF THE TRIANGULAR GAP.