

OTTAWA COUNTY ENGINEERS OFFICE

REFERENCE NO. 20-6-15-H
 SOUTH QUARTER POST SEC. 20
 SALEM TWP.
SHEET 1 OF 1.

ROUTE: T-10 LEASER RD.

TOWNSHIP: SALEM

SECTION: 20

T 6 **NR** 15 **E.**

NORTHING:

EASTING:

DATUM:

PERSONNEL:
 M. WITTMAN, P.S.
 J. ALLEN

DATE / WEATHER / TEMP:
 NOVEMBER 4, 2013
 OVERCAST - SE
 52° F

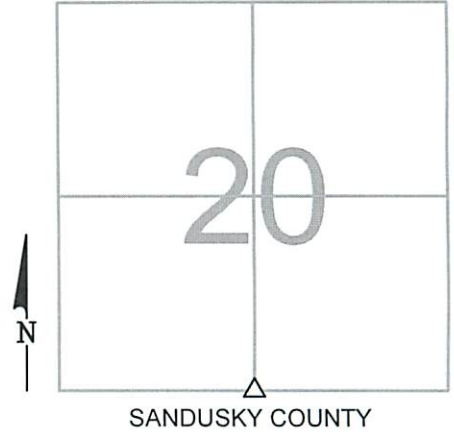

MONUMENT INFORMATION

MONUMENT TYPE: FD. 5-1/2" x 5-1/2" SQ. STONE
 ON SURFACE - BELOW: 0.76' (DITCH BANK)
 LEFT - CL PAV'T - RIGHT: 10.8'

USED SOUTH END OF HIGH RIDGE ON STONE
 AN ORANGE PAINT DOT EXISTED AT THAT POINT



MISC. INFORMATION

THERE IS AN ANCHOR BOLT / "EYE BOLT" 0.20' S.
 OF SOUTH END OF STONE

USE CAUTION WHEN UNCOVERING THIS STONE TO
 MINIMIZE DISTURBING IT'S LOCATION

