



# OTTAWA COUNTY BENCHMARK DATA SHEET



## SAL 217-0.0

Township	Section	Town	Range	Type of Monument
Salem	24	T6N	R15E	3 1/4" Domed Bronze Disk in Concrete (OCE Spec. BM-1)
<b>Set By</b>	<b>Shot By</b>	<b>Calculated</b>	<b>Calculated By</b>	<b>Published</b>
OCE / OCHD	J. Allen	March 8, 2012	M. J. Wittman, P.S.	March 16, 2012

**Location**

Northeast corner of the intersection of Muddy Creek North Rd., T.R.#217 & Woodrich Rd., T.R. #11

Vertical Control		
Vertical Datum	Method	Elevation (U.S. Survey Feet)
NAVD 88	GPS	576.15

Horizontal Control			
Horizontal Datum	Zone	Northing	Easting
NAD 83 CORS 96	OHIO NORTH 3401	652,948.929	1,807,639.496
<b>Method</b>	<b>Latitude</b>	<b>Longitude</b>	
GPS / CORPSCON	41° 27' 26.57058" N	83° 05' 12.69290" W	
<b>Geoid</b>	<b>Scale Factor</b>	<b>Convergence</b>	
GEOID 09	0.999962226	- 00° 23' 07.93426"	

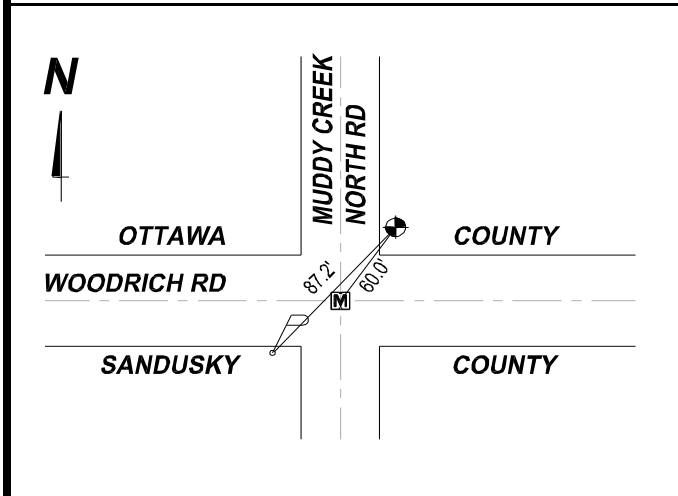

**NOTES:**

1. Monument set: July 6, 2011
2. Data Collected: 2-6-12, 2-14-12, 2-28-12