



# OTTAWA COUNTY BENCHMARK DATA SHEET



## OCE MAINT

<b>Township</b>	<b>Section</b>	<b>Town</b>	<b>Range</b>	<b>Type of Monument</b>
Salem	2	T6N	R15E	3 1/4" Domed Bronze Disk in Concrete (OCE Spec. BM-1)
<b>Set By</b>	<b>Shot By</b>	<b>Calculated</b>	<b>Calculated By</b>	<b>Published</b>
OCHD	J. Allen	September 20, 2011	M. J. Wittman, P.S.	March 16, 2012

### Location

In yard in front of Highway Garage, 14.5 feet south of flagpole in-line with flagpole and radio tower

### Vertical Control

<b>Vertical Datum</b>	<b>Method</b>	<b>Elevation (U.S. Survey Feet)</b>
NAVD 88	LEVEL	578.67

### Horizontal Control

<b>Horizontal Datum</b>	<b>Zone</b>	<b>Northing</b>	<b>Easting</b>
NAD 83 CORS 96	OHIO NORTH 3401	671,671.093	1,806,190.819
<b>Method</b>	<b>Latitude</b>	<b>Longitude</b>	
GPS / CORPSCON	41° 30' 31.44711" N	83° 05' 33.38956" W	
<b>Geoid</b>	<b>Scale Factor</b>	<b>Convergence</b>	
GEOID 09	0.999968720	- 00° 23' 21.53094"	

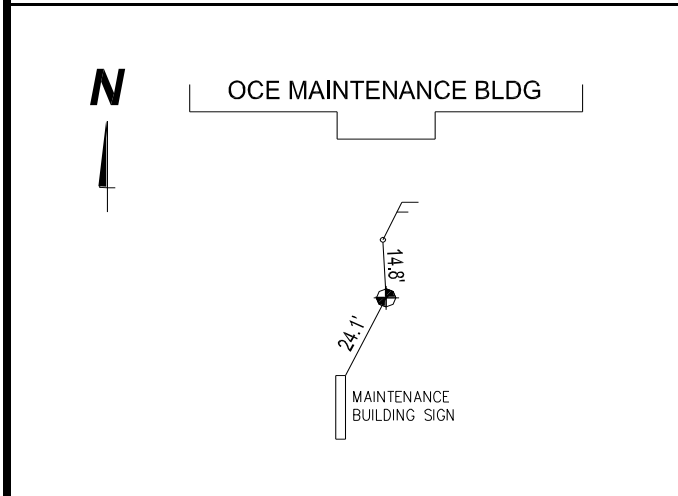

**NOTES:**

1. Monument set: Unknown
2. Data Collected: 2-7-12, 2-13-12, 2-27-12