

# OTTAWA COUNTY ENGINEERS OFFICE

**REFERENCE NO.** 8-6-17-D  
 WEST QUARTER POST SEC. 8  
 PORTAGE TWP.  
**SHEET** 1 OF 1.

**ROUTE:** C-123 FULTON STREET  
 @ C-133 LOCKWOOD RD.

**TOWNSHIP:** PORTAGE

**SECTION:** 8

**T** 6 **NR** 17 **E.**

**PERSONNEL:**  
 M. WITTMAN, P.S.  
 D. TORIS, P.S.  
 J. ALLEN

**NORTHING:**

**EASTING:**

**DATE / WEATHER / TEMP:**  
 AUGUST 16, 2023  
 SUNNY - HUMID  
 75° F

**DATUM:**

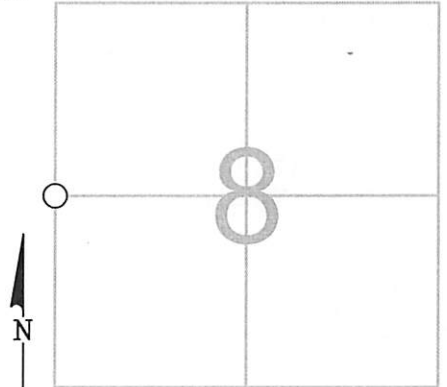

### MONUMENT INFORMATION

MONUMENT TYPE: FD.1" SQ. IRON PIN (BENT)  
 ON SURFACE - BELOW: 1.19'  
LEFT - CL PAV'T - RIGHT: 0.50' FULTON STREET  
LEFT - CL PAV'T - RIGHT: 1.0' LOCKWOOD RD.

TOP 9 1/2" OF IRON PIN WAS BENT E-SE, USED  
 POINT WHERE PIN WENT STRAIGHT INTO GROUND



### MISC. INFORMATION

FD RR SPIKE ON SURFACE, SHOT W/ GPS AND DUG FOR  
 IRON PIN OF RECORD. FD PK NAIL 0.25' BELOW SURFACE,  
 AND ALSO SHOT W/ GPS. FD 1" SQ IRON PIN WITH TOP 9  
 1/2" BENT E-SE. RESET A STRAIGHT 1" SQ IRON PIN IN  
 HOLE WHERE PIN WAS STRAIGHT INTO GROUND. PK NAIL  
 WA 0.36' EAST AND 0.42' SOUTH OF WHERE PIN WAS  
 STRAIGHT. RR SPIKE WAS 0.61' EAST AND 0.42' SOUTH OF  
 WHERE PIN WAS STRAIGHT.

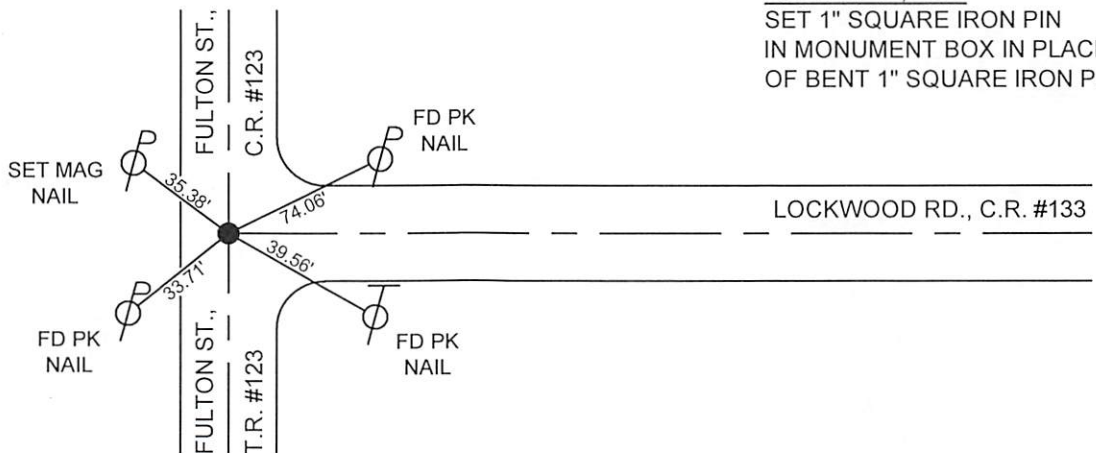

AUGUST 16, 2023  
 SET 1" SQUARE IRON PIN  
 IN MONUMENT BOX IN PLACE  
 OF BENT 1" SQUARE IRON PIN