

OTTAWA COUNTY ENGINEERS OFFICE

REFERENCE NO. 7-6-17-F
 EAST QUARTER POST SEC. 7
 PORTAGE TWP.
SHEET 1 OF 1.

ROUTE: C-123 FULTON STREET
 @ C-133 LOCKWOOD RD.

TOWNSHIP: PORTAGE

SECTION: 7

T 6 **NR** 17 **E.**

PERSONNEL:
 M. WITTMAN, P.S.
 D. TORIS, P.S.
 J. ALLEN

NORTHING:

EASTING:

DATE / WEATHER / TEMP:
 AUGUST 16, 2023
 SUNNY - HUMID
 75° F

DATUM:

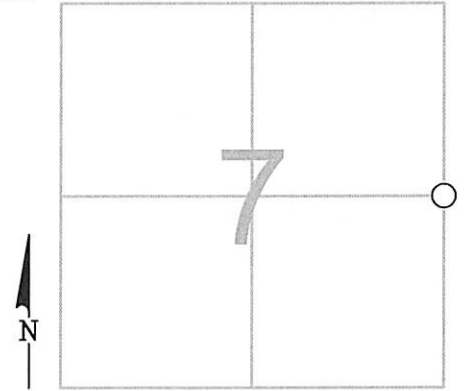

MONUMENT INFORMATION

MONUMENT TYPE: FD.1" SQ. IRON PIN (BENT)
 ON SURFACE - BELOW: 1.19'
LEFT - CL PAV'T - RIGHT: 0.50' FULTON STREET
LEFT - CL PAV'T - RIGHT: 1.0' LOCKWOOD RD.

TOP 9 1/2" OF IRON PIN WAS BENT E-SE, USED
 POINT WHERE PIN WENT STRAIGHT INTO GROUND



MISC. INFORMATION

FD RR SPIKE ON SURFACE, SHOT W/ GPS AND DUG FOR
 IRON PIN OF RECORD. FD PK NAIL 0.25' BELOW SURFACE,
 AND ALSO SHOT W/ GPS. FD 1" SQ IRON PIN WITH TOP 9
 1/2" BENT E-SE. RESET A STRAIGHT 1" SQ IRON PIN IN
 HOLE WHERE PIN WAS STRAIGHT INTO GROUND. PK NAIL
 WA 0.36' EAST AND 0.42' SOUTH OF WHERE PIN WAS
 STRAIGHT. RR SPIKE WAS 0.61' EAST AND 0.42' SOUTH OF
 WHERE PIN WAS STRAIGHT.

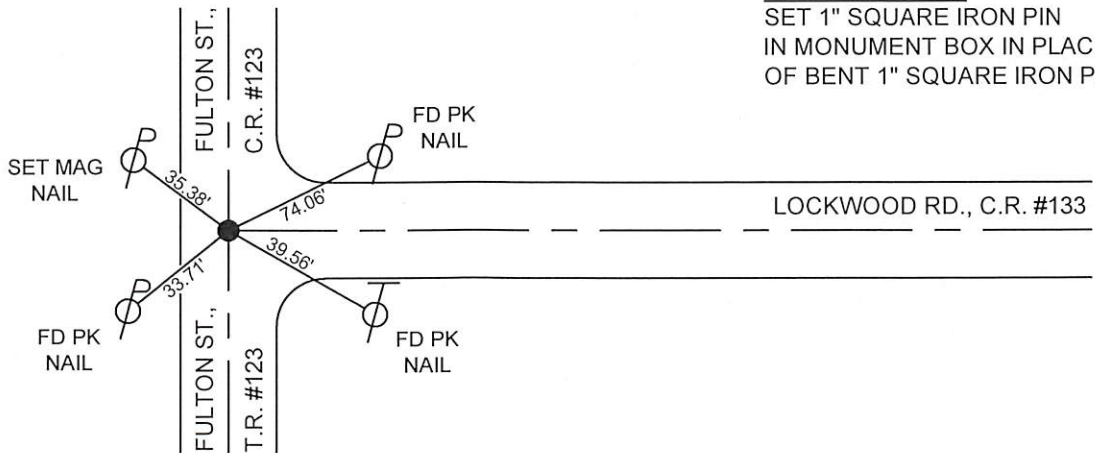

AUGUST 16, 2023
 SET 1" SQUARE IRON PIN
 IN MONUMENT BOX IN PLACE
 OF BENT 1" SQUARE IRON PIN