

OTTAWA COUNTY BENCHMARK DATA SHEET

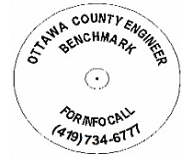

POR 133-0.0

Township	Section	Town	Range	Type of Monument
Portage	7	T6N	R17E	3 1/4" Domed Bronze Disk in Concrete (OCE Spec. BM-1)
Set By	Shot By	Calculated	Calculated By	Published
OCE / OCHD	J. Allen	March 14, 2012	M. J. Wittman, P.S.	March 16, 2012

Location

West of the intersection of Fulton St., C.R. #123 & Lockwood Rd., C.R. #133

Vertical Control		
Vertical Datum	Method	Elevation (U.S. Survey Feet)
NAVD 88	GPS	575.70

Horizontal Control			
Horizontal Datum	Zone	Northing	Easting
NAD 83 CORS 96	OHIO NORTH 3401	666,088.752	1,849,639.075
Method	Latitude	Longitude	
GPS / CORPSCON	41° 29' 38.82022" N	82° 56' 01.95243" W	
Geoid	Scale Factor	Convergence	
GEOID 09	0.999966789	- 00° 17' 06.12514"	

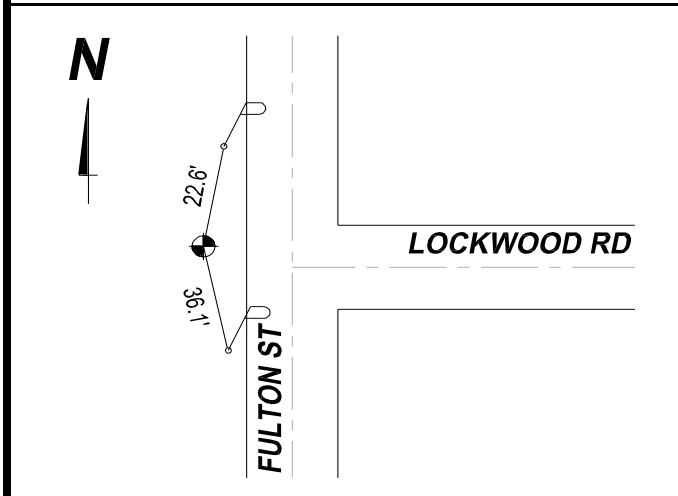

NOTES:

1. Monument set: August 23, 2011
2. Data Collected: 2-14-12, 3-2-12, 3-8-12