

ROOSE DITCH — SENATE BILL 160 PROJECT

Item	Page
Location Map	1
Profile Sta 0+00 - 45+00	2
Profile Sta 45+00 - 60+00	3
Bench Mark Descriptions	3
Soils Descriptions	3
Cross Sections Sta 0+50 - 31+00	4
Cross Sections Sta 35+00 - 59+00	5
Typical Clearing and Grubbing Detail	6
Culvert Rip Rap Detail	6
Tile Outlet Pipe Detail	6

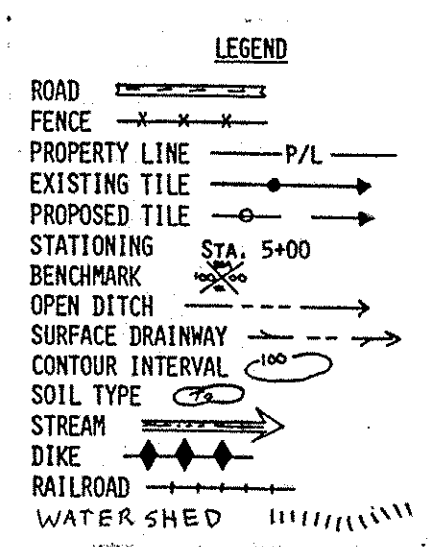
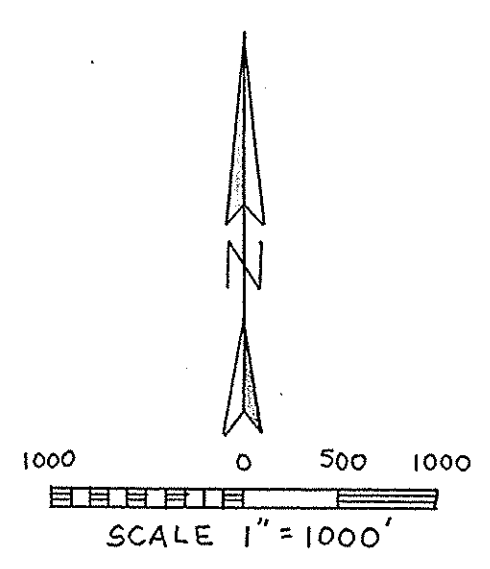
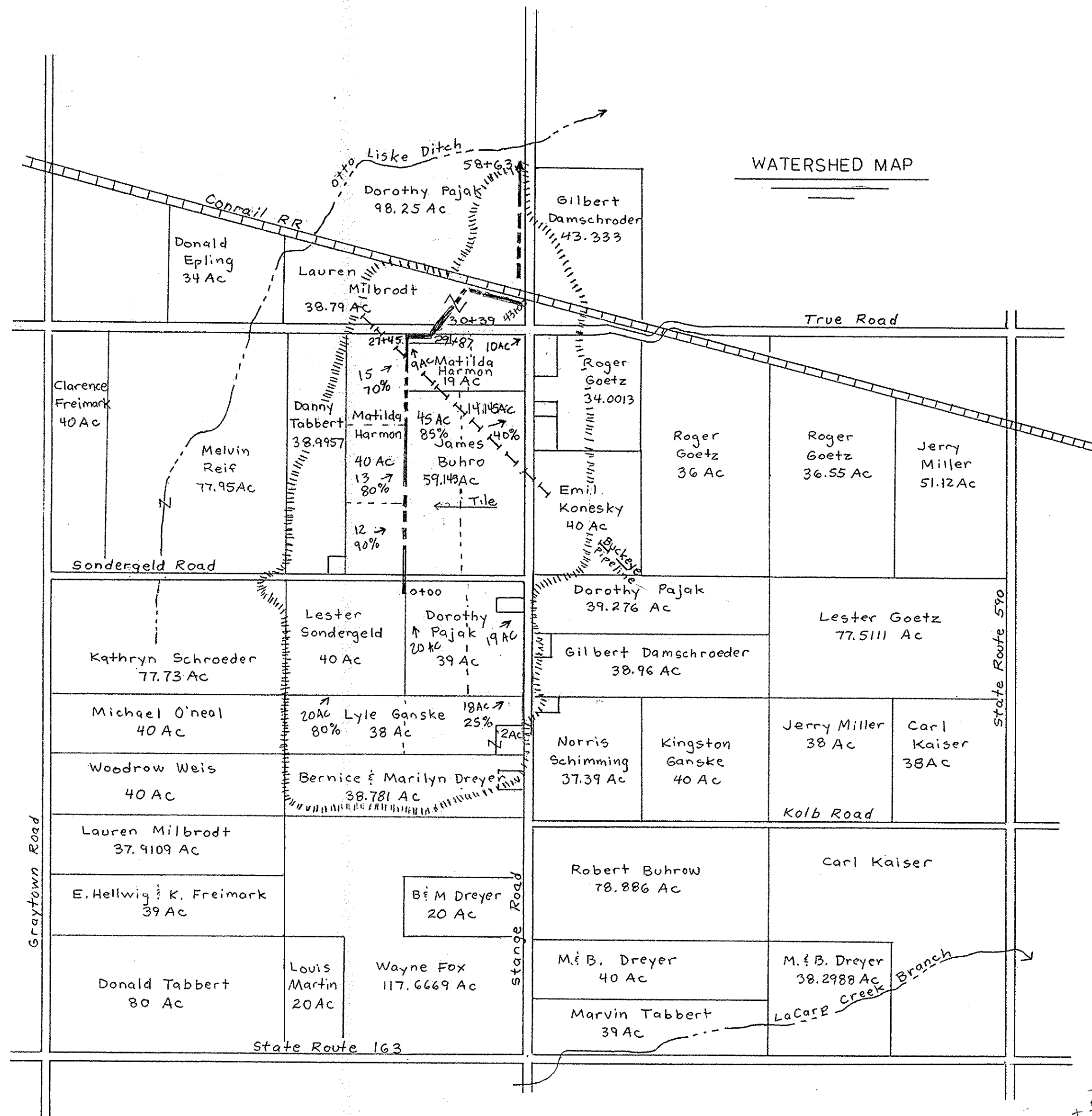

180  
435  
150  
270  
290  
210  
1575

330  
220  
560  
430  
990  
305  
(1273)

32.68  
16  
196.08  
32.68  
+ 5228.8  
48  
+ 570

ID# 116010010 MRG 960116

UTILITY				
Name	Address	Phone No.	Member OUPS	Limited Basis Participants
Buckeye Pipe	Will Mark	698-8189	✓	

Non Response GTE, World Comm

APPROVED BY: *John G. Pappas* 2/29/96  
OTTAWA COUNTY ENGINEER

CONSTRUCTION APPROVED BY: \_\_\_\_\_  
JOB CLASS 1

**NOTE TO EXCAVATOR**

Excavator must notify all utilities at least 48 hours and not more than 10 days prior to the planned commencement of excavation.

- Member utilities will be contacted by calling OUPS (1-800-362-2764).
- Each Limited Basis Participant and members of the Ohio Oil and Gas Association will be contacted by the excavator using the telephone number provided.

ROOSE DITCH  
OUTLET DITCH IMPROVEMENT  
BENTON TOWNSHIP  
OTTAWA COUNTY OHIO

**U. S. DEPARTMENT OF AGRICULTURE  
SOIL CONSERVATION SERVICE**

Designed: Michael Gargac	Date	Approved by: <i>John G. Pappas</i>
Drawn: Michael Gargac	9-95	Title: <i>Dist. Engineering</i>
Traced:		Title:
Checked: <i>J. G. Pappas</i>	1/96	Sheet No. 1 Drawing No. 39-01-383-96-05

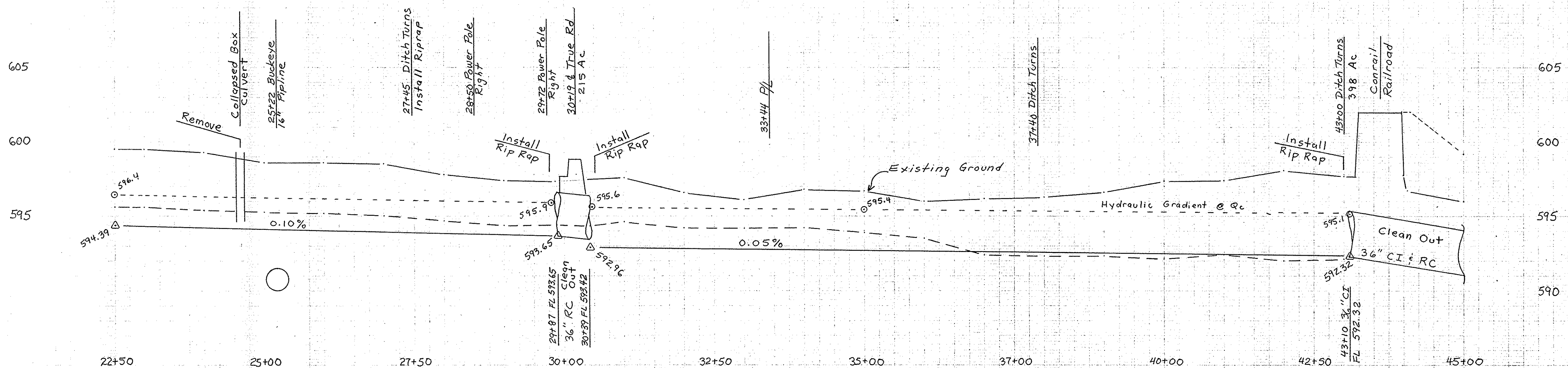
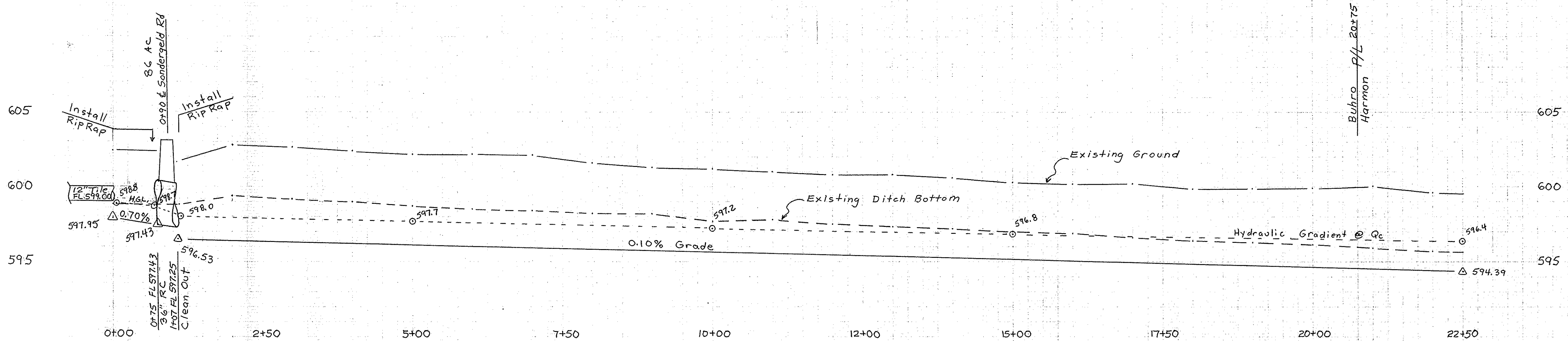

ROOSE DITCH

U. S. DEPARTMENT OF AGRICULTURE  
SOIL CONSERVATION SERVICE

Designed <i>M. Gargac</i>	Date <i>6-95</i>	Approved by <i>Boyle &amp; Sumner</i>
Drawn <i>M. Gargac</i>	9-95	THH <i>Civil Engineering Tech</i>
Traced		Title
Checked <i>Boyle &amp; Sumner</i>	1/96	Sheet No. <i>2</i> of <i>6</i>
		Drawing No. <i>39-01-383-96-05</i>

Revised: 960327

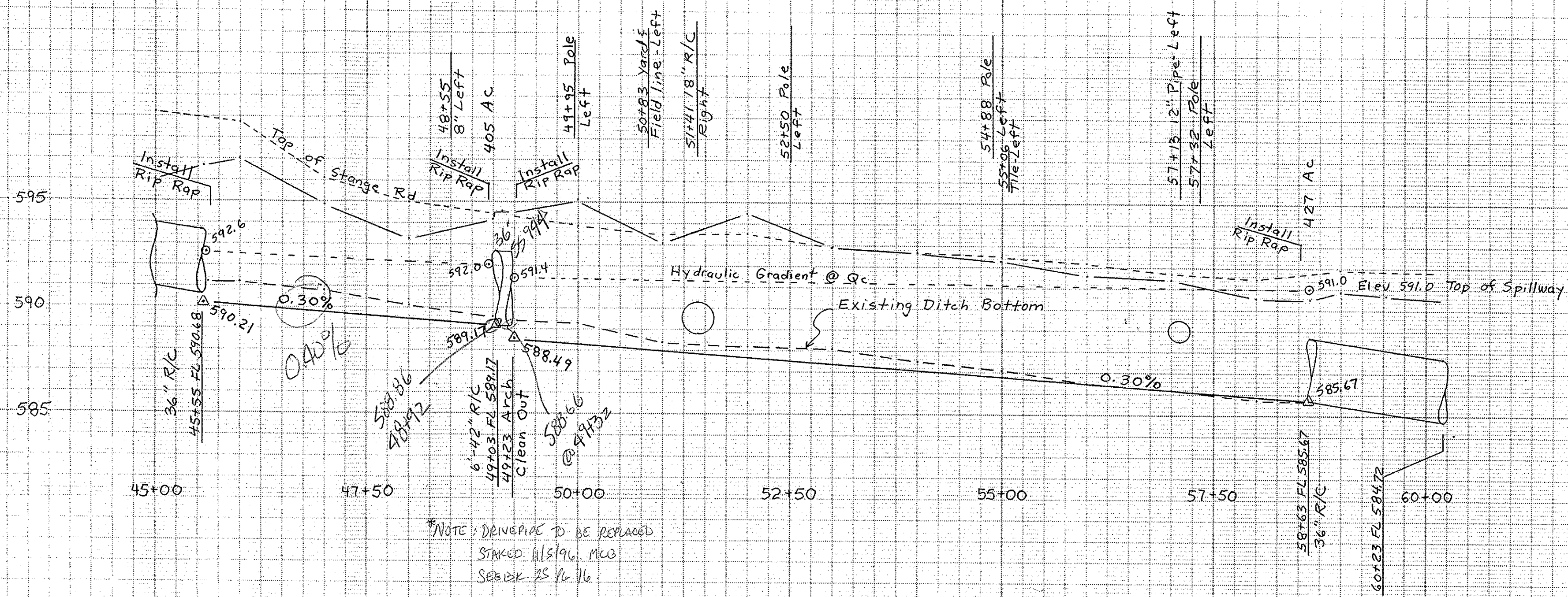

**BENCHMARK DESCRIPTIONS**

- B.M. #1 Chiseled "X" on top of north end of 36" R/C culvert on north side of Sondergeld Road at Station 1 + 07.  
M.S.L. Elevation 600.65
- B.M. #2 Top of north side of concrete base of iron fence post on Buhr-Harmon property line on east side of Roose Ditch at Station 20 + 75.  
M.S.L. Elevation 599.33
- B.M. #3 Chiseled "X" on top of west end of 36" R/C culvert on south side of True Road at Station 29 + 87.  
M.S.L. Elevation 597.03
- B.M. #4 Chiseled "X" on top of north end of 36" R/C culvert on north side of the True Road at Station 30 + 39.  
M.S.L. Elevation 596.77
- B.M. #5 Top of south end and behind bell of 36" cast iron pipe on south side of ConRail Railroad west side of Stange Road at Station 43 + 10.  
M.S.L. Elevation 595.51
- B.M. #6 Top of north end of 36" R/C under ConRail Railroad on west side of Stange Road at Station 45 + 55.  
M.S.L. Elevation 597.51
- ~~B.M. #7~~ Railroad spike located in east side of utility pole located on west side of Stange Road at Station 52 + 50.  
M.S.L. Elevation 594.14
- B.M. #8 Spike in south side of power pole with transformer on west side of Stange Road at Station 57 + 32.  
M.S.L. Elevation 593.17
- B.M. #9 Chiseled "X" on west end of elliptical sewer on west side of Stange Road on the Otto Liske Ditch at Station 60 + 30.  
M.S.L. Elevation 588.29

**SOILS DESCRIPTIONS**

- Hy - Hoytville Silty Clay Loam** This deep, nearly level, very poorly drained soil is on broad flats and in long, narrow, concave areas on lake plains. Most areas range from 5 to more than 100 acres. Slope is 0 to 2 percent.
- NpA - Nappanee Silty Clay Loam** This deep, nearly level, somewhat poorly drained soil is on slight convex rises and side slopes along drainageways on lake plains. Most areas range from 4 to 75 acres.

**ROOSE DITCH**

**U. S. DEPARTMENT OF AGRICULTURE  
SOIL CONSERVATION SERVICE**

Designed <u>M. Gargac</u>	Date <u>6-95</u>	Approved <u>D. J. Sommer</u>	Title <u>Civil Engineer, Tech</u>
Drawn <u>M. Gargac</u>	Date <u>9-95</u>		
Traced _____		Title _____	
Checked <u>D. J. Sommer</u>		Drawing No. <u>39-01-383-96-05</u>	
		Sheet <u>3</u> of <u>6</u>	

Revised: 960416

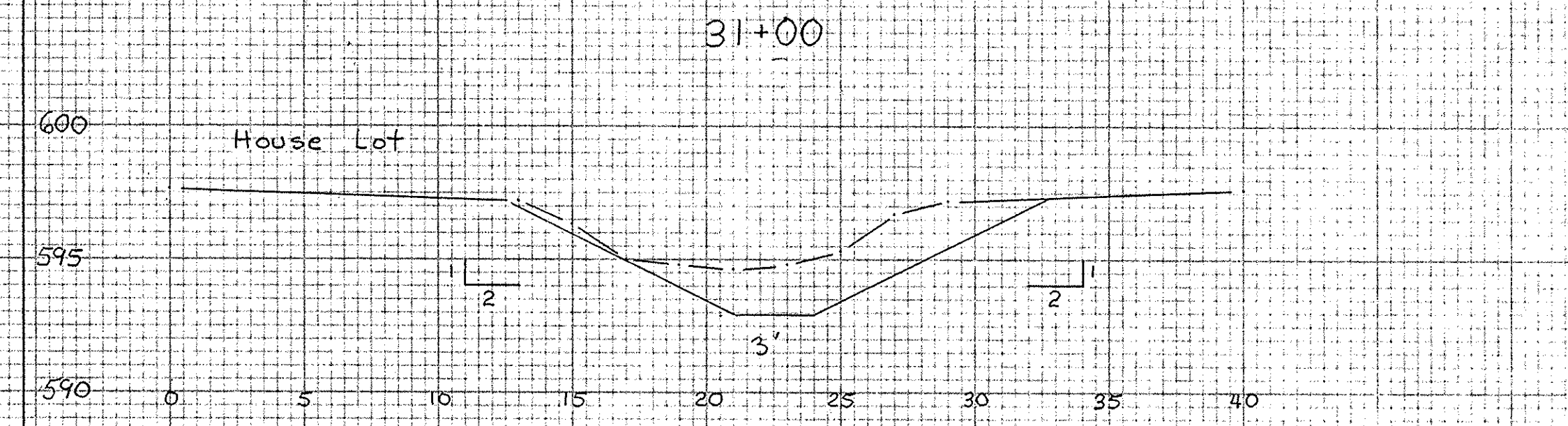
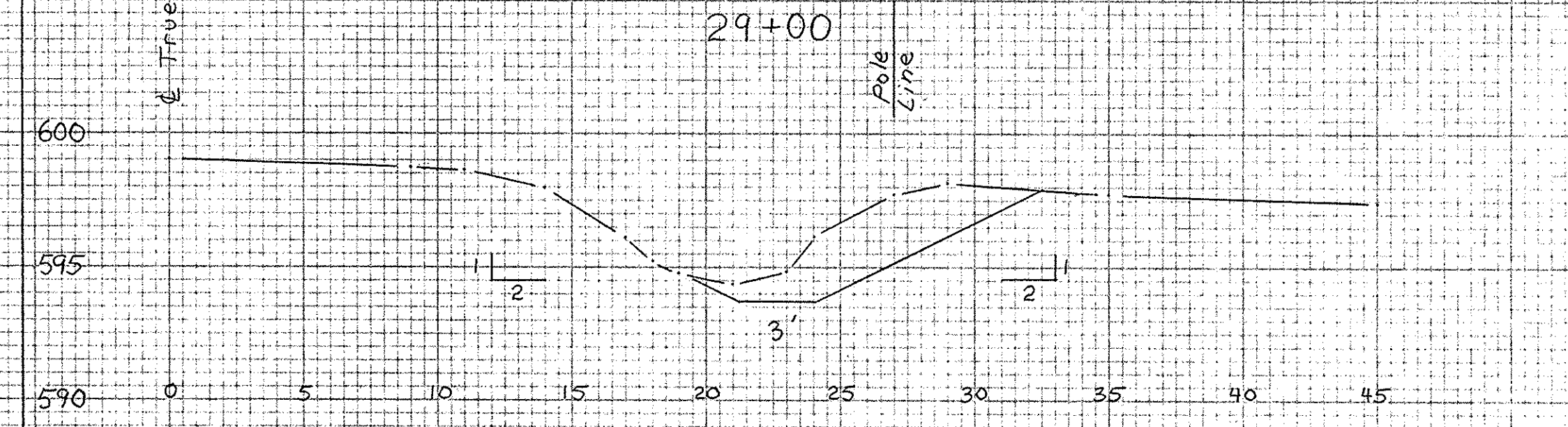
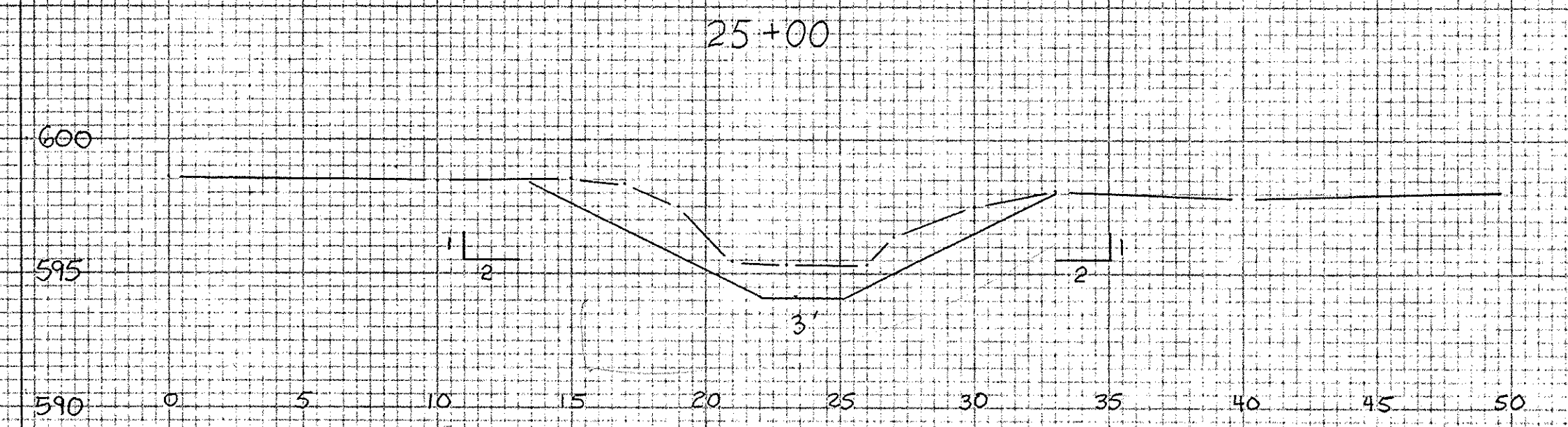
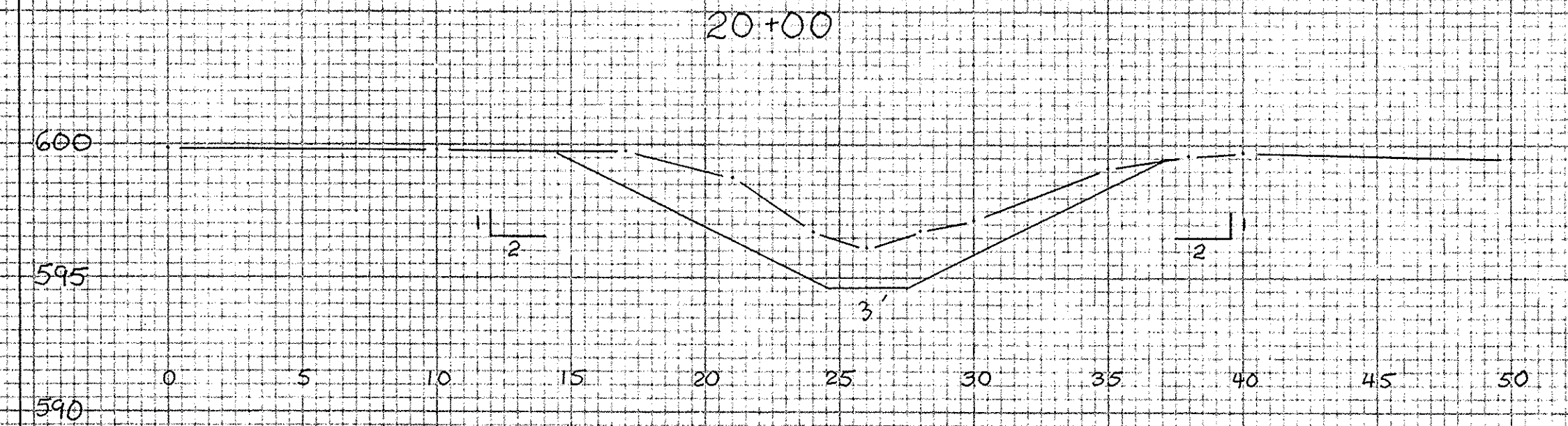
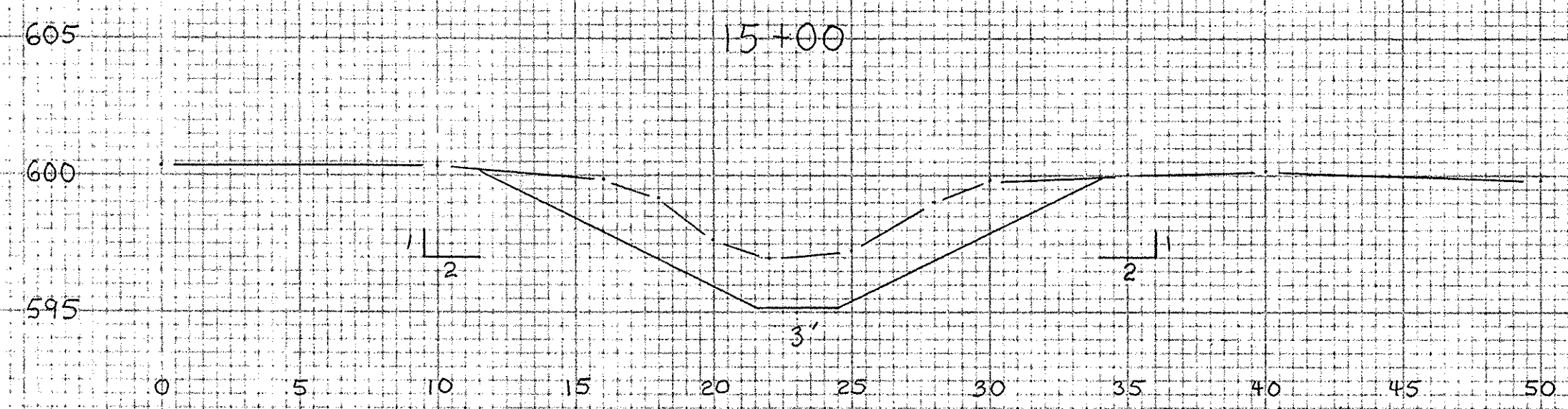
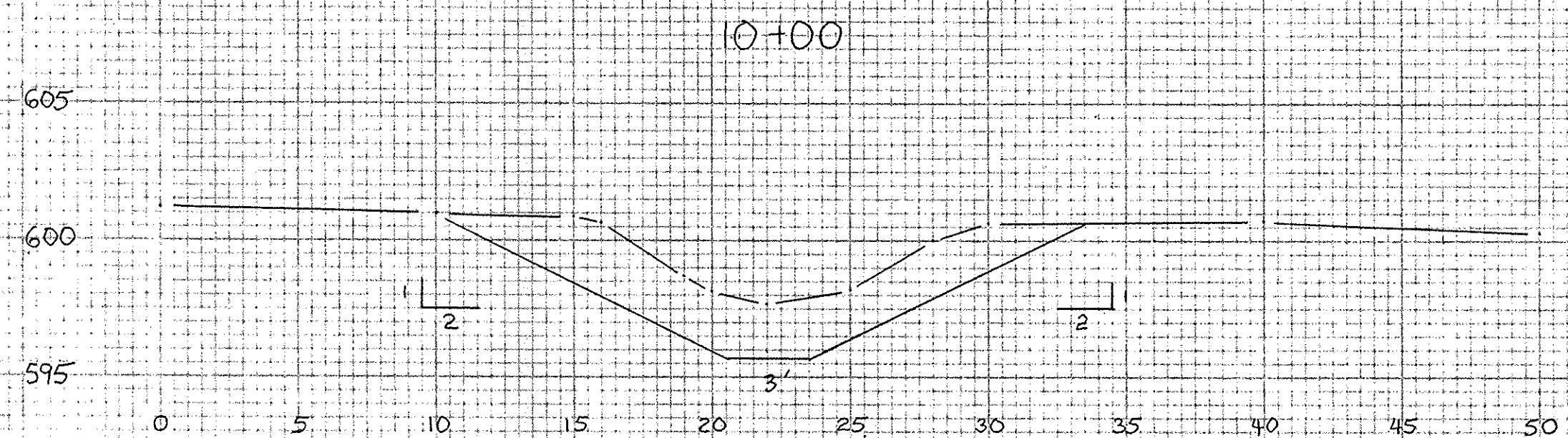
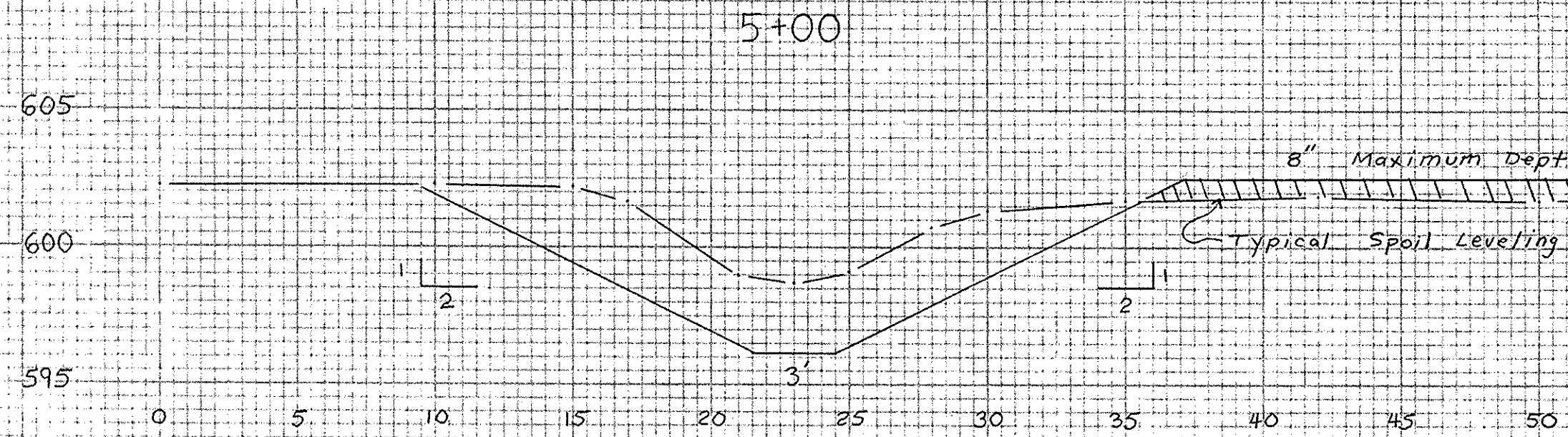
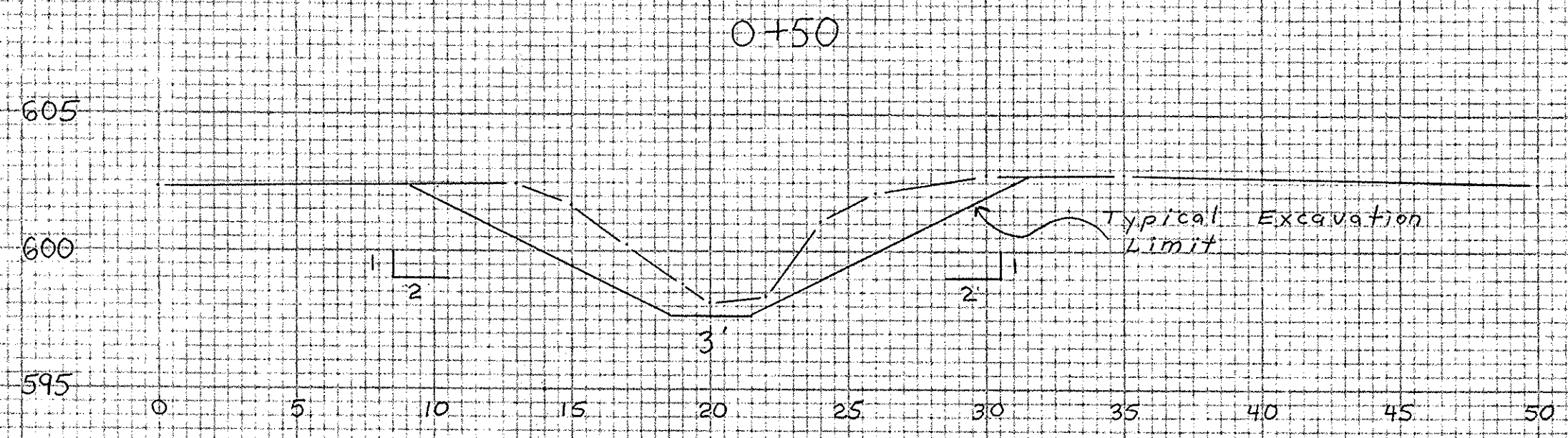

ROOSE DITCH

U. S. DEPARTMENT OF AGRICULTURE  
SOIL CONSERVATION SERVICE

Designed M. Gargac	Date 6-95	Approved by
Drawn M. Gargac	9-95	Title
Traced		Title
Checked		Sheet No. 4 of 6
		Drawing No. 39-01-383-96-05

Revised: 960416

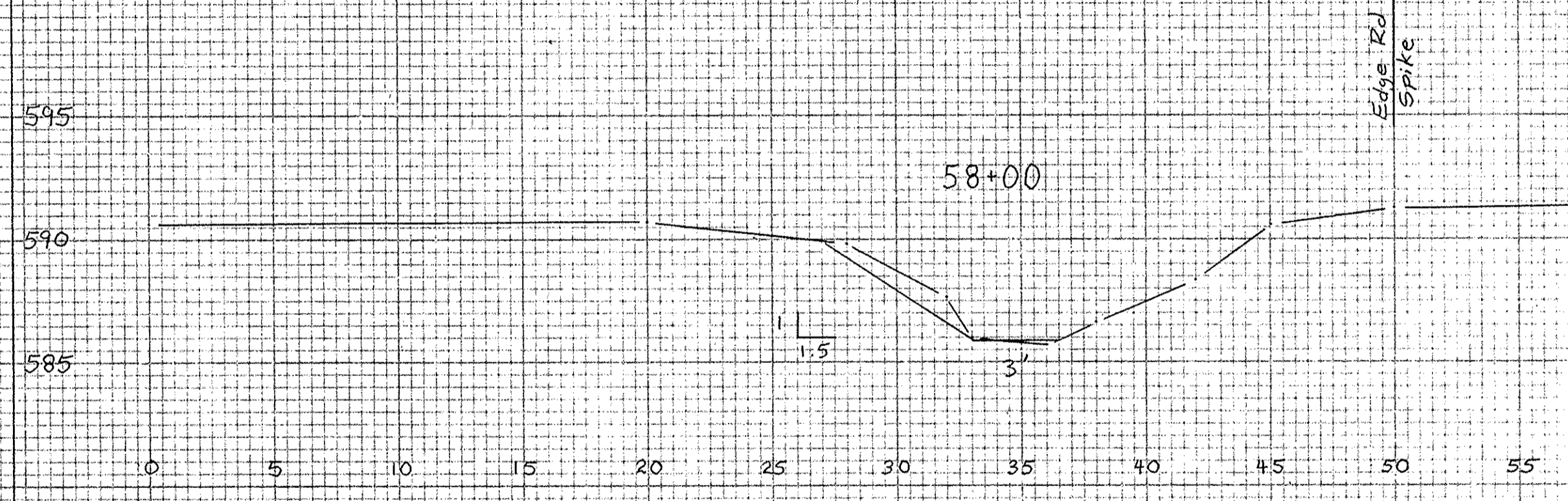
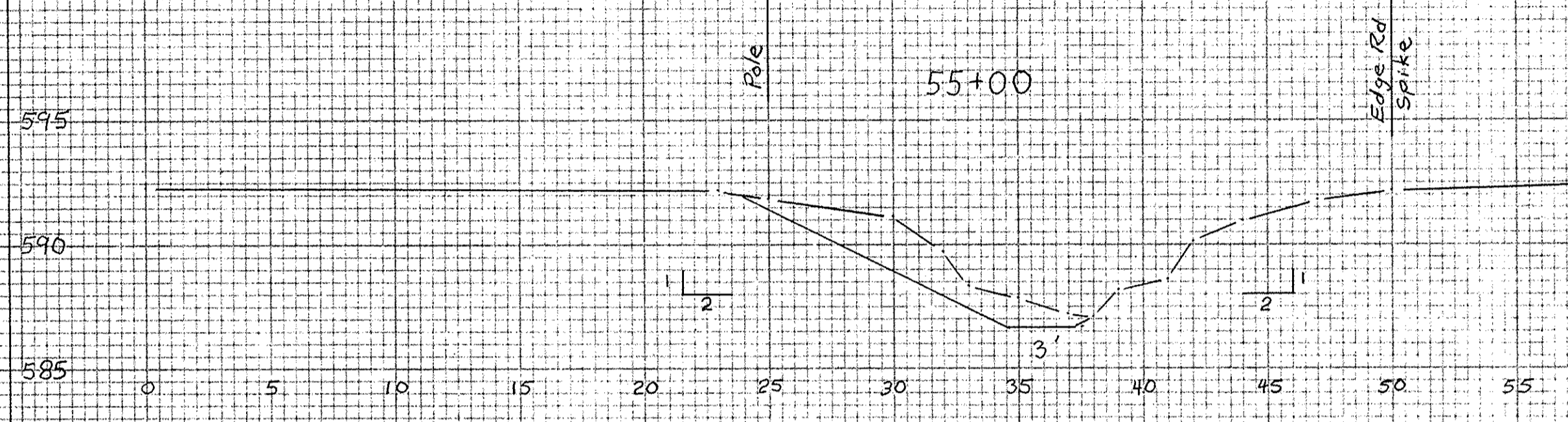
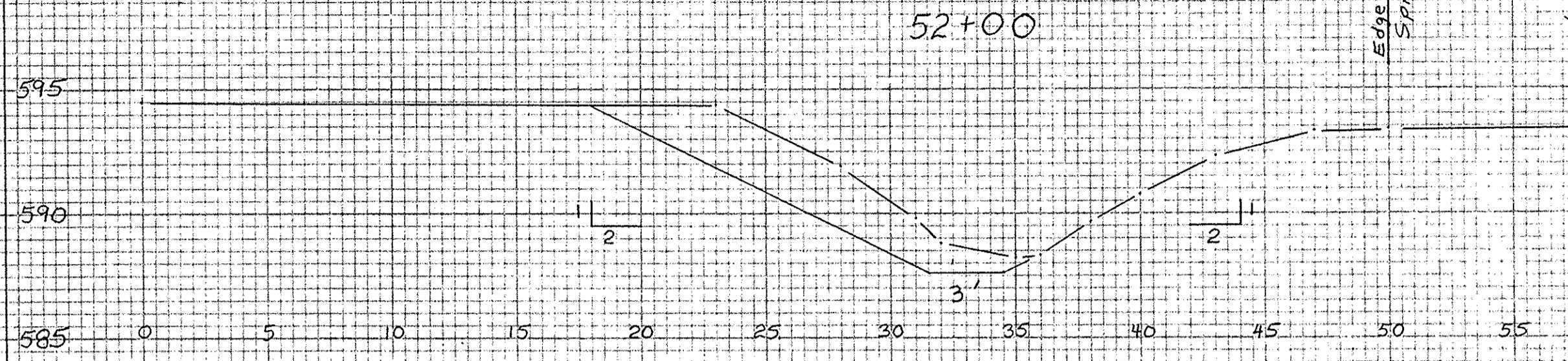
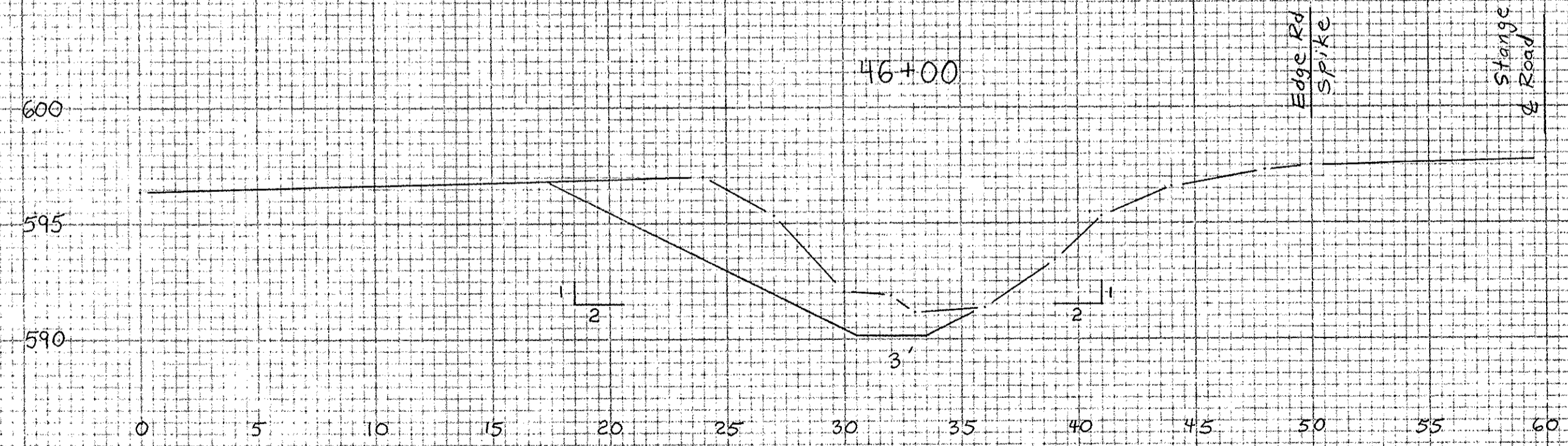
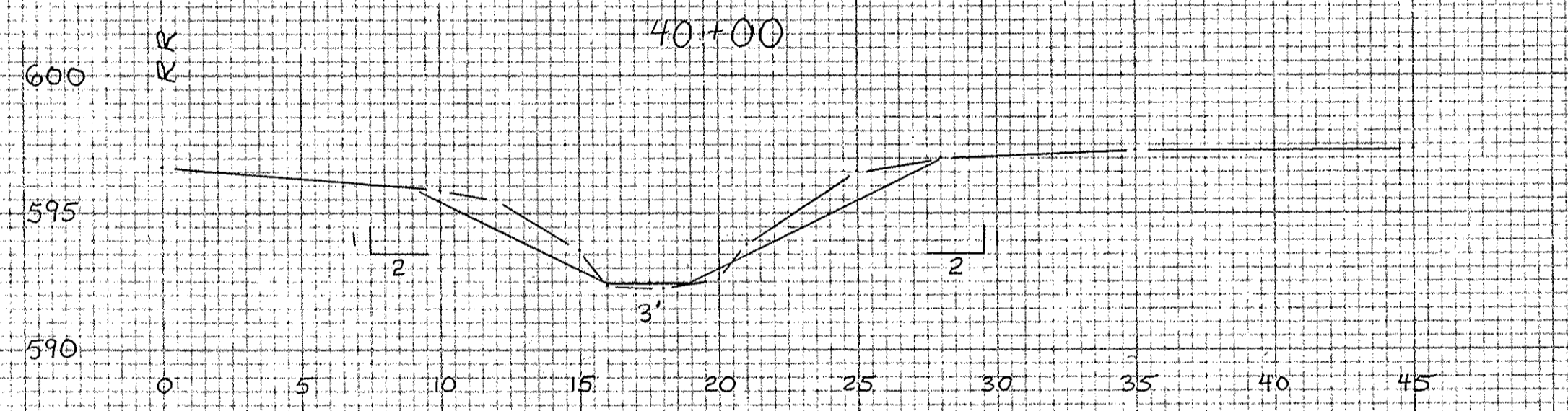
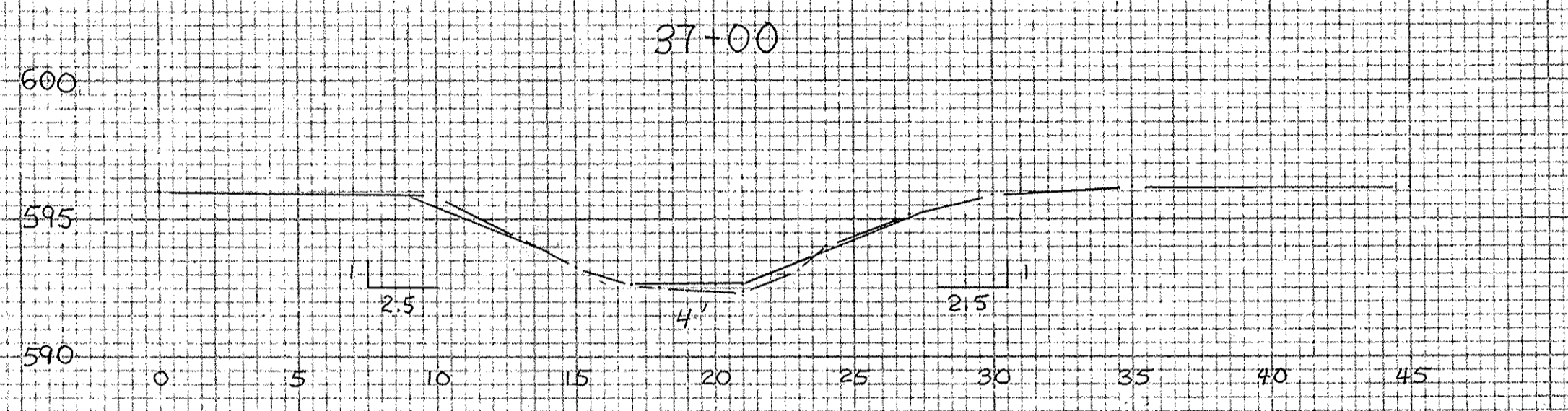
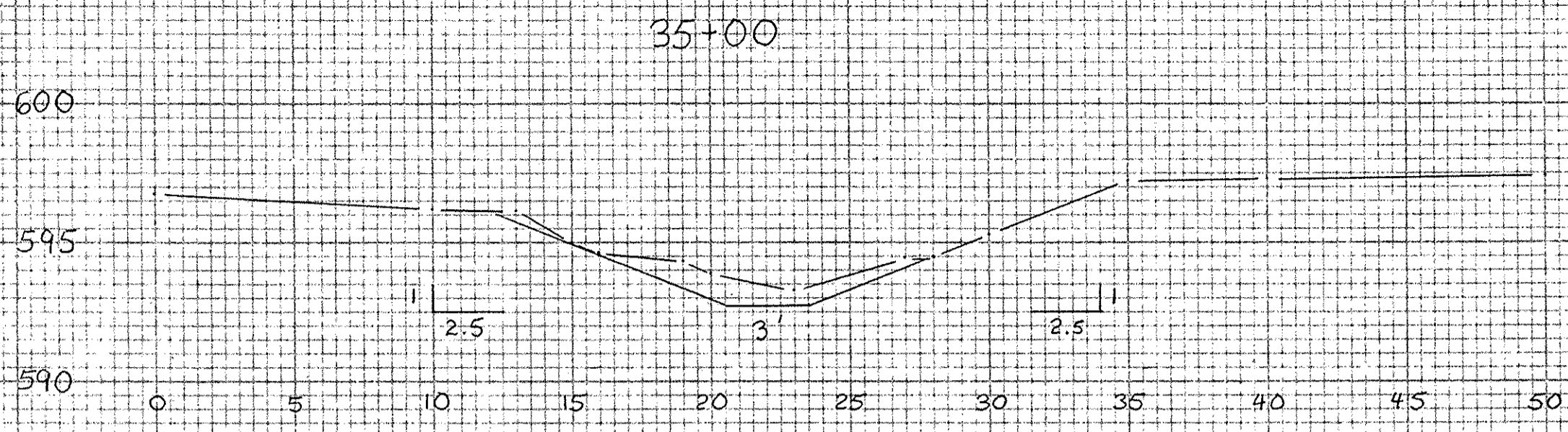

**ROOSE DITCH**

U. S. DEPARTMENT OF AGRICULTURE  
SOIL CONSERVATION SERVICE

Designed <i>M. Gargas</i>	Date <i>6-95</i>	Approved <i>Paul F. Sommer</i>	Title <i>Civil Engineering Tech</i>
Drawn <i>M. Gargas</i>	Date <i>9-95</i>		
Traced	Sheet No. <i>5</i>	Drawing No. <i>39-01-383-96-05</i>	
Checked <i>P. F. Sommer</i>	Date <i>1/96</i>	of <i>6</i>	

Revised?

Culvert Rip Rap Detail  
Inlet and Outlet

End View

Side View

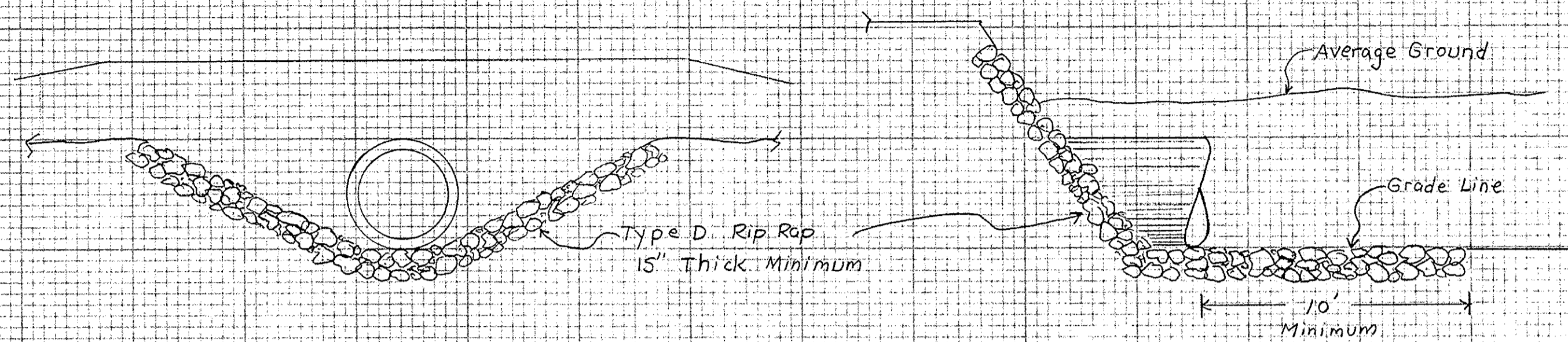

TWO SIDED CONSTRUCTION

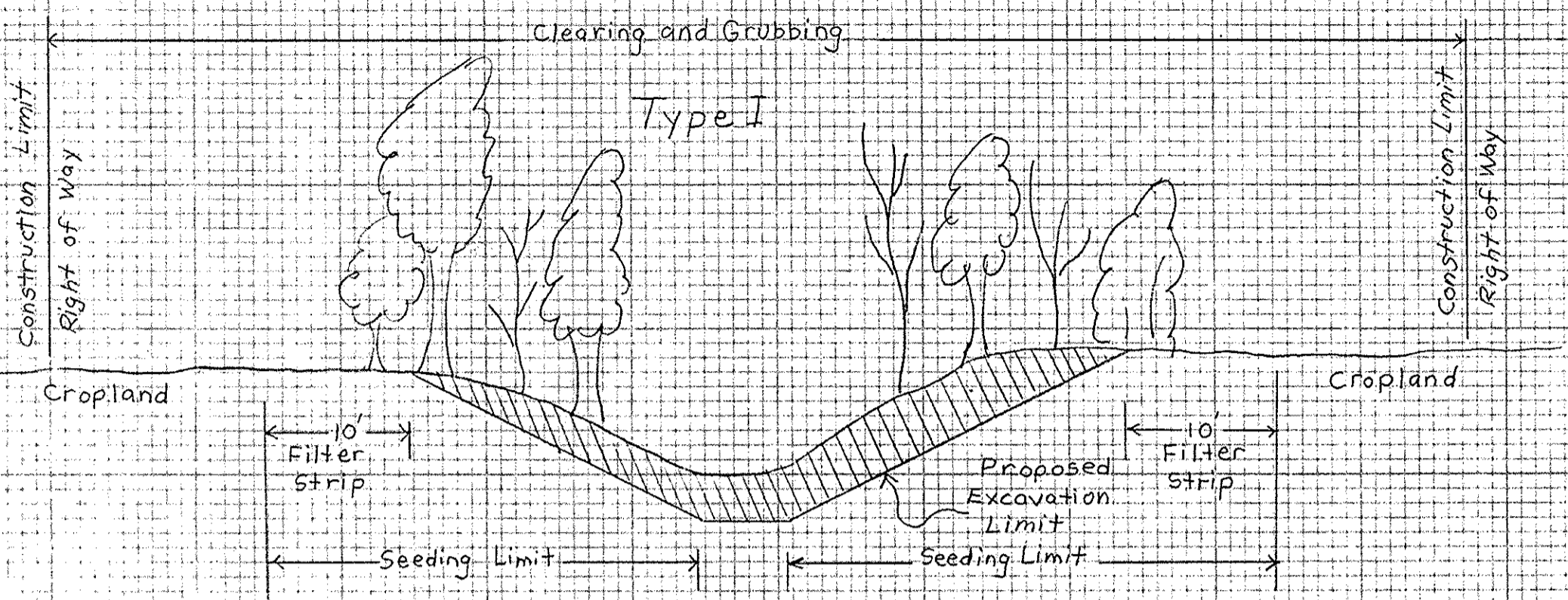

ONE SIDED CONSTRUCTION

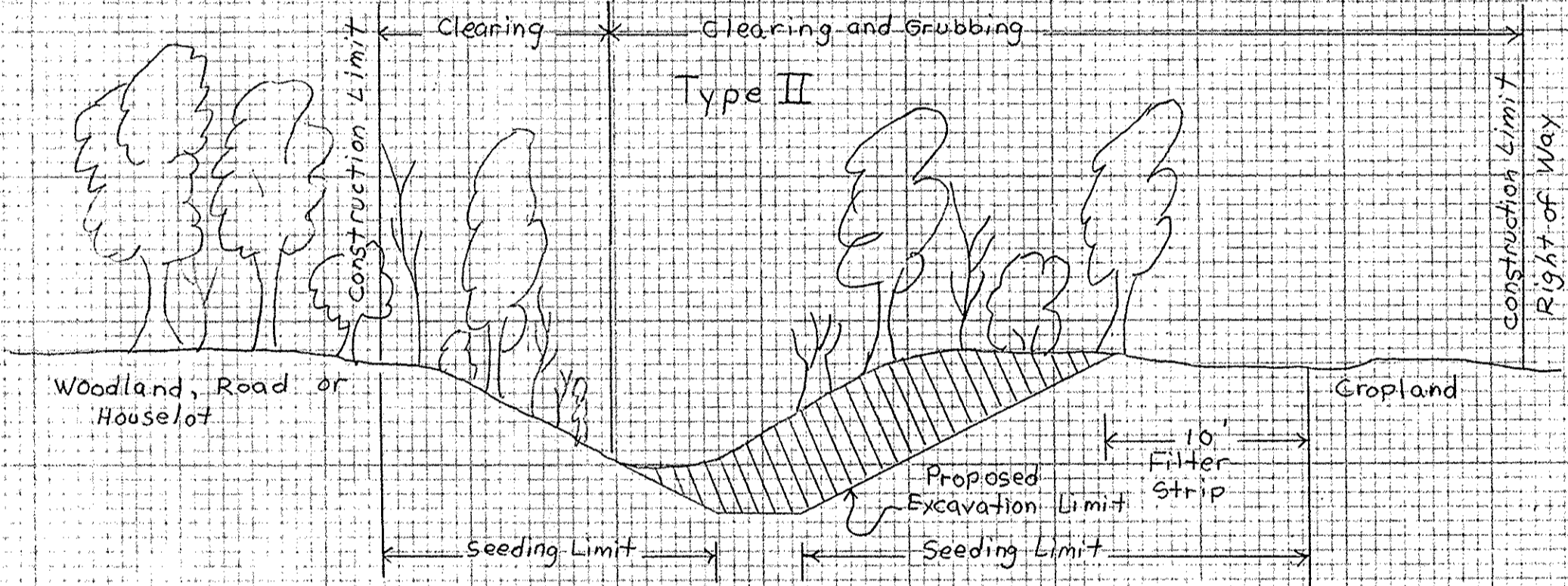

Tile Outlet Pipe Detail

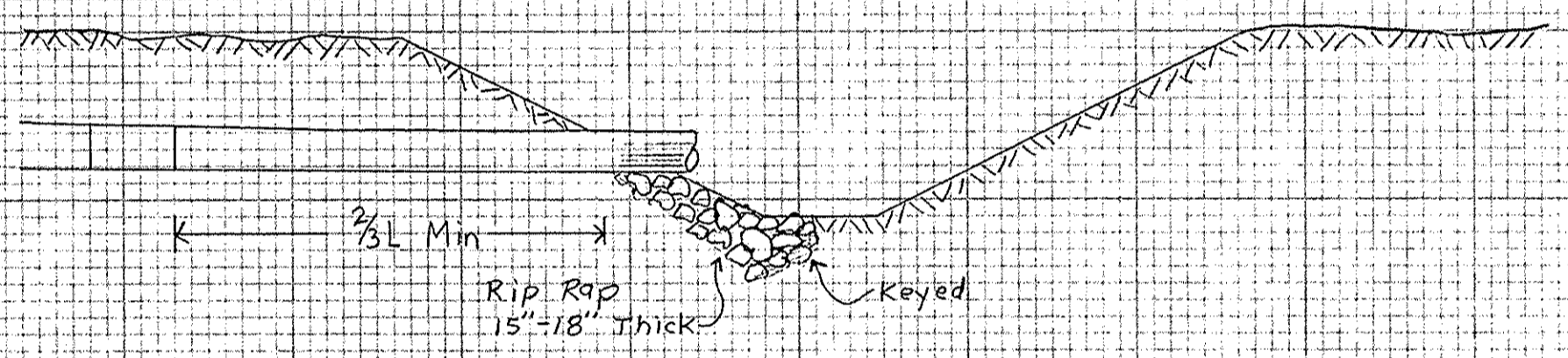

Erosion Control Structure

Profile View

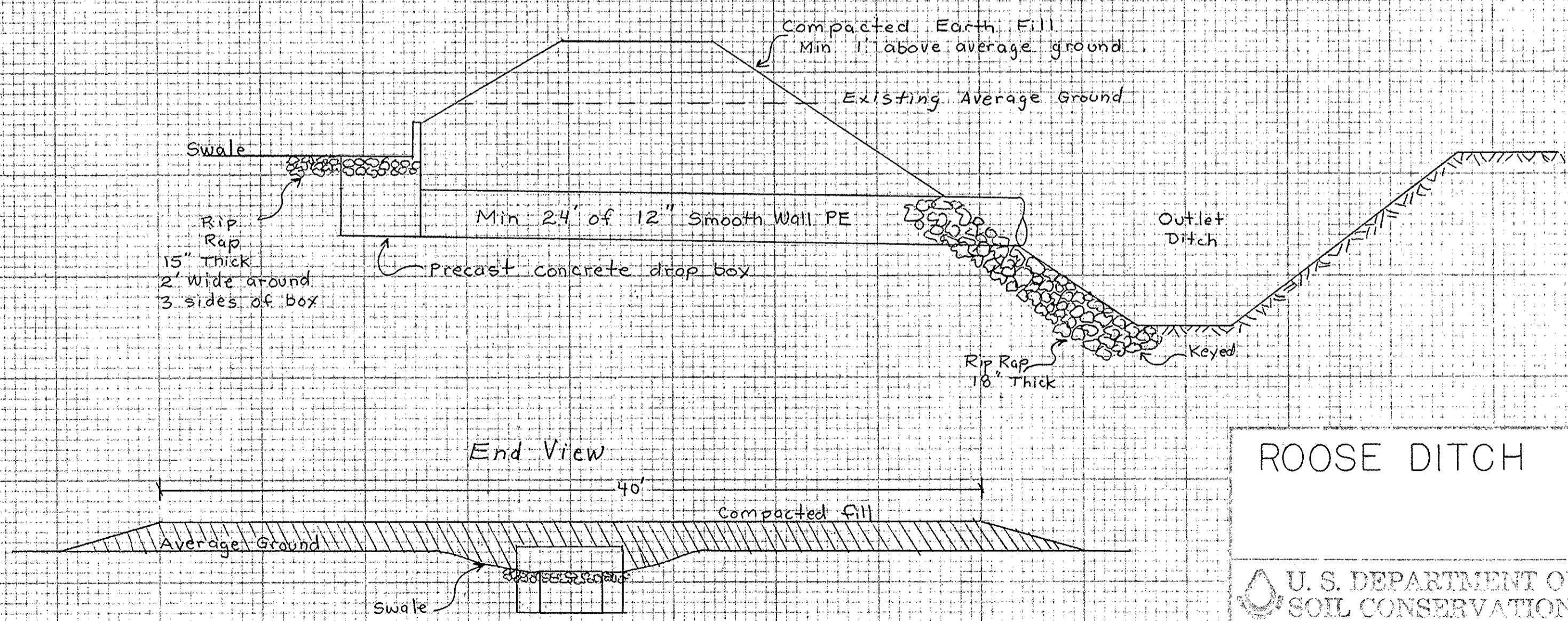

End View

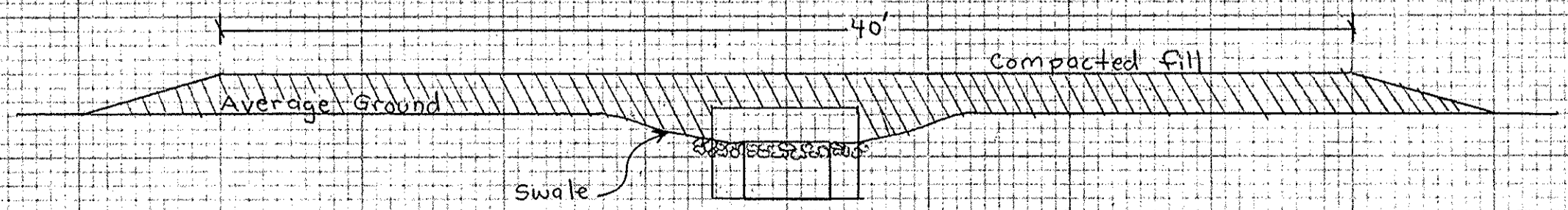

Type I  
Station 0+00 - 27+45  
33+44 - 43+10

Type II  
Station 27+45 - 33+44  
45+55 - 58+63

ROOSE DITCH

U. S. DEPARTMENT OF AGRICULTURE  
SOIL CONSERVATION SERVICE

Designed Michael Gargac 6/95  
Drawn Michael Gargac 6/95  
Checked D. J. Sommer 1/96

Date 6/95  
Approved Doyle F. Sommer  
Title Civil Engineering Tech  
Sheet No. 6 of 6  
Drawing No. 39-01-383-96-05

Revised: 960422