

NISSEN RD. DITCH SEC. 25 CLAY TWP. 1964

BM Sta. 7+50 Lt.
Top SE Cor. Conc. Porch.
Elev. 603.70

BM Sta. 19-Rt.
"X" E. Side E. Conc. Rail, NE
corner Bridge, Elev. 600.96

Carl Zwicker Jr.
lawn area (Note: remove shrubs in construction area
and replace to original condition)

QUANTITIES
200'-10" extra quality chain tile
40'-10" RCP M.6.6 (b)
Remove and dispose of 163' 6" 8" VSP
" " Replace evergreens in lawn area where necessary
Use excess excavated material to back fill new pipe

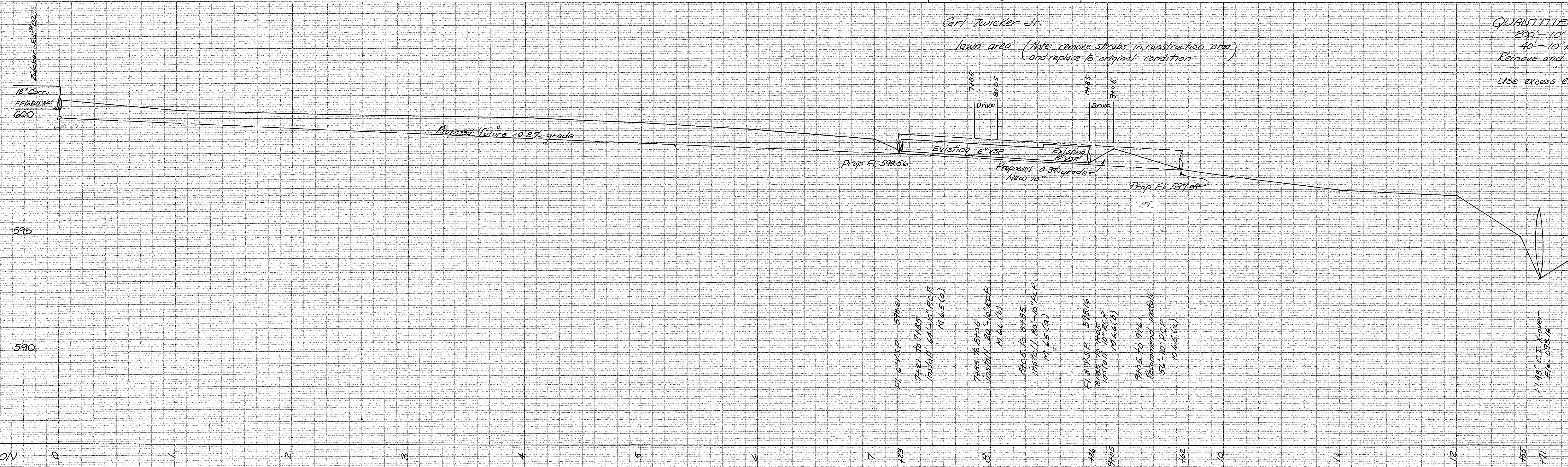

Fl. 6" VSP 598.61
 74.21 to 77.85
 Install 64'-10" RCP
 M.6.5 (a)

 74.05 to 84.05
 Install 80'-10" RCP
 M.6.6 (a)

 84.05 to 87.85
 Install 80'-10" RCP
 M.6.5 (a)

 Fl. 8" VSP 598.16
 87.85 to 91.05
 Install 10'-10" RCP
 M.6.6 (a)

 91.05 to 91.61
 Recommend install
 52'-10" RCP
 M.6.5 (a)

Fl. 48" C.I. Cover
Elev. 595.16

No Catch Basin required
Stations based on pipe lengths of 4'