

NOTICE TO LANDOWNERS AND CONTRACTORS:
UNLESS OTHERWISE SPECIFIED, ALL WORK SHALL BE DONE IN ACCORDANCE WITH THE STANDARD SPECIFICATIONS FOR ROAD AND BRIDGE CONSTRUCTION, 1975 EDITION, AS AMENDED BY THE BOARD OF SUPERVISORS OF THE COUNTY OF OTTAWA, ILLINOIS, AND THE STANDARD SPECIFICATIONS FOR DRAINAGE AND EROSION CONTROL, 1975 EDITION, AS AMENDED BY THE BOARD OF SUPERVISORS OF THE COUNTY OF OTTAWA, ILLINOIS. THE CONTRACTOR SHALL BE RESPONSIBLE FOR OBTAINING ALL NECESSARY PERMITS AND APPROVALS FROM THE APPROPRIATE AGENCIES.

- I. **EXCAVATION:**
 - A. Bottom Width: The bottom width shall be THREE (3) feet between sta. 10+90 and sta. 57+43.
 - B. Bank Slopes: The ditch bank slopes are to be constructed to at least 2 feet horizontal to 1 foot vertical between sta. 10+90 and sta. 57+43.
 - C. Alignment: The centerline of the improvement shall be approximately the centerline of the existing ditch unless otherwise indicated on the plan.
 - D. Total Excavation: The total excavation consists of 2568 cubic yards of earth over 5095 lineal feet of ditch from sta. 10+90 to sta. 62+34.
 - E. Excess Yardage: No extra compensation will be paid for such excavation in excess of yardage herein estimated. This estimate was made from cross sections of the proposed ditch. The contractor should view the proposed work to his own satisfaction.
 - F. The contractor shall be given a right-of-way on each side of the ditch 50 feet from the bank of the ditch at all points.
- II. **CLEARING:**
All trees and/or brush which would interfere with the excavation operation must be cleared from the ditch right-of-way ahead of the construction operations. Stumps on the berm shall be removed or cut as low as cutting tools permit. All stumps on the slopes shall be removed. Cleared debris should be disposed of by burning or removed from the right-of-way.
- III. **BERM WIDTHS:**
Unless otherwise noted the berms will have the following minimum widths: four (4) feet wide for ditches up to four (4) foot depth; six (6) feet wide for four to six foot depth; and ten (10) feet wide for ditches over six feet in depth.
- IV. **SPOIL BANKS:**
Excavated material should be deposited and spread along one and/or both sides of the ditch, as determined, except where used for levees, and in overflow areas with timber or brush cover. Slope of the spoil after spreading should be at least 3:1 on the channel side and at least 4:1 on the field side. The height of the spoil should not exceed 9" above average ground level. Openings shall be provided for surface water to enter the ditch.
- V. **TILE OUTLETS:**
Landowners shall protect their tile outlets with a section of continuous rigid pipe and flap-gate or grid to exclude rodents. For details of construction, see your Soil Conservation Service technician.
- VI. **SURFACE WATER OUTLETS:**
Wherever a lateral or a surface ditch enters the main ditch at a higher elevation, protection from erosion should be provided by: drop structures, pipe drops, other suitable structure, or grassed waterway. For assistance on outlets, see your Soil Conservation Service technician.
- VII. **DITCH BANK SEEDING:**
Area to be seeded Berm .4 acres
Ditch Banks 1.2 acres.
The ditch banks will be seeded and fertilized each day within 24 hours after the clearing and shaping is completed. The berms will be seeded after spoil is spread. Seed will be covered by use of adjustable spike tooth harrow, if not seeded within the above time limit.

Permanent seeding. (To be completed prior to September 15.)
Seeding rate per acre:
40 pounds tall fescue - (Kentucky 31 or Alta)
500 pounds 12-12-12 or equivalent fertilizer
2 tons straw or hay per acre for mulch unless seed is applied within 24 hours of clearing and shaping
Temporary seeding. (Until permanent seeding is made.)
Seeding rate per acre:
2 bushels oats seeded during spring-summer; or 2 bushel wheat or rye seeded in the fall-winter may be used as a growing green mulch.
Mow when grass reaches a height of 10 to 12 inches.
The establishment of the seeding on the ditch bank and berm shall be the responsibility of the contractor. A minimum of 20 fescue plants per square foot will be considered adequate establishment.
- VIII. Existing culverts will be cleaned and the invert (flow line) lowered if necessary to correspond to the proposed ditch grade as indicated on the plan. If necessary, culverts will be enlarged to meet drainage design. Existing culverts will be repaired and extended if needed to meet specifications.
- IX. ALL OF THE ABOVE SPECIFICATIONS ARE TO BE COMPLETED BEFORE PERFORMANCE IS CERTIFIED.

- B.M.#1 TOP OF STEEL PIN UNDER METAL PLATE LOCATED IN CENTER OF 4-MILE HOUSE ROAD AND SCHNEIDER ROAD
M.S.L. ELEV. 594.50
- B.M.#2 TOP OF SANDUSKY COUNTY MARKER PIN LOCATED ON EAST SIDE OF 4-MILE HOUSE ROAD ACROSS FROM SCHNEIDER ROAD
M.S.L. ELEV. 594.11
- B.M.#3 SPIKE LOCATED IN WEST SIDE OF UTILITY POLE LOCATED IN S/E CORNER OF BLOOM AND 4-MILE HOUSE ROADS
M.S.L. ELEV. 591.71
- B.M.#4 CHISELED "X" ON TOP OF S/W CONCRETE HEADWALL OF BRIDGE ABUTMENT OVER NINE MILE CREEK AND WEST SIDE OF 4-MILE HOUSE ROAD
M.S.L. ELEV. 592.20
- B.M.#5 TOP OF 8" C.M.P. FROM R. GRADICK FARM
M.S.L. ELEV. 595.50

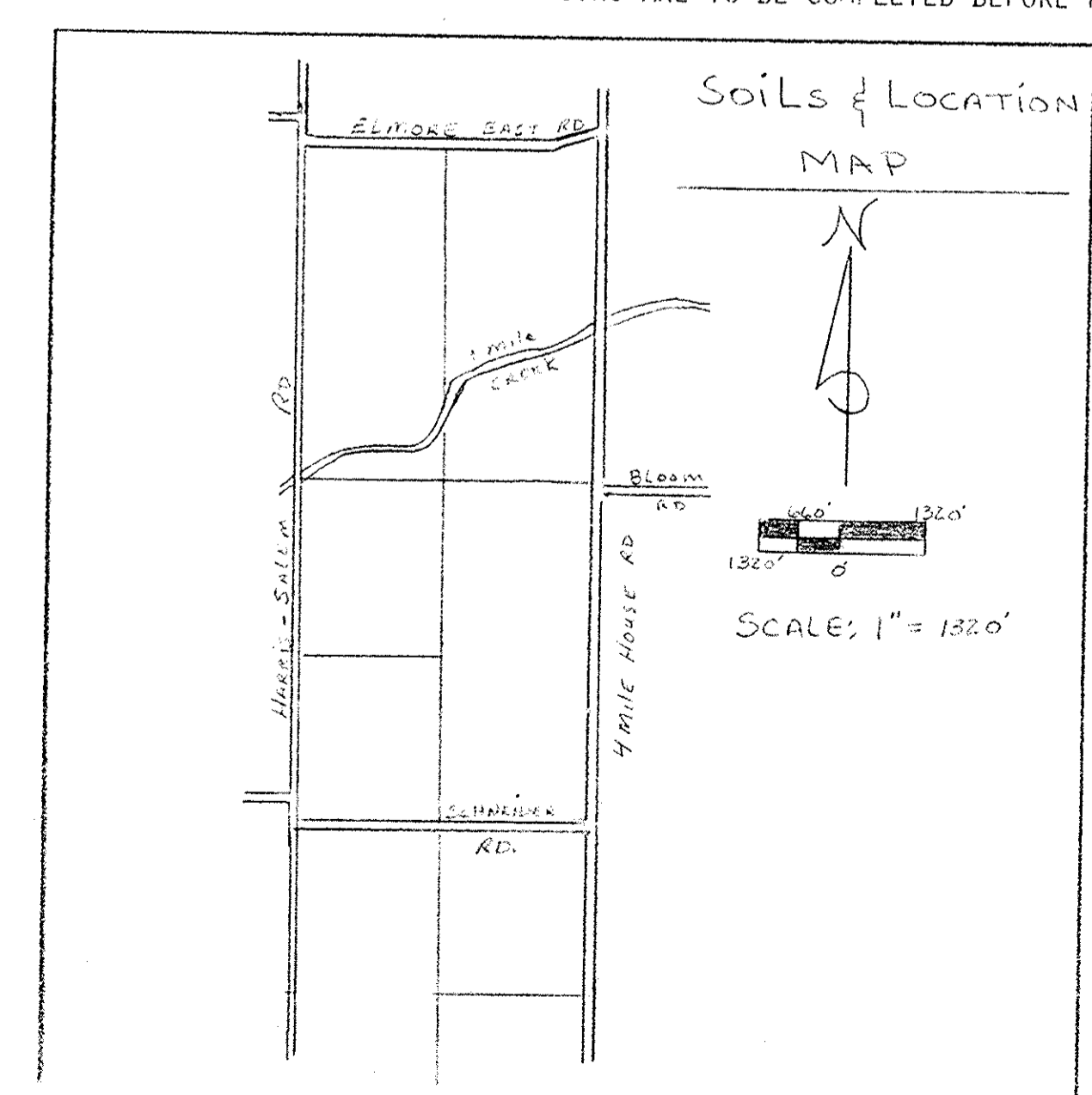

APPROVED BY
John L. Poppen
OTTAWA COUNTY ENGINEER

James H. ...
SALEM TWP TRUSTEES

9/14/79
DATE

DATE

JOB CLASS V
OUTLET DITCH IMPROVEMENT
MYLANDER JOINT CO. GROUP #129
SALEM TWP SEC. 19, OTTAWA CO.
U. S. DEPARTMENT OF AGRICULTURE
SOIL CONSERVATION SERVICE

| | | |
|------------------------|------------------|----------------------------------|
| Designed <i>A. ...</i> | Date <i>8/77</i> | Approved by <i>Arthur M. ...</i> |
| Drawn <i>M. ...</i> | Date <i>4/79</i> | Title <i>Ag. ...</i> |
| Traced <i>...</i> | Sheet <i>1</i> | Drawing No. <i>...</i> |
| Checked <i>H. ...</i> | Date <i>8-79</i> | No. <i>1</i> of <i>5</i> |

39-01-303-77-48