

*NOTE: RECEIVED 8/31/98 - ORIGINALS ON FILE AT THE SCS OFFICE. PLAN SHOWS THE AS-BUILT GRADES.
MCB

LOHRBACH DITCH

PROJECT # 96 - FILE 2.253

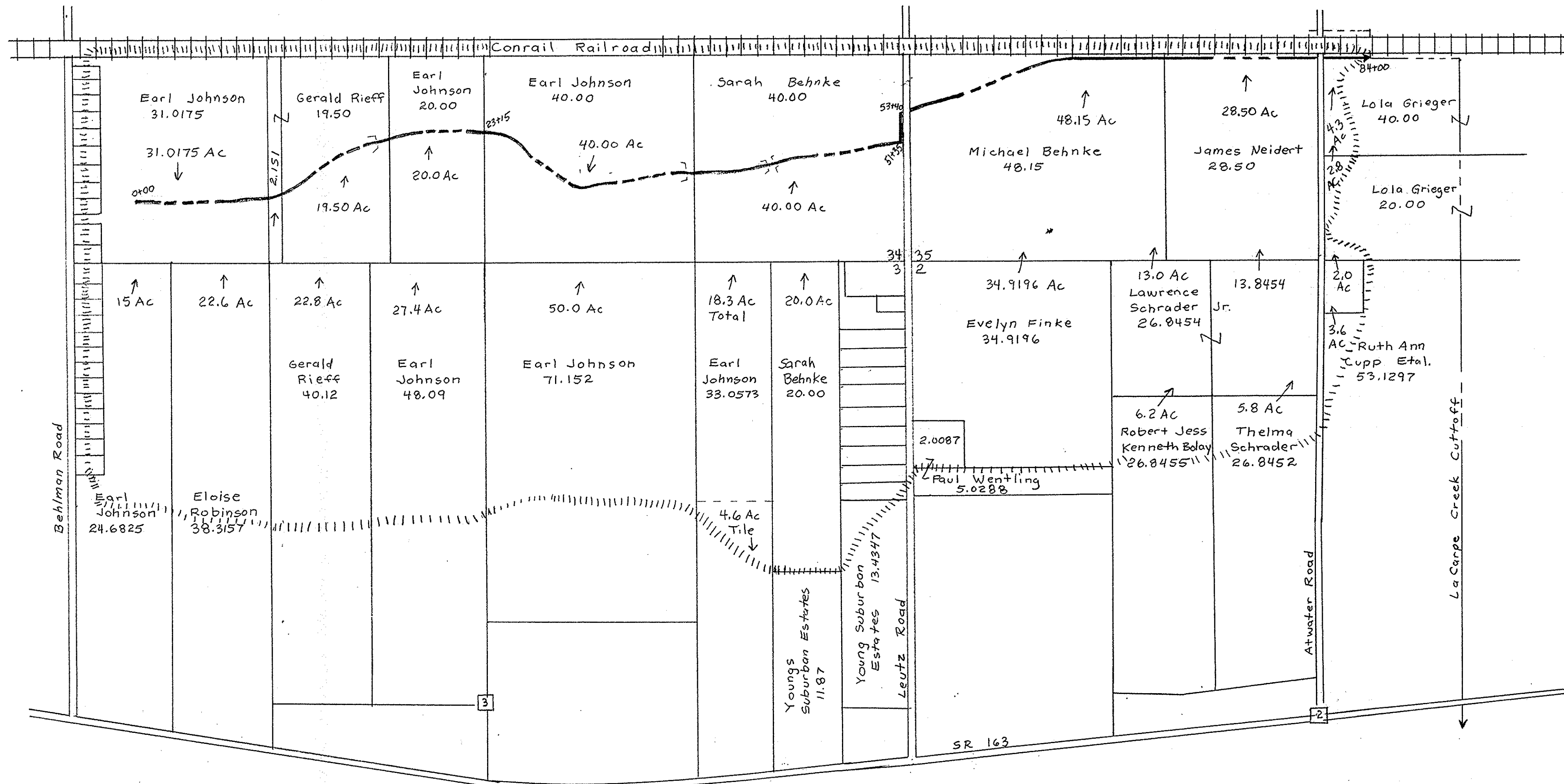

- LEGEND**
- ROAD
 - FENCE
 - PROPERTY LINE
 - EXISTING TILE
 - PROPOSED TILE
 - STATIONING
 - BENCHMARK
 - OPEN DITCH
 - SURFACE DRAINWAY
 - CONTOUR INTERVAL
 - SOIL TYPE
 - STREAM
 - DIKE
 - RAILROAD
 - WATERSHED

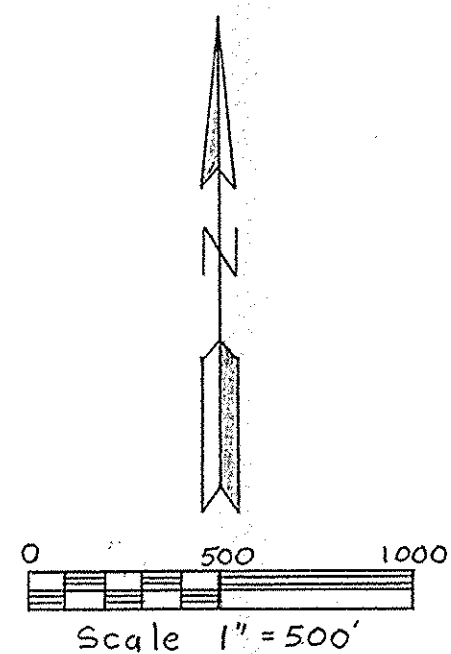

UNDERGROUND UTILITIES AT EXCAVATION SITE				
Name	Address	Phone No.	Member OUPS	Limited Basis Participants
960529	Utility 529042034			
ATT	North Side RR		X	
World Comm	North Side RR		X	

NOTE TO EXCAVATOR

Excavator must notify all utilities at least 48 hours and not more than 10 days prior to the planned commencement of excavation.

- Member utilities will be contacted by calling OUPS (1-800-362-2764).
- Each Limited Basis Participant and members of the Ohio Oil and Gas Association will be contacted by the excavator using the telephone number provided.

Robert C. Stearns 4-17-97
OTTAWA COUNTY ENGINEER

Michael R. Gargac
CONSTRUCTION APPROVED BY

JOB CLASS II

LOHRBACH DITCH
OUTLET DITCH IMPROVEMENT
SALEM TOWNSHIP
OTTAWA COUNTY OHIO

**U. S. DEPARTMENT OF AGRICULTURE
SOIL CONSERVATION SERVICE**

Date: 4/96
Designed: Michael Gargac
Drawn: Michael Gargac
Checked: *Def. Sonne*

Approved: *Robert C. Stearns*
Title: *Civil Eng. Supv.*

Title: _____
Sheet: No. 1 of 6
Drawing No.: 39-01-383-96-09

Revised: 970408/970417/970910

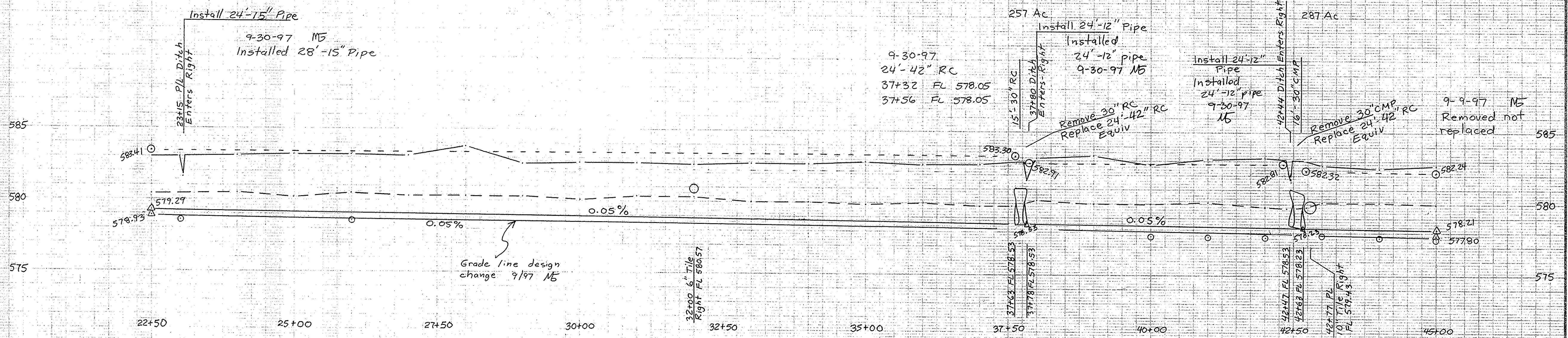
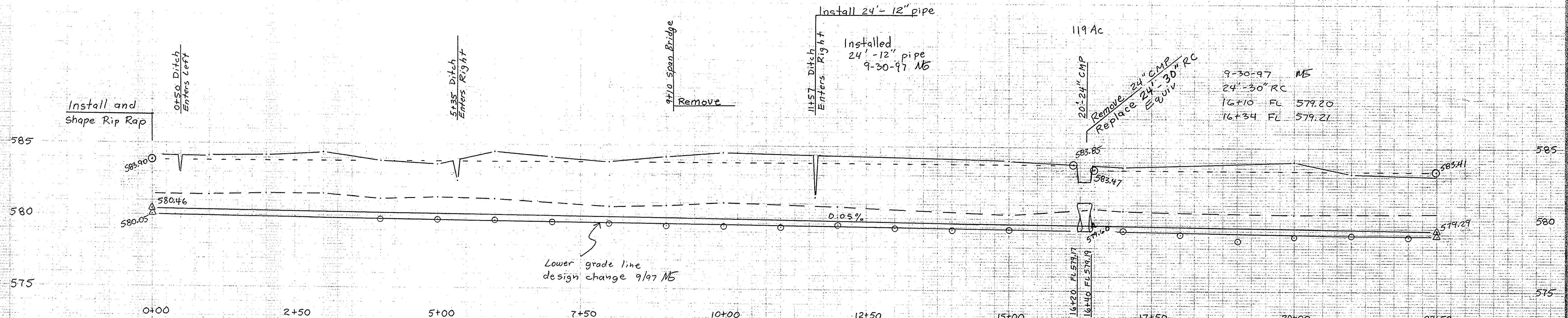

○ ○ ○ As built grade line

LOHRBACH DITCH

**U. S. DEPARTMENT OF AGRICULTURE
SOIL CONSERVATION SERVICE**

Designed Michael Gargac	Date 4-96	Approved by <i>Mike Sommer</i>	Title <i>Civil Eng. Job</i>
Drawn Michael Gargac	Date 4-96		
Traced		Sheet No. 2	Drawing No.
Checked <i>Mike Sommer</i>	Date 4/97	No. of 6	39-01-383-96-09

Revised: 970408/970417/970910/970916/970930

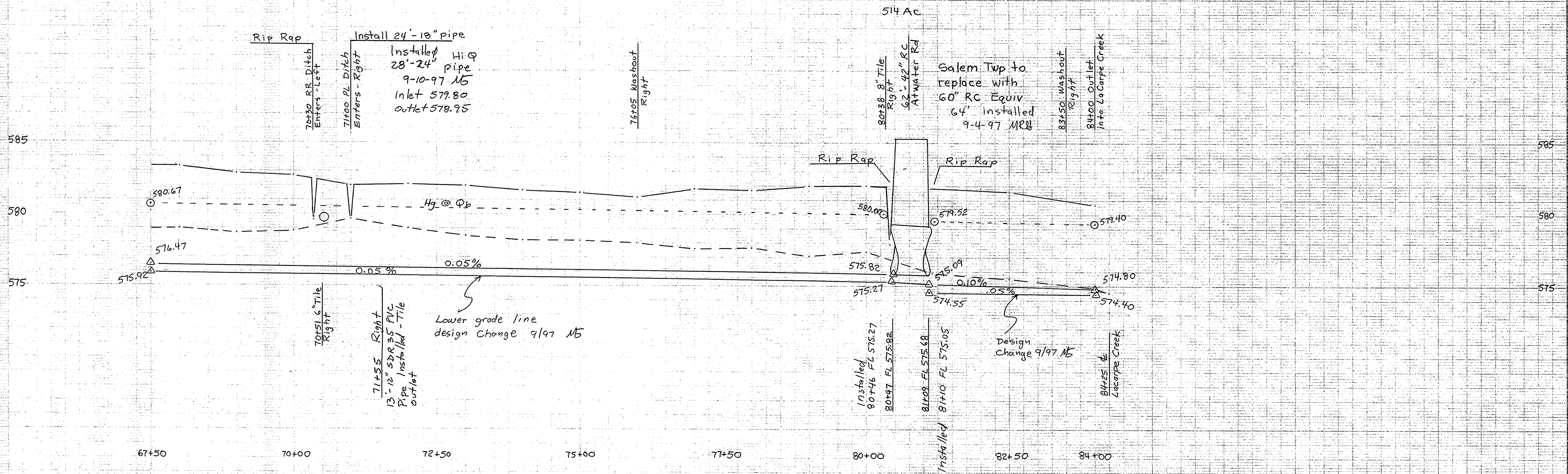
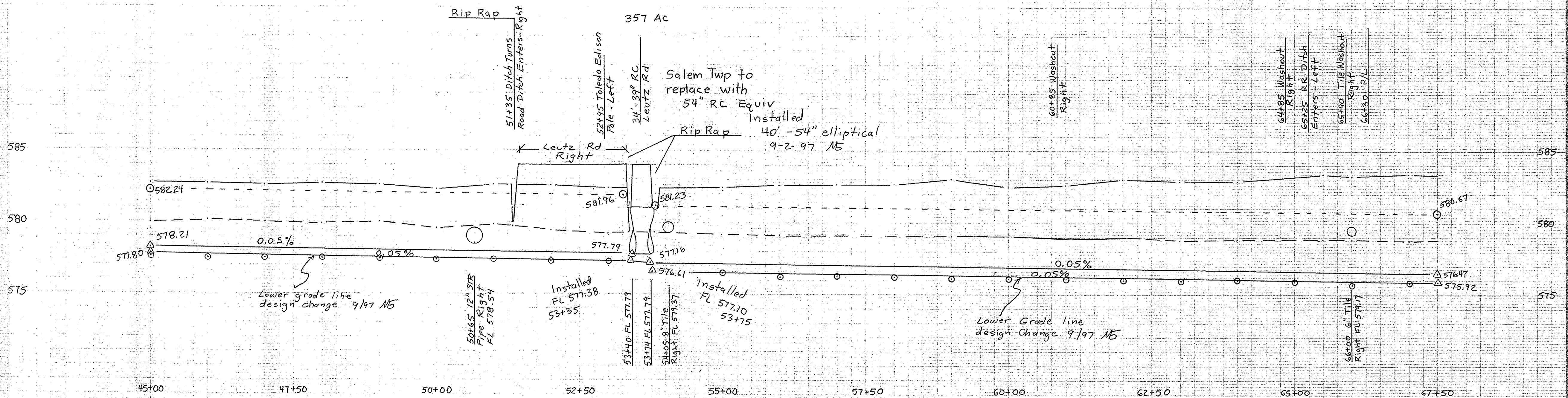

LOHRBACH DITCH

**U. S. DEPARTMENT OF AGRICULTURE
SOIL CONSERVATION SERVICE**

Designed <u>Michael Gargac</u>	Date <u>4-96</u>	Approved <u>Boyle J. Sommer</u>	Title <u>Chris Gargac</u>
Drawn <u>Michael Gargac</u>	Date <u>4-96</u>	Title	
Traced	Sheet <u>3</u>	Drawing No.	
Checked <u>Boyle J. Sommer</u>	Date <u>4/97</u>	No. <u>3</u>	<u>39-01-383-96-09</u>
		of <u>6</u>	

Revised: 970408/970417/970910/970916

2:1 Side Slopes

2:1 Side Slopes

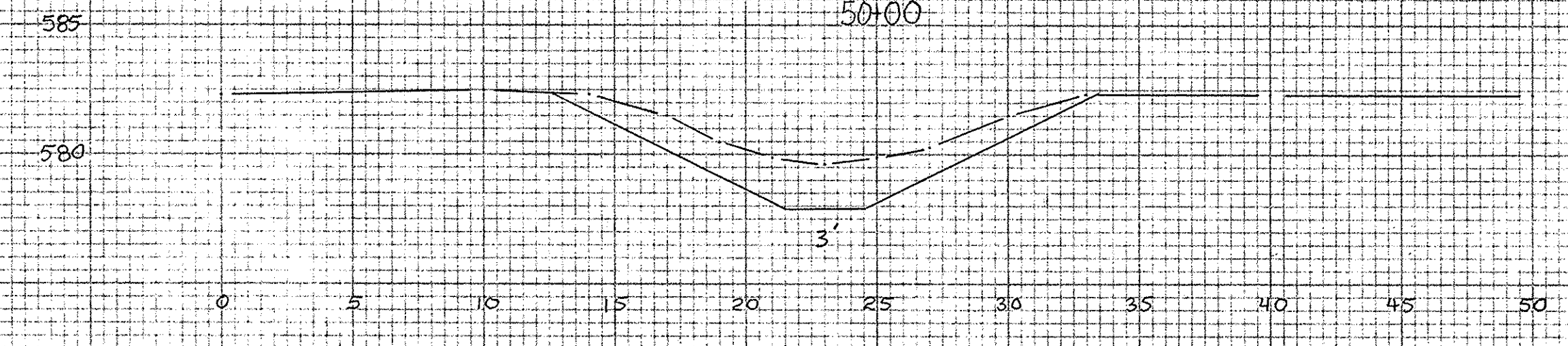
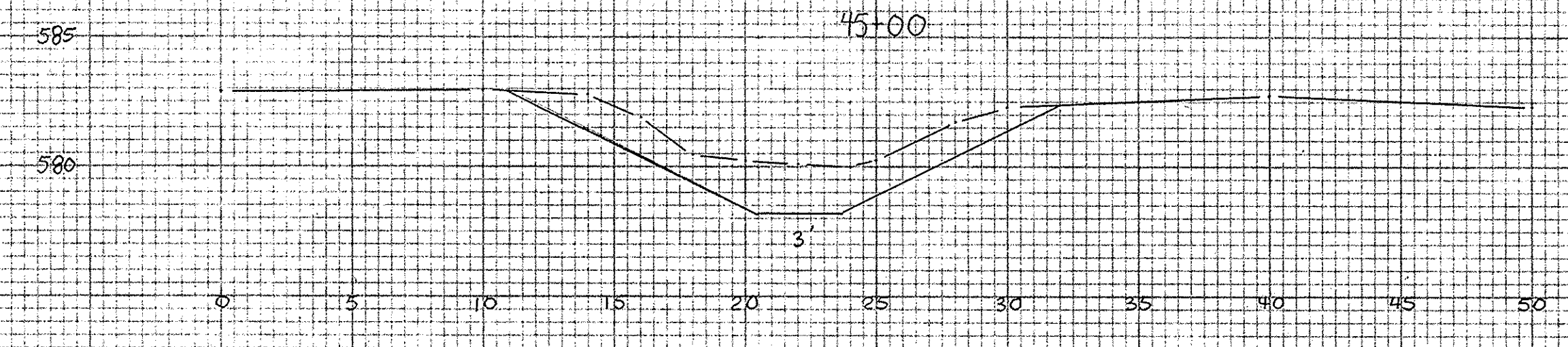
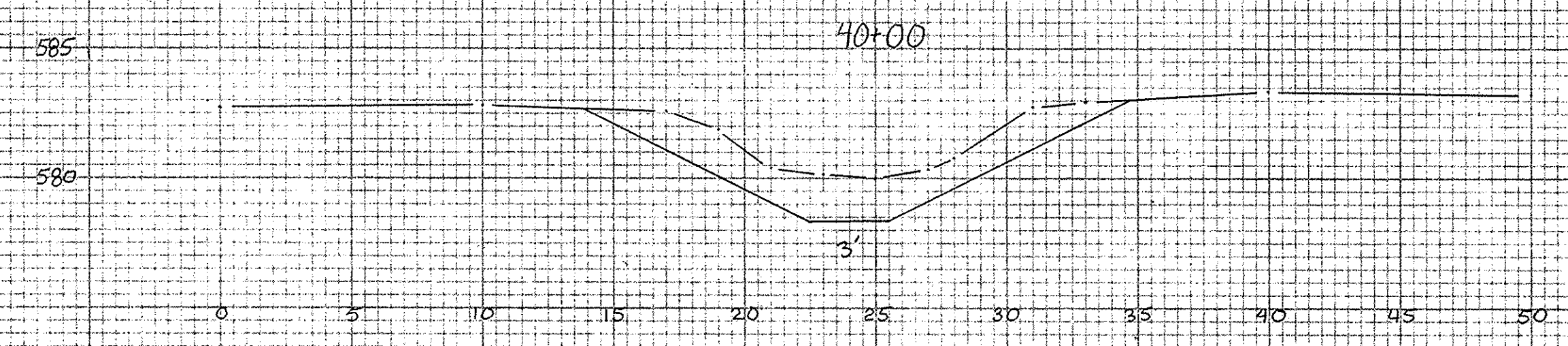
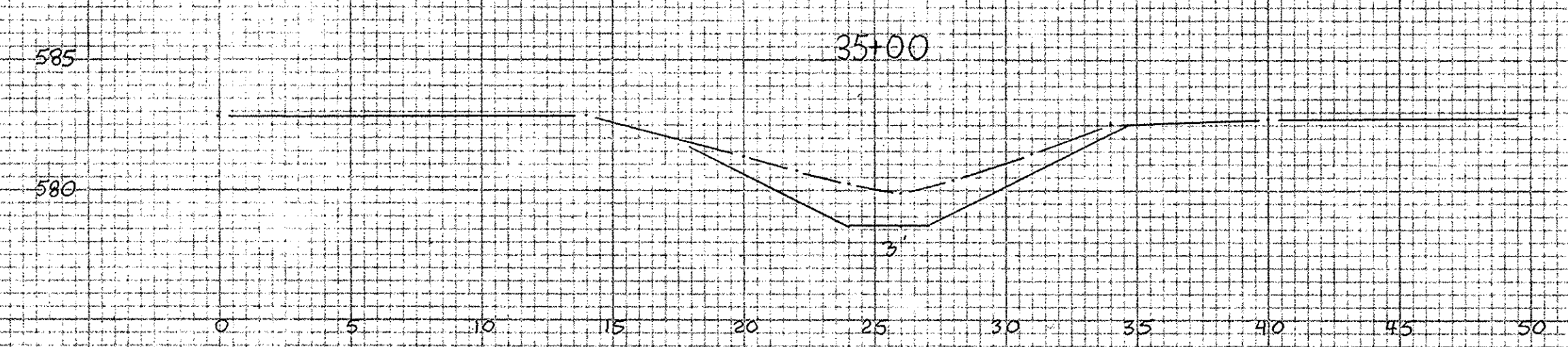
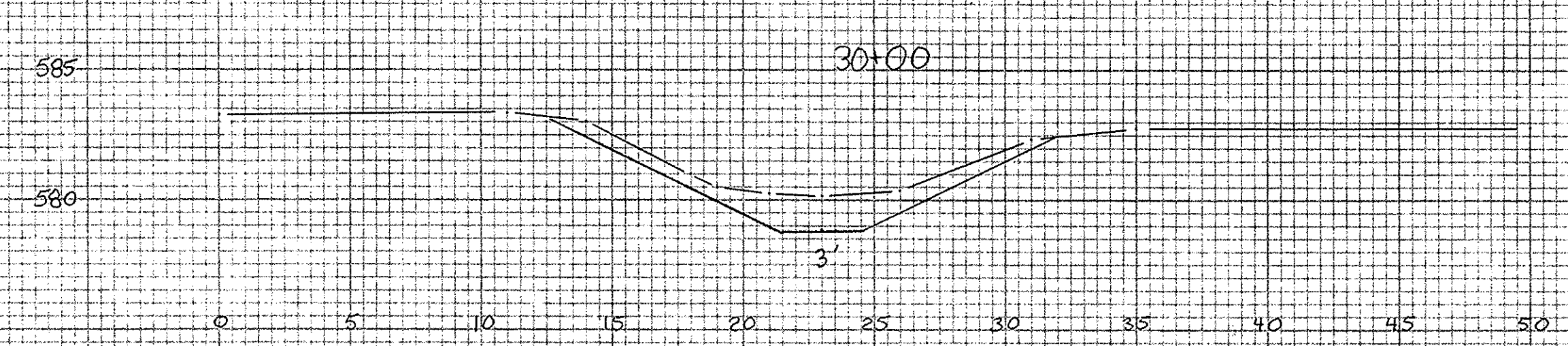
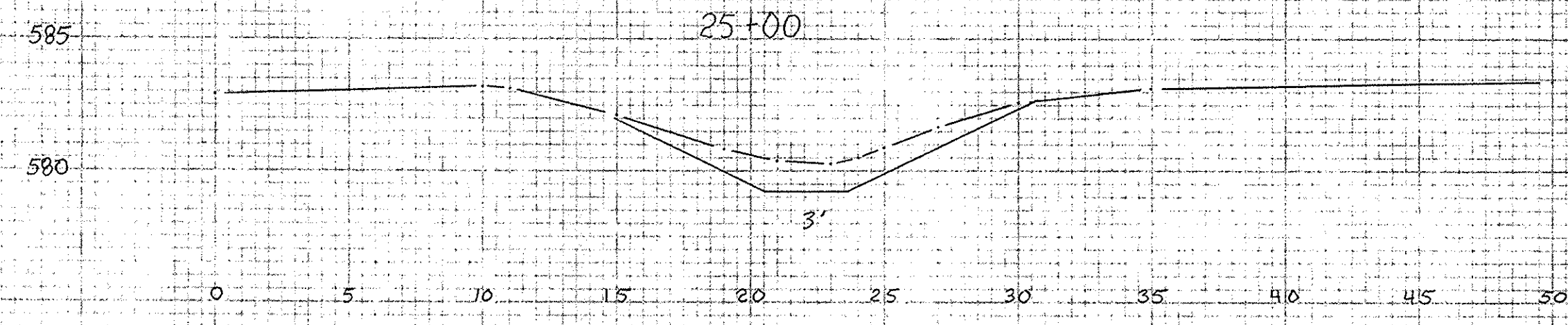
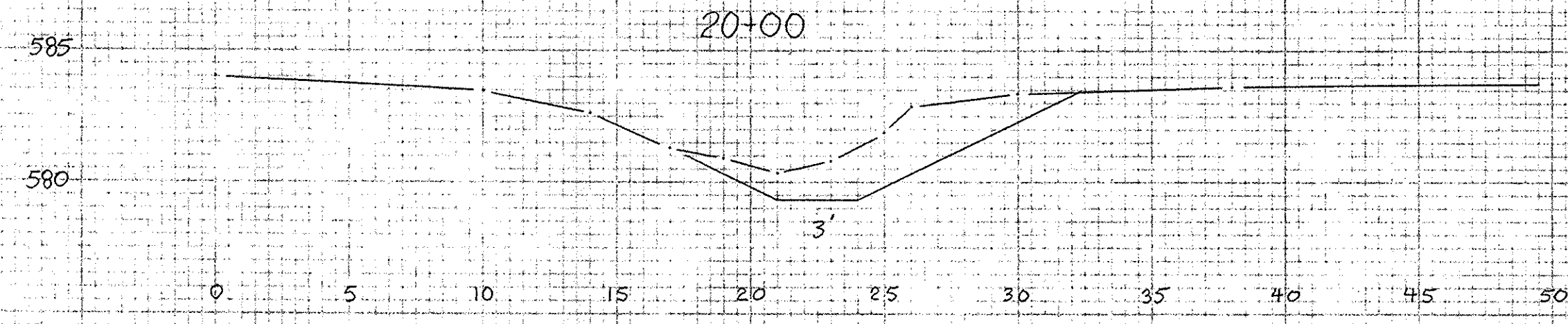
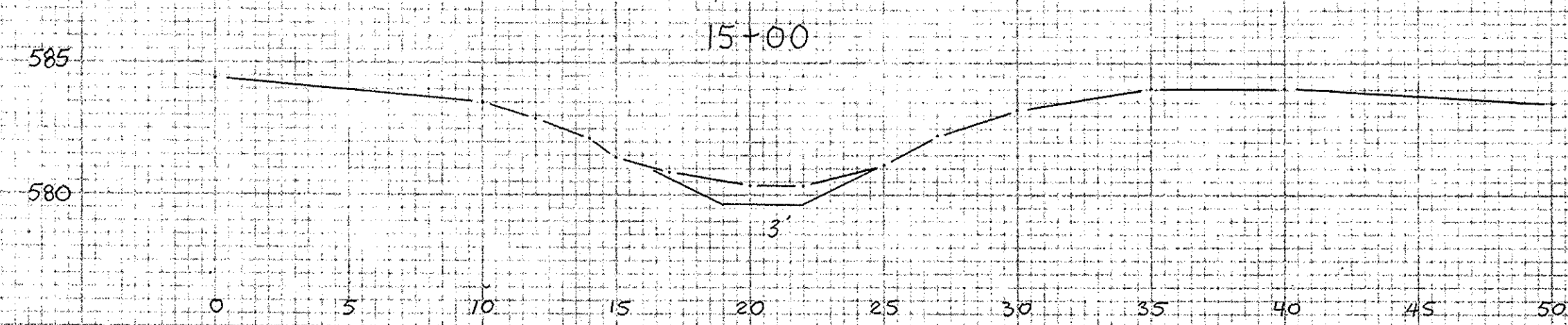
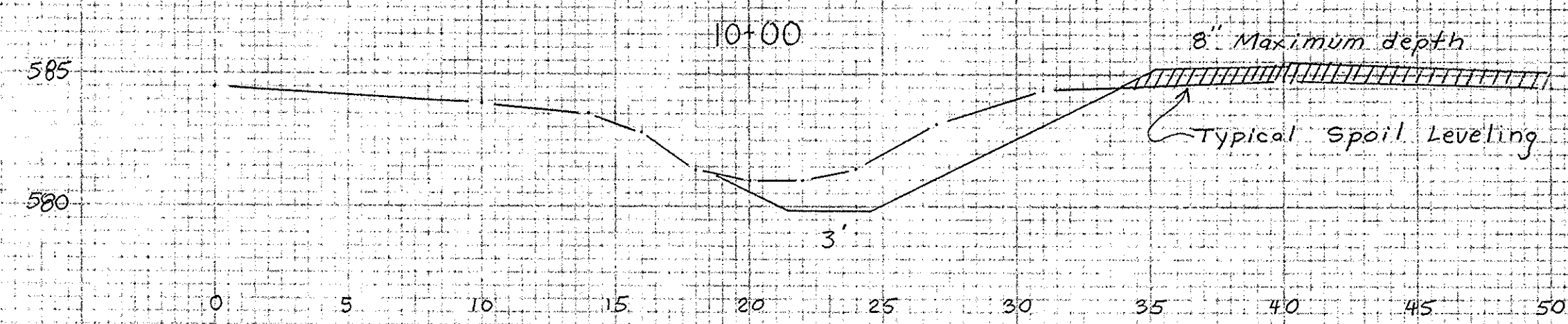
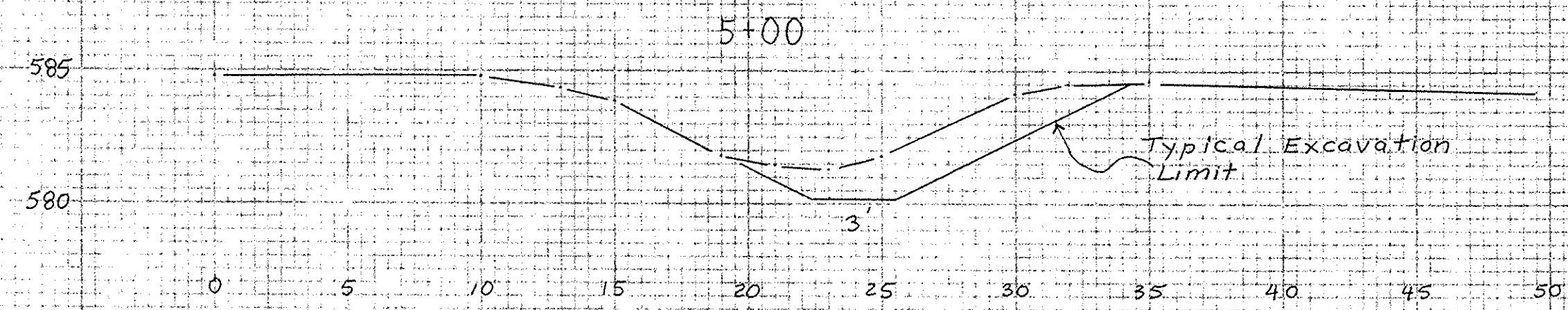
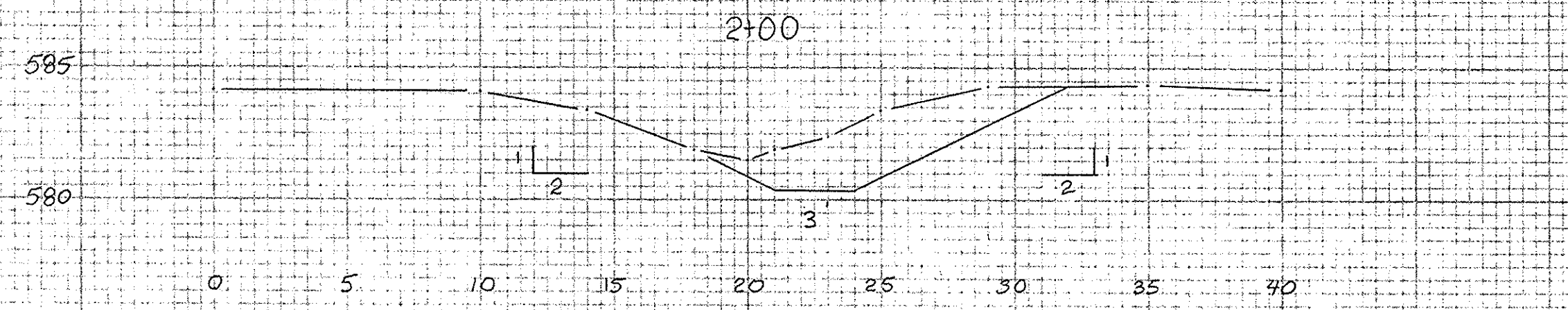

LOHRBACH DITCH

U. S. DEPARTMENT OF AGRICULTURE
SOIL CONSERVATION SERVICE

Designed	Michael Gargac	Date	4/96	Approved by	<i>Michael Gargac</i>
Drawn	Michael Gargac		4/96	Title	<i>Civil Eng. Tech</i>
Traced				Title	
Checked	<i>Michael Gargac</i>		4/97	Sheet	No 4
				of	6
				Drawing No.	39-01-383-96-09

Revised 9/7/08

2:1 Side Slopes

2:1 Side Slopes

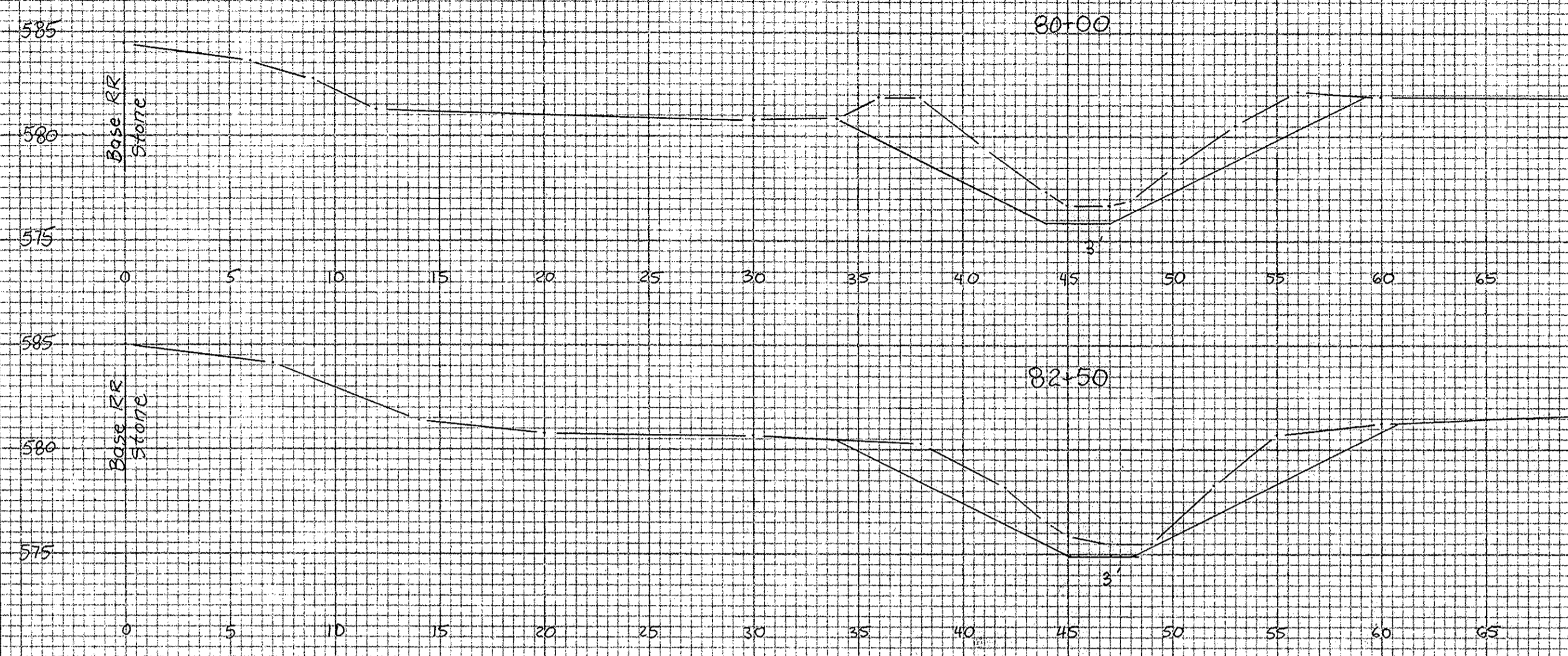
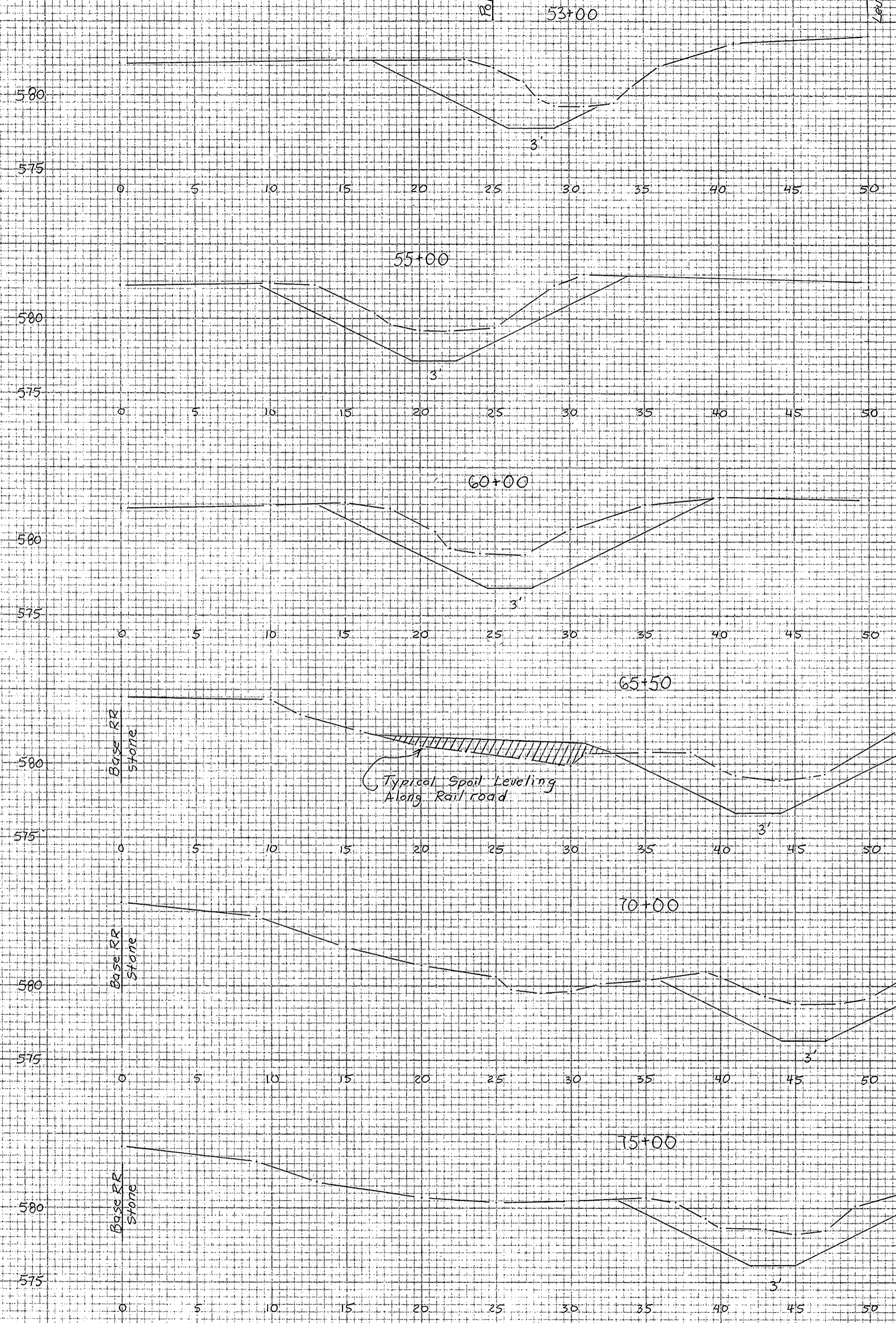

BENCHMARK DESCRIPTIONS

B.M. #1	Top of chiseled "X" on top of headwall on south side of Conrail Railroad on LaCarpe Creek at Station 84 + 00 on Lohrbach Ditch. M.S.L. Elevation 586.12	
B.M. #2	Top of chiseled "X" on top of west end of 42" R/C culvert under Atwater Road at Station 80 + 47. M.S.L. Elevation 580.81 580.79	Destroyed and reset
B.M. #3	Top of chiseled "X" on headwall located on south side of Conrail Railroad on side ditch at Station 65 + 25. M.S.L. Elevation 585.03	
B.M. #4	Top of chiseled "X" on top of west end of 39" R/C culvert under Leutz Road at Station 53 + 40. M.S.L. Elevation 581.49 581.53	Destroyed and reset
B.M. #5	Top of chiseled "X" on top of west end of 30" R/C culvert under farm lane at Station 37 + 78. M.S.L. Elevation 581.35	
B.M. #6	Top of vertical spike in south side of 48" D.B.H. oak tree on south side of Lohrbach Ditch at Station 15 + 50. M.S.L. Elevation 584.84	
B.M. #7	Top of spike in south side of 48" D.B.H. oak tree located on north side of Lohrbach Ditch at Station 9 + 50. M.S.L. Elevation 584.86	
B.M. #8	Top of spike in south side of 15" D.B.H. oak tree on north side of Lohrbach Ditch at Station 2 + 75. M.S.L. Elevation 585.58	

LOHRBACH DITCH

U. S. DEPARTMENT OF AGRICULTURE
SOIL CONSERVATION SERVICE

Designed: Michael Gargac	Date: 4-96	Approved: <i>[Signature]</i>
Drawn: Michael Gargac	Date: 9-96	Title: Civil Eng. Draft
Traced: _____	Title: _____	Sheet No. 5 of 6
Checked: <i>[Signature]</i>	Date: 4/97	Drawing No. 39-01-383-96-09

Revised: 970408 / 970910

Two Sided Construction

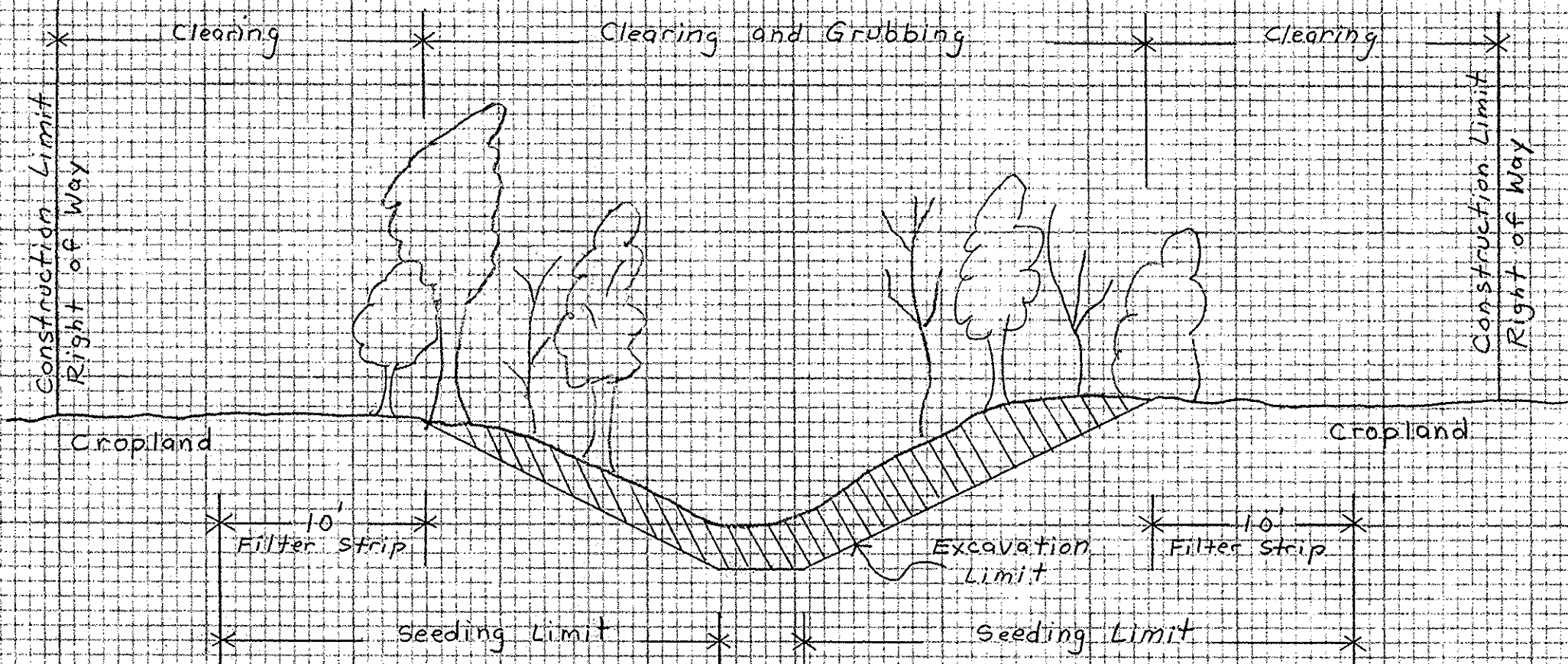

Culvert Rip Rap Detail

End View - Inlet and Outlet

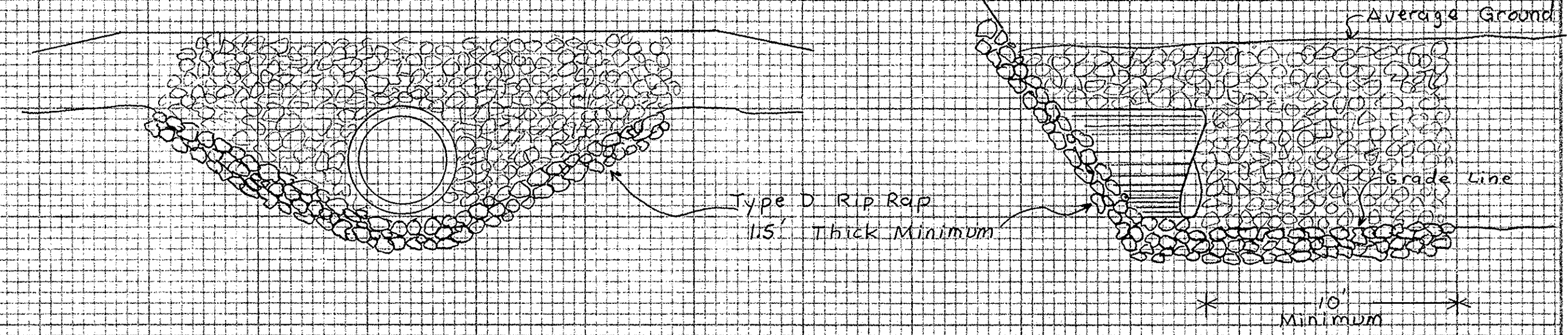

One Sided Construction

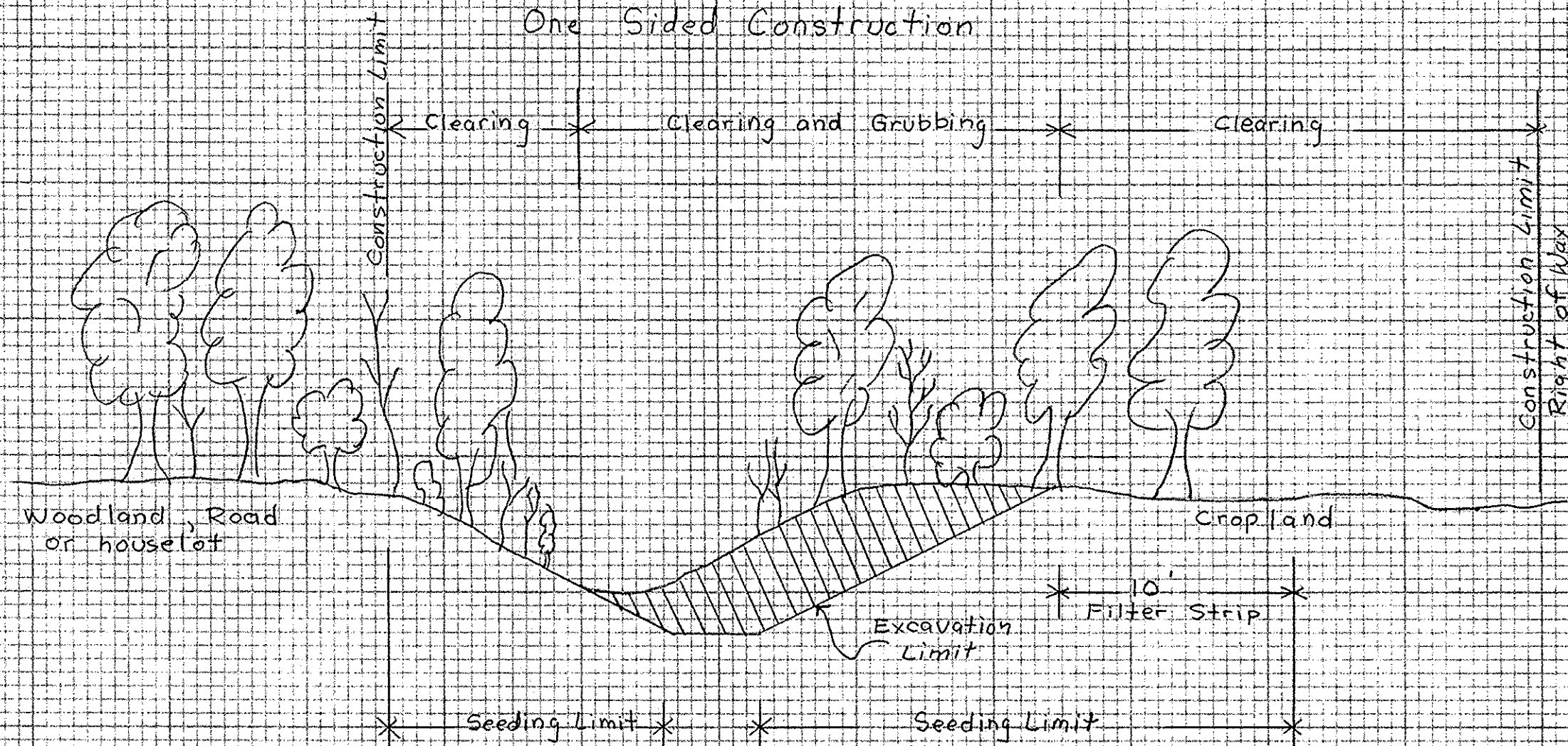

Tile Outlet Pipe Detail

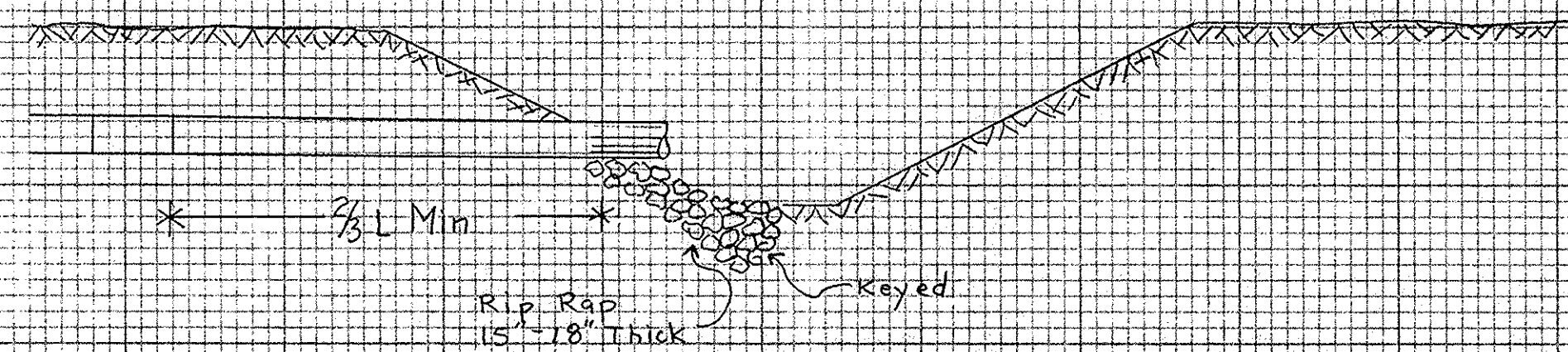

Typical Erosion Control Structure - Detail

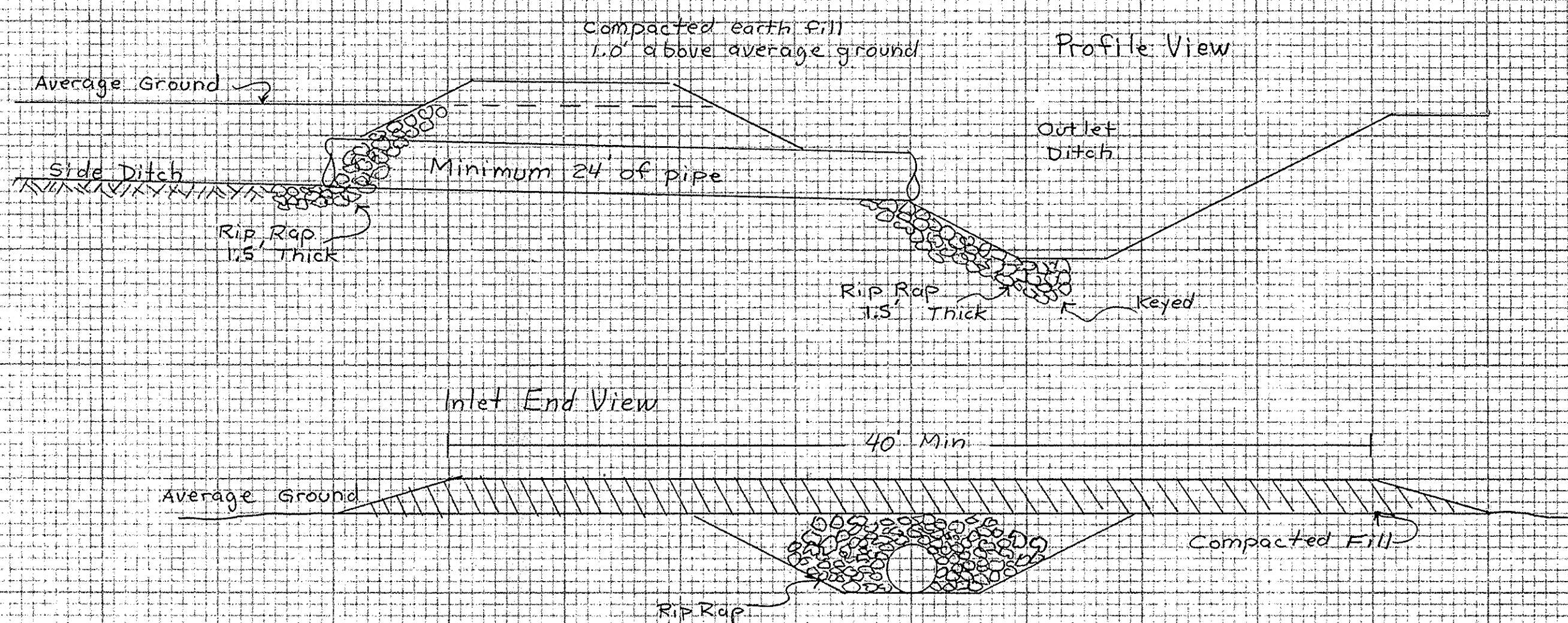

SOILS DESCRIPTIONS

- npA - Nappanee Silty Clay Loam** - This deep, nearly level, somewhat poorly drained soil is on slight convex rises and side slopes along drainageways on lake plains. Most areas range from 4 to 75 acres.
- To - Toledo Silty Clay** - This deep, nearly level, very poorly drained soil is on broad flats and in long, narrow concave areas on lake plains. It is subject to ponding of short duration. Most areas range from 5 to more than 100 acres. Slope is 0 to 2 percent.

Revised: 970408

LOHRBACH DITCH

U. S. DEPARTMENT OF AGRICULTURE
SOIL CONSERVATION SERVICE

Designed: Michael Gargac	Date: 5/96	Approved: <i>[Signature]</i>
Drawn: Michael Gargac	Date: 5/96	Title: Civil Eng. Tech
Traced:		Title:
Checked: <i>[Signature]</i>	Date: 4/97	Sheet No. 6 of 6
		Drawing No. 39-01-383-96-09