

OTTAWA COUNTY ENGINEERS OFFICE

REFERENCE NO. 16-6-14-F
 EAST QUARTER POST SEC. 16
 HARRIS TWP.
SHEET 1 OF 1.

ROUTE: T-45 HESSVILLE RD. @
 T-83 WEIS RD.

TOWNSHIP: HARRIS

SECTION: 16

T 6 **NR** 14 **E.**

NORTHING:

EASTING:

DATUM:

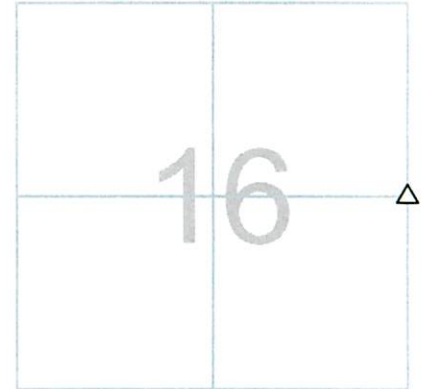

PERSONNEL:
 M. WITTMAN, P.S.
 M. BROUGH
 R. LAJTI, JR.

DATE / WEATHER / TEMP:
 OCTOBER 8, 2003
 SUNNY / BREEZY
 65° F

MONUMENT INFORMATION

MONUMENT TYPE: FD HARD HEAD STONE
 ON SURFACE - BELOW: 1.41'
 LEFT - CL PAV'T - RIGHT: (T-45)
 RECTANGULAR STONE: 9" x 12"

 USED DRILL HOLE.

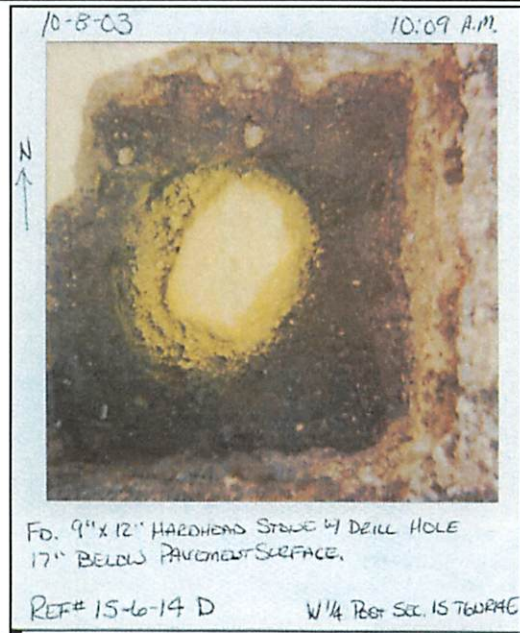

MISC. INFORMATION

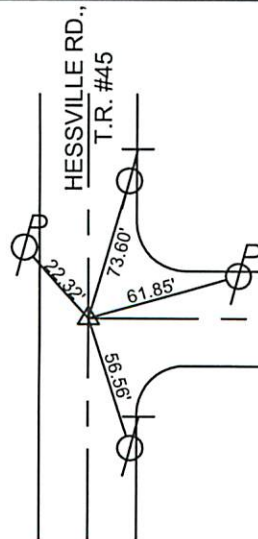

OCTOBER 8, 2003

SET 1" SQUARE IRON PIN
 IN MONUMENT BOX OVER
 STONE

SHORT TIES
 SET P.K. NAIL N - 3.00'
 SET P.K. NAIL E - 3.00'
 SET P.K. NAIL S - 3.00'
 SET P.K. NAIL W - 3.00'