



OTTAWA COUNTY BENCHMARK DATA SHEET



HAR 7-1.0

Township	Section	Town	Range	Type of Monument
HARRIS	23	T6N	R13E	3 1/4" Domed Bronze Disk in Concrete (OCE Spec. BM-1)
Set By	Shot By	Calculated	Calculated By	Published
OCE / OCHD	J. Allen	March 8, 2012	M. J. Wittman, P.S.	March 16, 2012

Location

East side of Martin-Williston Rd., T.R. #7, southeast of the Northwest Corner of Section 23, T6N R13E

Vertical Control		
Vertical Datum	Method	Elevation (U.S. Survey Feet)
NAVD 88	GPS	622.50

Horizontal Control			
Horizontal Datum	Zone	Northing	Easting
NAD 83 CORS 96	OHIO NORTH 3401	658,868.395	1,738,768.313
Method	Latitude	Longitude	
GPS / CORPSCON	41° 28' 19.49451" N	83° 20' 17.92597" W	
Geoid	Scale Factor	Convergence	
GEOID 09	0.999964003	- 00° 33 02.62741"	

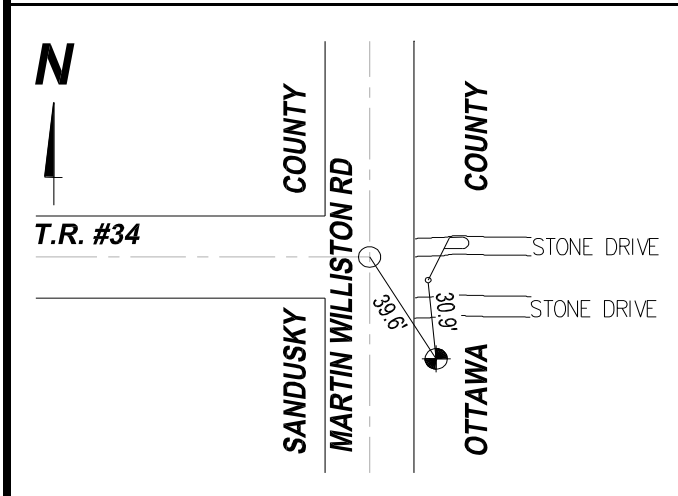

NOTES:

1. Monument set: August 16, 2011
2. Data Collected: 1-31-12, 2-9-12, 2-17-12