

OTTAWA COUNTY ENGINEERS OFFICE

REFERENCE NO. 31-7-16-A
 NW CORNER POST SEC. 31
 ERIE TWP.

SHEET 1 OF 1.

PERSONNEL:
 M. WITTMAN, P.S.
 J. ALLEN

DATE / WEATHER / TEMP:
 NOVEMBER 9, 2012
 SUNNY
 50° F

ROUTE: T-131 FRITCHIE RD.
 @ C-26 CARROLL-ERIE RD.

TOWNSHIP: ERIE

SECTION: 31

T 7 **NR** 16 **E.**

NORTHING:

EASTING:

DATUM:

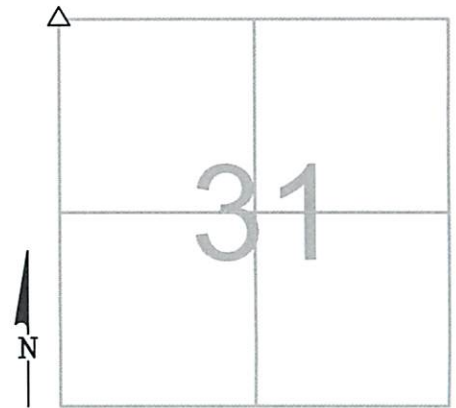

MONUMENT INFORMATION

MONUMENT TYPE: FD. 5-1/2" SQ. STONE W/ DH
 ON SURFACE - BELOW: 1.57'
 LEFT - CL PAV'T - RIGHT: 2.40'

USED DRILL HOLE.



MISC. INFORMATION

FD. PK NAIL 0.30' BELOW SURFACE, TIED W/ X-TIES
 AND DUG FOR STONE. PK NAIL WAS 0.04' NORTH
 AND 0.01' WEST OF DRILL HOLE.

THIS IS A CLOSING CORNER.

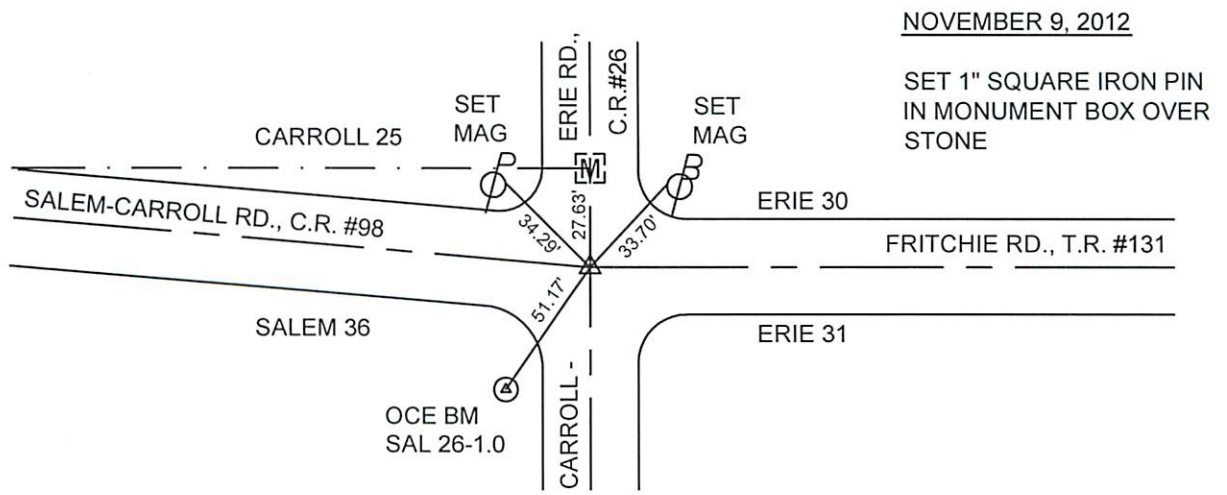

NOVEMBER 9, 2012

SET 1" SQUARE IRON PIN
 IN MONUMENT BOX OVER
 STONE