

OTTAWA COUNTY ENGINEERS OFFICE

REFERENCE NO. 30-7-16-B
 NORTH QUARTER POST SEC. 30
 ERIE TWP.
SHEET 1 OF 1.

ROUTE: C-15 CAMP PERRY WESTERN RD.
 @ T-13 RYMERS RD.

TOWNSHIP: ERIE

SECTION: 30

T 7 **NR** 16 **E.**

PERSONNEL:
 M. WITTMAN, P.S.
 J. ALLEN
 J. TIMMONS

NORTHING:

EASTING:

DATE / WEATHER / TEMP:
 JULY 13, 2016
 SUNNY - W-NW
 86° F - HUMID

DATUM:

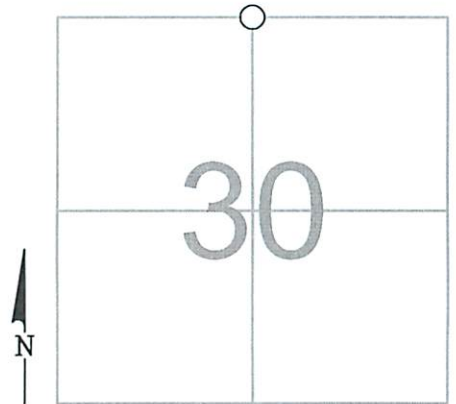

MONUMENT INFORMATION

MONUMENT TYPE: FD. 1-3/4" Ø IRON PIN
 ON SURFACE - BELOW: 1.04'
 LEFT - CL PAV'T - RIGHT: 2.30' (CAMP PERRY WSTRN)
 LEFT - CL PAV'T - RIGHT: 1.0' (RYMERS)



MISC. INFORMATION

FD. IRON PIPE 0.25' BELOW SURFACE, TIED W/ GPS
 AND DUG FOR IRON PIN OR OF RECORD. IRON PIPE
 BECAME LOOSE AFTER DIGGING 0.5' DOWN AND
 DISCOVERED IRON PIPE WAS ONLY 3-1/4" LONG. FD.
 LARGE IRON PIN 1.04' DOWN. IRON PIPE STUB WAS
 0.02' WEST AND 0.02' SOUTH OF CENTER OF IRON
 PIN.

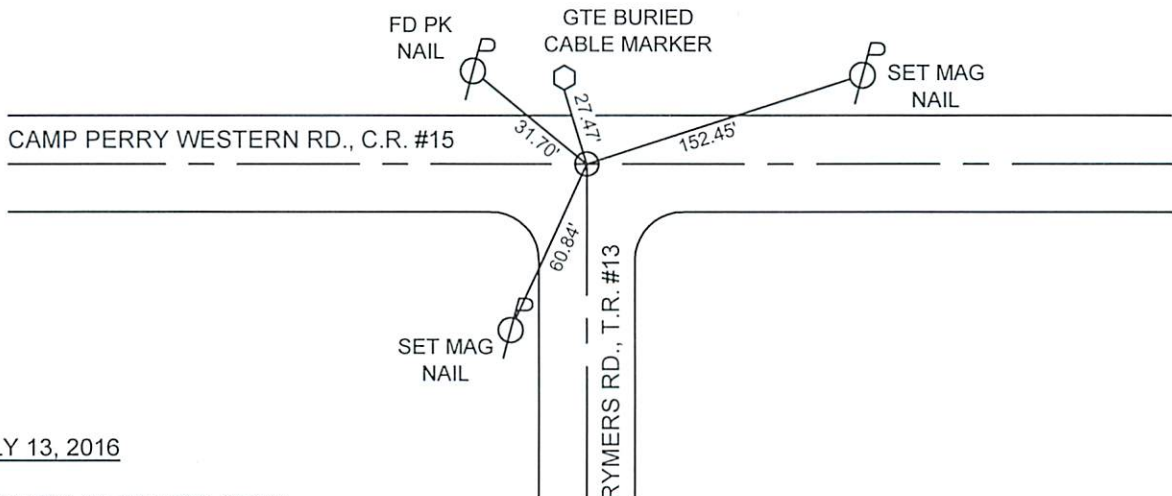
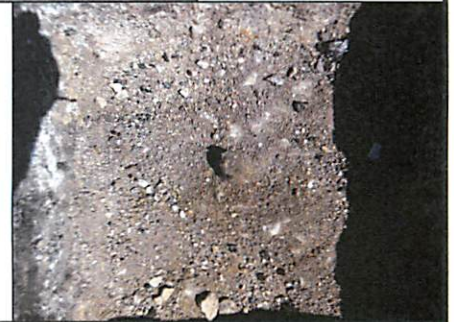

JULY 13, 2016

SET MONUMENT BOX OVER
 1-3/4" Ø IRON PIN