

OTTAWA COUNTY ENGINEERS OFFICE

REFERENCE NO. 19-7-16-D
WEST QUARTER POST SEC. 19
ERIE TWP.
SHEET 1 OF 1.

ROUTE: C-26 CARROLL-ERIE RD.

TOWNSHIP: ERIE

SECTION: 19

T 7 NR 16 E.

PERSONNEL:

M. BROUGH
J. LLEN
C. MILLER
A. WEIRICH, P.S - BEC ASSOC.
J. HAYES - BEC ASSOC.

NORTHING:

EASTING:

DATE / WEATHER / TEMP:

MAY 3, 2013
SUNNY - SE
80° F

DATUM:

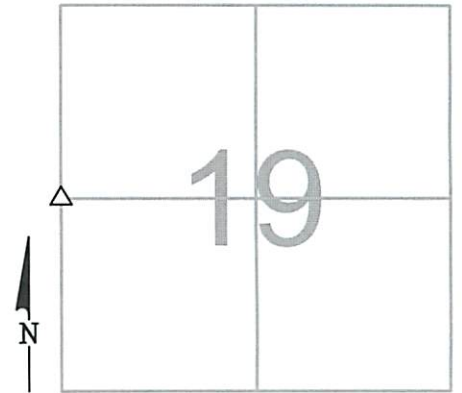

MONUMENT INFORMATION

MONUMENT TYPE: FD. LIMESTONE
ON SURFACE - BELOW: 1.58'
LEFT - CL PAV'T - RIGHT: 5.50'

STONE IS 6" E/W x 7" N/S WITH 4" x 4" SQ. TOP
SET AND USED DRILL HOLE IN HIGH POINT
THIS IS A CLOSING CORNER



MISC. INFORMATION

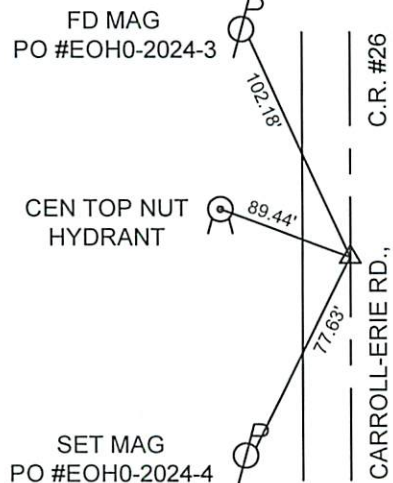

MAY 3, 2013

SET 1" SQUARE IRON PIN
IN MONUMENT BOX OVER
STONE