

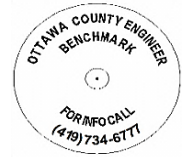

# OTTAWA COUNTY BENCHMARK DATA SHEET



## DAN 135-4.0

<b>Township</b>	<b>Section</b>	<b>Town</b>	<b>Range</b>	<b>Type of Monument</b>
Danbury	SEC 2 LOT 3			3 1/4" Domed Bronze Disk in Concrete (OCE Spec. BM-1)
<b>Set By</b>	<b>Shot By</b>	<b>Calculated</b>	<b>Calculated By</b>	<b>Published</b>
OCE / OCHD	J. Allen	March 8, 2012	M. J. Wittman, P.S.	March 16, 2012

**Location**

North side of Bayshore Rd., C.R. #135 west of the Meadowbrook Bridge

<b>Vertical Control</b>		
<b>Vertical Datum</b>	<b>Method</b>	<b>Elevation (U.S. Survey Feet)</b>
NAVD 88	GPS	575.34

<b>Horizontal Control</b>			
<b>Horizontal Datum</b>	<b>Zone</b>	<b>Northing</b>	<b>Easting</b>
NAD 83 CORS 96	OHIO NORTH 3401	670,746.913	1,892,880.690
<b>Method</b>	<b>Latitude</b>	<b>Longitude</b>	
GPS / CORPSCON	41° 30' 26.58179" N	82° 46' 33.91266" W	
<b>Geoid</b>	<b>Scale Factor</b>	<b>Convergence</b>	
GEOID 09	0.999968538	- 00° 10' 52.95123"	

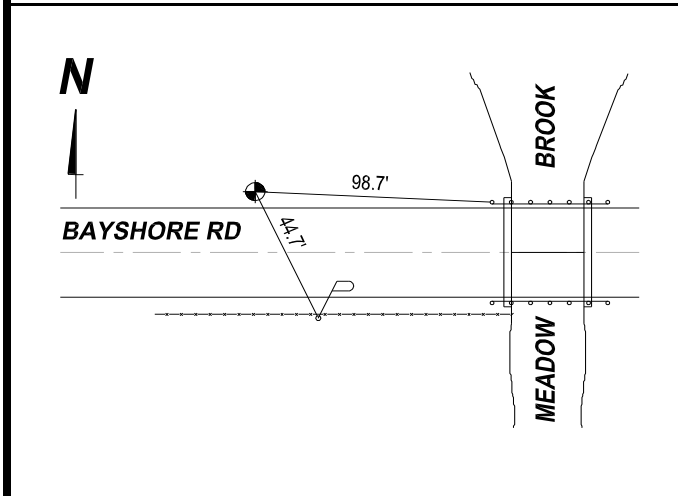

**NOTES:**

1. Monument set: December 22, 2011
2. Data Collected: 2-7-12, 2-16-12, 3-2-12