

OTTAWA COUNTY ENGINEERS OFFICE

REFERENCE NO. 23-7-13-D
 W. QUARTER POST SECTION 23
 CLAY TWP.
SHEET 1 OF 1.

ROUTE: C-7 MARTIN WILLISTON RD.

TOWNSHIP: CLAY

SECTION: 23

T 7 **NR** 13 **E.**

PERSONNEL:
 M. WITTMAN, P.S.
 M. BROUGH
 R. LAJTI, JR.

NORTHING:

EASTING:

DATUM:

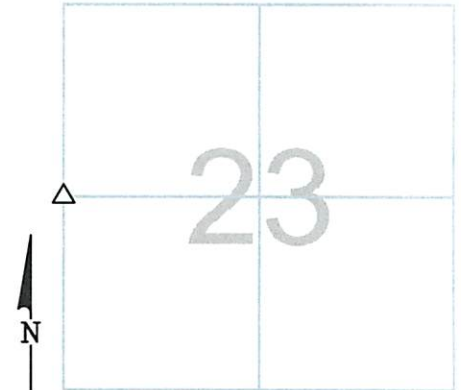

DATE / WEATHER / TEMP:
 JUNE 26, 2003
 SUNNY
 73° F

MONUMENT INFORMATION

MONUMENT TYPE: FD STONE W/ DRILL HOLE
 ON SURFACE - BELOW: 1.74
LEFT - CL PAV'T - RIGHT: (C-7)
 HEART SHAPED STONE: 6 $\frac{1}{2}$ " x 6 $\frac{1}{2}$ " x 7 $\frac{1}{2}$ "
 USED FD DRILL HOLE.



MISC. INFORMATION

FD RAILROAD CAR SPRING PER 1976 TIES AND
 REMOVED.

JUNE 26, 2003

SET MONUMENT BOX OVER
 STONE

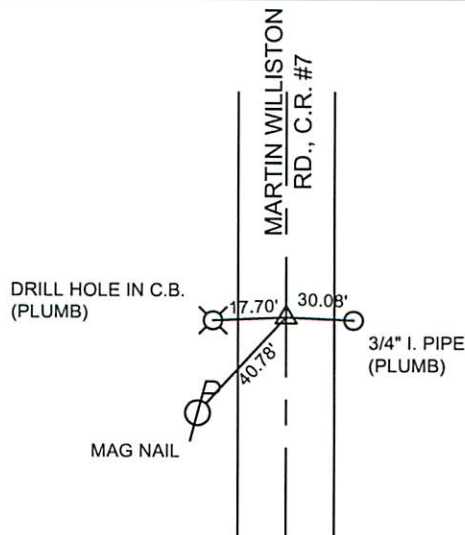

SHORT TIES
 SET P.K. NAIL N - 3.00'
 SET P.K. NAIL S - 3.00'
 SET P.K. NAIL W - 3.00'