

OTTAWA COUNTY ENGINEERS OFFICE

REFERENCE NO. 22-7-13-C
 NE CORNER POST SEC. 22
 CLAY TWP.
 SHEET 1 OF 1.

ROUTE: T-7 MARTIN-WILLISTON RD.
 TOWNSHIP: CLAY
 SECTION: 22
 T 7 NR 13 E.

PERSONNEL:
 M. WITTMAN, P.S.
 J. ALLEN

NORTHING:
 EASTING:
 DATUM:



DATE / WEATHER / TEMP:
 OCTOBER 8, 2012
 SUNNY - SW
 50° F

MONUMENT INFORMATION

MONUMENT TYPE: FD. HARDHEAD STONE W/ DH
 ON SURFACE - BELOW: 1.73'
LEFT - CL PAV'T - RIGHT: 3.70'
 IRREGULAR SHAPED STONE 8" N/S x 6" E/W



MISC. INFORMATION

FD. RAILROAD SPIKE 0.10' BELOW SURFACE TIED
 W/ X-TIES AND DUG FOR STONE. RAILROAD SPIKE
 FIT DH IN STONE.

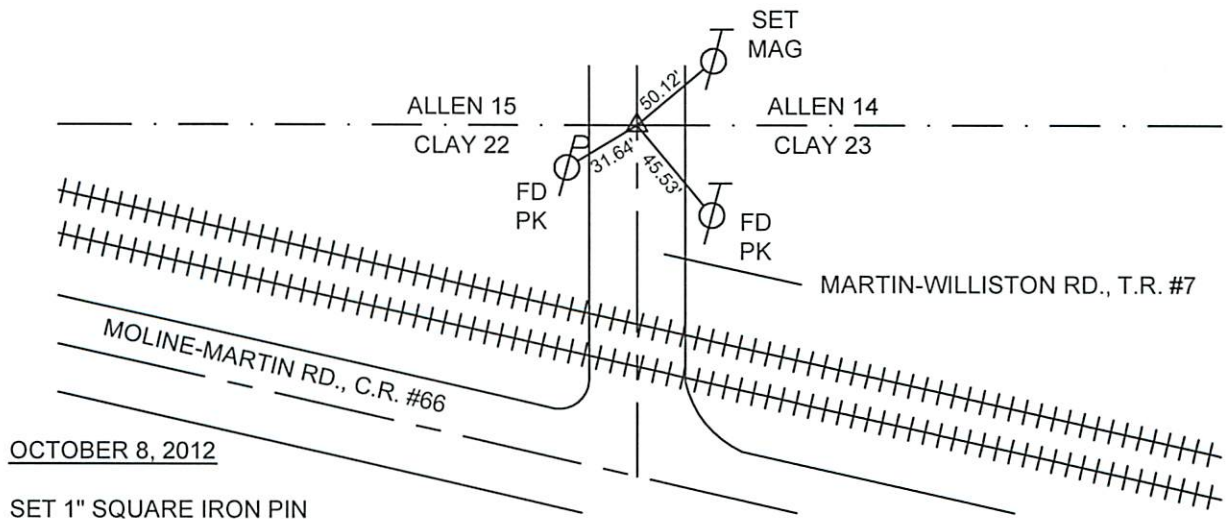

OCTOBER 8, 2012

SET 1" SQUARE IRON PIN
 IN MONUMENT BOX OVER
 STONE