

3440 ROAD (30')
SUN VALLEY CONDOMINIUMS - PHASE 2A

FIRST AMENDMENT TO DRAWINGS SUN VALLEY CONDOMINIUMS - PHASE 2A

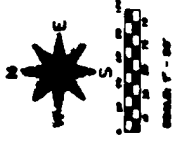

PREPARED BY THE ARCHITECT OF RECORD, CONSULTING ENGINEER AND SURVEYOR FOR THE PROJECT AND THE ARCHITECT OF RECORD, CONSULTING ENGINEER AND SURVEYOR FOR THE PROJECT.

DATE: 10.1.1997

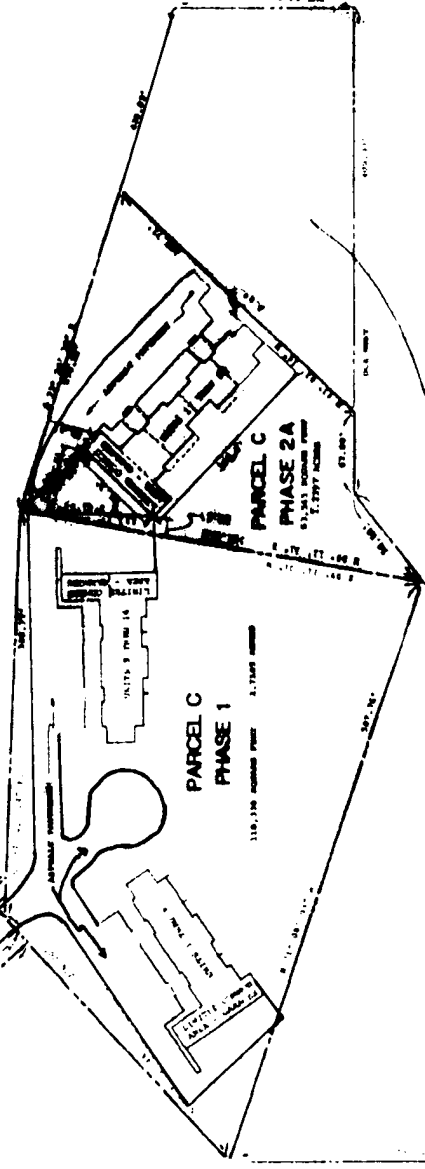

PORTAGE TWP. SEC. 24
CATAWBA COUNTY TWP. SEC. 24

THE ARCHITECT OF RECORD HAS REVIEWED THE RECORD DRAWINGS FOR THE PROJECT AND HAS FOUND THEM TO BE IN ACCORDANCE WITH THE REQUIREMENTS OF THE NORTH CAROLINA CONDOMINIUM ACT AND THE REQUIREMENTS OF THE NORTH CAROLINA CONDOMINIUM ACT.



Richard R. [Signature]
ARCHITECT OF RECORD

APPROVED FOR THE PROJECT AND THE ARCHITECT OF RECORD, CONSULTING ENGINEER AND SURVEYOR FOR THE PROJECT.

APPROVED FOR THE PROJECT AND THE ARCHITECT OF RECORD, CONSULTING ENGINEER AND SURVEYOR FOR THE PROJECT.

