

PLAT OF
ISLAND VIEW CONDOMINIUM

IN GEM BEACH-PLAT NO. 3, LOT NOS. 3, 4, 5, 6 AND

WITHIN THE SOUTH HALF OF LOT NO. 13, FIRELANDS, SECTION NO. 3

CATAWBA ISLAND TOWNSHIP, OTTAWA COUNTY, OHIO

Lake Erie

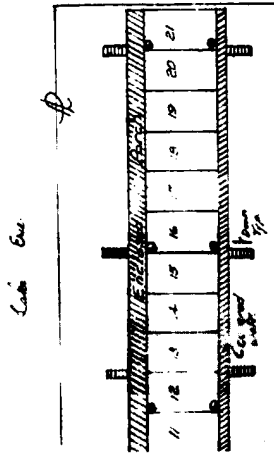
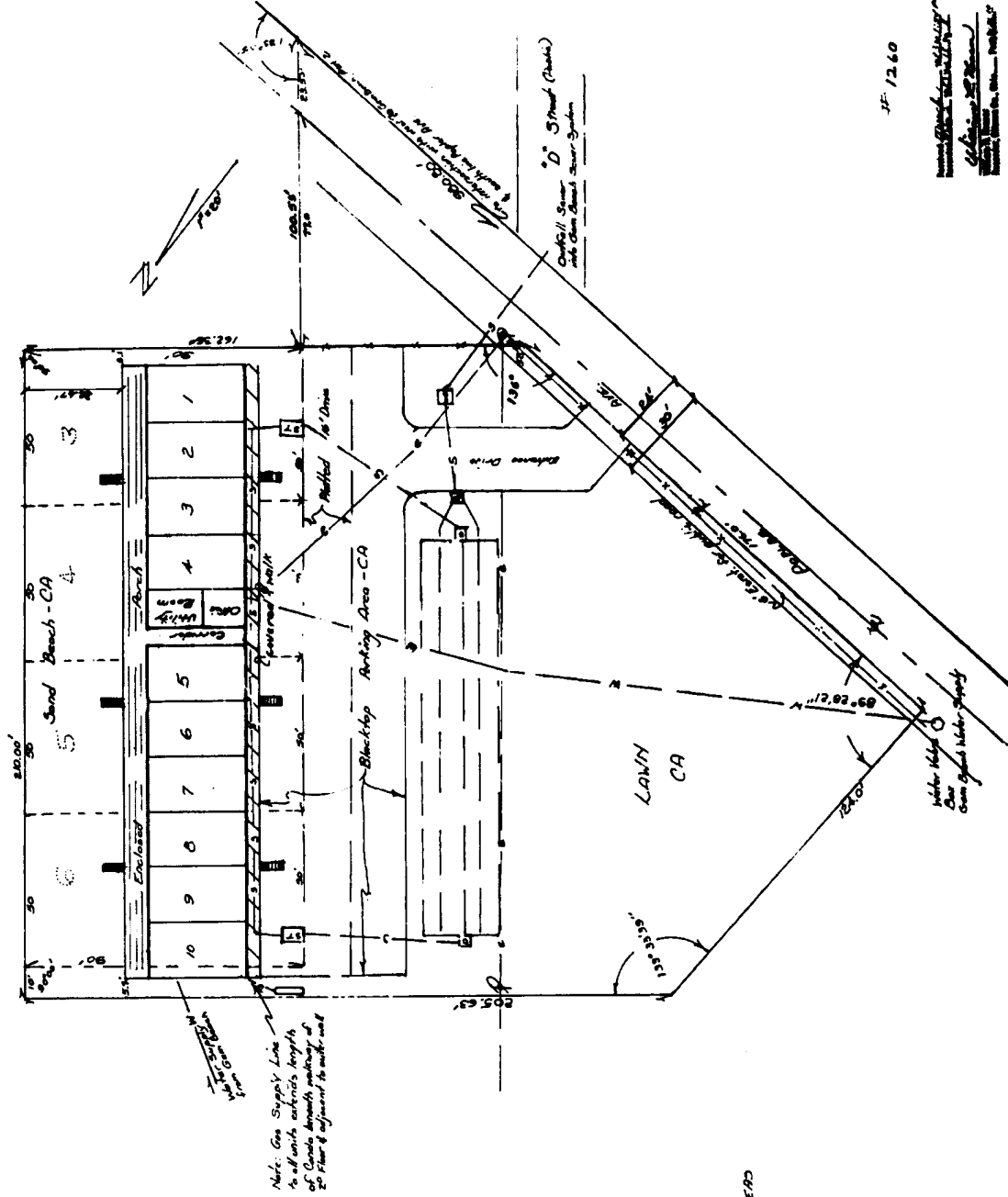

IN LAY-OUT OF COMMON AREAS & LIMITED COMMON AREAS
Scale 1" = 20'

Sheet 11 of 17

ENGINEER
GABER S.
275 MARKET STREET, CLEVELAND, OHIO 44115
PH 520-1234

LEGEND

- 1st Floor-enclosed porch
- 1st Floor-open-covered-walk
- 2nd Floor-enclosed porch
- 2nd Floor-covered walk
- Stairway with railing to 2nd floor units
- Water Lines to Condo Structure
- Sanitary Sewer
- Propane Gas (also see notation)
- Property Line
- Limited Common Area
- Common Area
- Sidewalk lines of Lot Nos. 3, 4, 5, 6 in Gem Beach, Plat No. 3, Enclosed in Plat 7, Page 13 of Olyws B, Sec 3, including between a 1/2 foot drive Lot No. (Typical)
- Septic Tank
- Distribution box in submergible sand/CA
- Collection box in submergible sand/CA
- Lift Station
-
- Submergible Sand Filter (particulate)
- Propane Gas (Supply for units)
- Chain Link Fence
- Overhead Electric Line
- Power Pole
- Security Lights on roof

I hereby certify that this set of drawings accurately shows the building or buildings to be constructed.

Richard A. Bradford
Reg. Eng. 15395
Exp. June 30, 2010

Richard A. Bradford
Reg. Eng. 15395
Exp. June 30, 2010