

# OTTAWA COUNTY ENGINEERS OFFICE

REFERENCE NO. 27-7-15-1  
SE CORNER POST SEC. 27  
CARROLL TWP.  
SHEET 1 OF 1.

PERSONNEL:  
M. WITTMAN, P.S.  
J. ALLEN

DATE / WEATHER / TEMP:  
OCTOBER 15-2010  
OVERCAST - NW  
62° F

ROUTE: C-98 SALEM - CARROLL RD.  
@ T-101 LEUTZ RD.

TOWNSHIP: CARROLL

SECTION: 27

T 7 N R 15 E.

NORTHING:

EASTING:

DATUM:

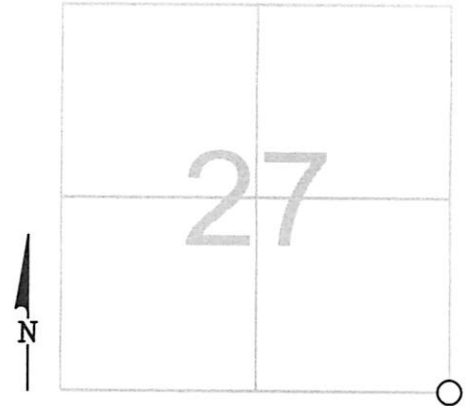

## MONUMENT INFORMATION

MONUMENT TYPE: FD. 1/2" Ø IRON PIN IN  
CONCRETE  
ON SURFACE - BELOW: 0.56'  
LEFT - CL PAV'T - RIGHT: 1.30'

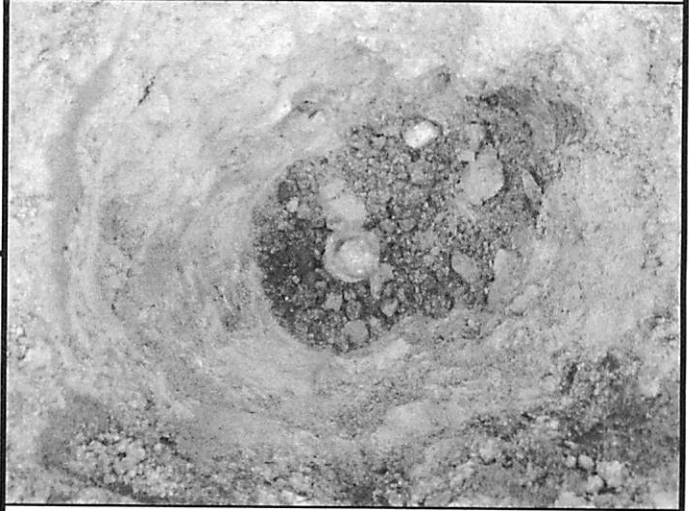

## MISC. INFORMATION

IRON PIN POSSIBLY SET BY JAMES C. ANDRUS, R.S.  
# 4838 IN JANUARY 1973 (SEE OCE SURVEY FILE  
1-12-83). IRON PIN MATCHED P.K. NAIL FOUND ON  
SURFACE. IRON PIN ALSO MATCHED DISTANCES  
NORTH AND WEST ON SURVEY BY DeWITT IN  
SURVEY RECORD BOOK 3 PAGE 345.

OCTOBER 5, 2010

SET MONUMENT BOX OVER  
IRON PIN

