

# OTTAWA COUNTY ENGINEERS OFFICE

**REFERENCE NO.** 25-7-15-C  
 NE CORNER POST SECTION 25  
 CARROLL TWP.  
**SHEET** 1 OF 1.

**ROUTE:** C-15 CAMP PERRY WESTERN RD  
 @ C-26 CARROLL - ERIE RD.

**TOWNSHIP:** CARROLL

**SECTION:** 25

**T** 7 **NR** 15 **E.**

**NORTHING:**

**EASTING:**

**DATUM:**

**PERSONNEL:**  
 R. NUHFER, P.S.  
 M. BROUGH

**DATE / WEATHER / TEMP:**  
 FEBRUARY 13, 2001  
 CLDY  
 40° F

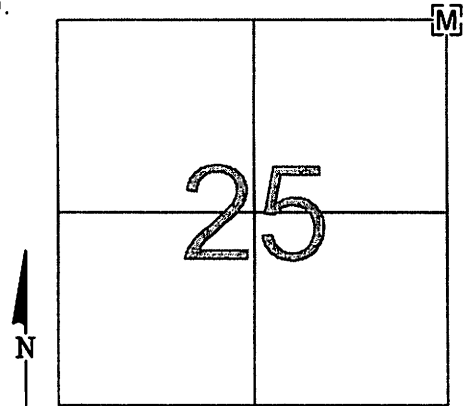

### MONUMENT INFORMATION

MONUMENT TYPE: FD 1" IRON PIN IN MON BOX  
 ON SURFACE - BELOW: 0.47'  
 LEFT - CL PAVT - RIGHT:  
  
 IRON PIN FOUND IN ROUND MON BOX

### MISC. INFORMATION

1" IRON PIN IN ROUND MONUMENT BOX SET  
 PER CAMP PERRY WESTERN ROAD, C.R. 15,  
 ROAD PLANS DATED 1942.

PHOTO OF STONE NOT AVAILABLE

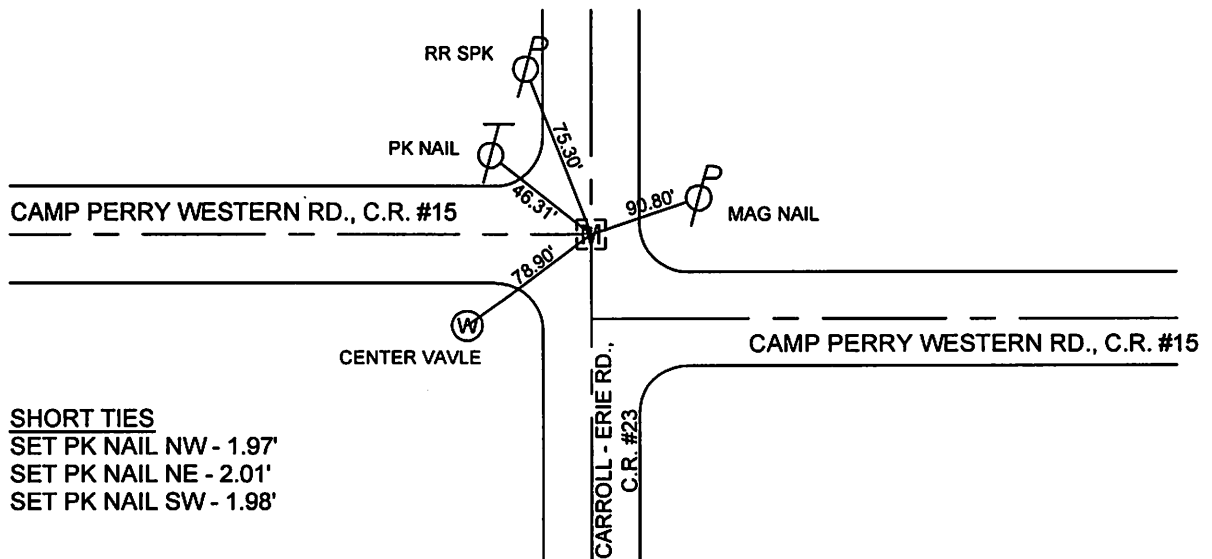

**SHORT TIES**  
 SET PK NAIL NW - 1.97'  
 SET PK NAIL NE - 2.01'  
 SET PK NAIL SW - 1.98'