

# OTTAWA COUNTY ENGINEERS OFFICE

REFERENCE NO. 22-7-15-B

NORTH QUARTER POST SEC. 22  
CARROLL TWP.

SHEET 1 OF 1.

ROUTE: T-95 FICK RD.

TOWNSHIP: CARROLL

SECTION: 22

T 7 NR 15 E.

**PERSONNEL:**

M. WITTMAN, P.S.

J. ALLEN

L. WALLACE

A. WEIRICH - BEC ASSOC.

NORTHING:

EASTING:

DATUM:

**DATE / WEATHER / TEMP:**

JANUARY 16, 2009

SUNNY S

26° F



MONUMENT INFORMATION

MONUMENT TYPE: FD LIMESTONE  
ON SURFACE - BELOW: 1.57'  
LEFT - CL PAV'T - RIGHT: 1.50'  
RECTANGULAR STONE: 6" x 4" x 3"

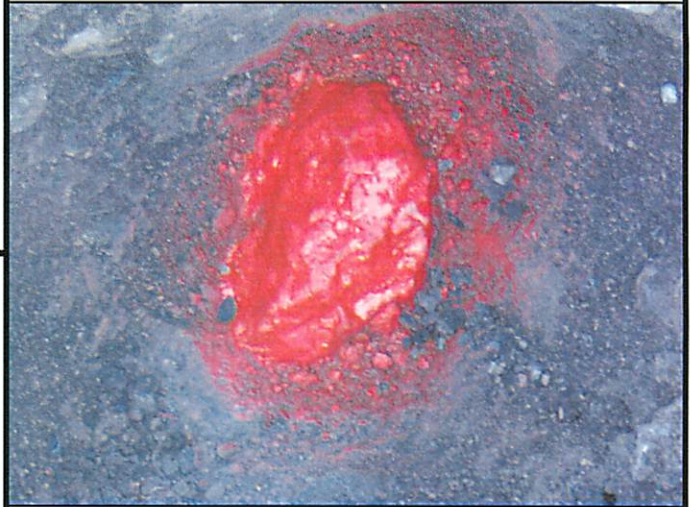

MISC. INFORMATION

SET DRILL HOLE IN TOP OF STONE IN THE  
CENTER OF AN EXISTING DEPRESSION.

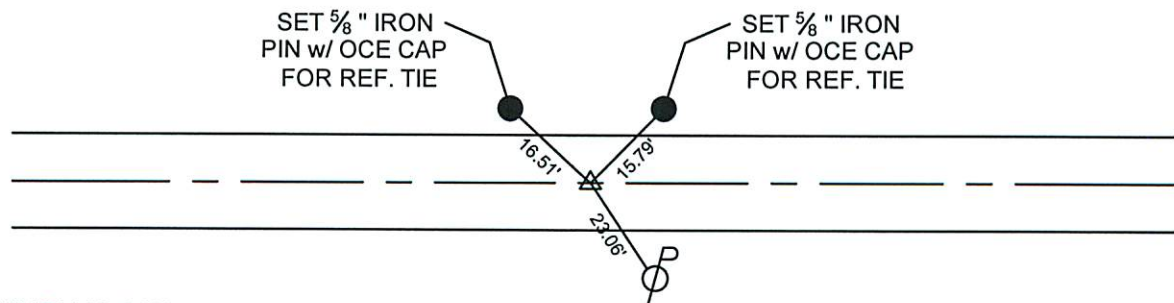

JANUARY 16, 2008

SET 1" SQUARE IRON PIN  
IN MONUMENT BOX OVER  
STONE