

# OTTAWA COUNTY ENGINEERS OFFICE

**REFERENCE NO.** 18-7-15-D  
 WEST QUARTER POST SECTION  
 18 CARROLL TWP.  
**SHEET** 1 OF 1.

**ROUTE:** C-23 BENTON-CARROLL RD.

**TOWNSHIP:** CARROLL

**SECTION:** 18

**T** 7 **NR** 15 **E.**

**PERSONNEL:**

M. WITTMAN, P.S.  
 M. SANDRETTO  
 J. DUSSEAU  
 K. LENKE

**NORTHING:**

**EASTING:**

**DATE / WEATHER / TEMP:**

MARCH 27, 2006  
 SUNNY S-SW  
 43° F

**DATUM:**

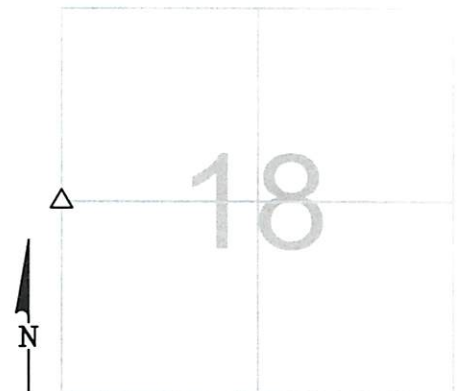

MONUMENT INFORMATION

MONUMENT TYPE: FD STONE W/ DRILL HOLE  
 ON SURFACE - BELOW: 2'- $\frac{3}{4}$ "  
LEFT - CL PAV'T - RIGHT: 3'-5"  
 RECTANGULAR STONE: 6'- $\frac{1}{2}$ " E-W x 4" N-S  
 MEASURED 2641.92' FROM SW COR. SEC. 18  
 (DEC. 1, 1897 C. DEWITT SURVEY SET STONE @  
 2642' NORTH OF SW COR.)



MISC. INFORMATION

AT SEARCH COMMENCEMENT THERE WAS A PK  
 NAIL WITH 4 X-TIES N,S,E,W. 1.5' DOWN FD  $\frac{1}{2}$ "  
 IRON PIN BENT. DUG FURTHER DOWN TO CLAY,  
 PRODDED 3.5' INTO CLAY AND FOUND NOTHING.  
 FD STONE WAS 1.70' S OF PK AND IRON PIN.

**THIS IS A CLOSING CORNER**

MARCH 27, 2006

SET 1" SQUARE IRON PIN  
 IN MONUMENT BOX OVER  
 STONE

