

OTTAWA COUNTY ENGINEERS OFFICE

REFERENCE NO. 16-7-15-F
EAST QUARTER POST SEC. 16
CARROLL TWP.
SHEET 1 OF 1.

ROUTE: C-93 TOUSSAINT EAST RD.
@ T-102 BEHLMAN RD.

TOWNSHIP: CARROLL

SECTION: 16

T 7 NR 15 E.

NORTHING:

EASTING:

DATUM:

PERSONNEL:
M. WITTMAN, P.S.
J. ALLEN

DATE / WEATHER / TEMP:
OCTOBER 15, 2010
PTLY SUNNY - W - NW
58° F

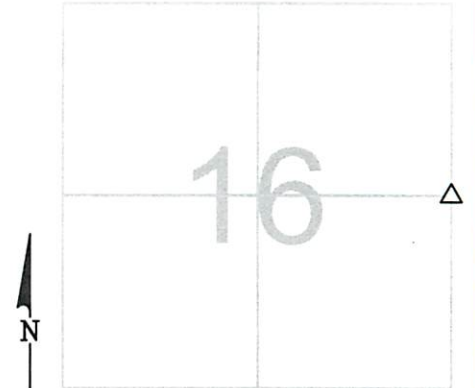

MONUMENT INFORMATION

MONUMENT TYPE: FD. 5"x9" LIMESTONE (FOOTBALL SHAPED)
ON SURFACE - BELOW: 1.55'
LEFT - CL PAV'T - RIGHT: 2.75'

USED HIGH SPOT ON CENTER OF STONE.



MISC. INFORMATION

FD. 3/4" Ø IRON PIN 0.31' BELOW SURFACE, TIED WITH X-TIES AND DUG FOR STONE. LIMESTONE IS BROKEN OFF ON NORTH AND SOUTH SIDES. IRON PIN FOUND WAS 0.07'E AND 0.02'S OF HIGH SPOT.

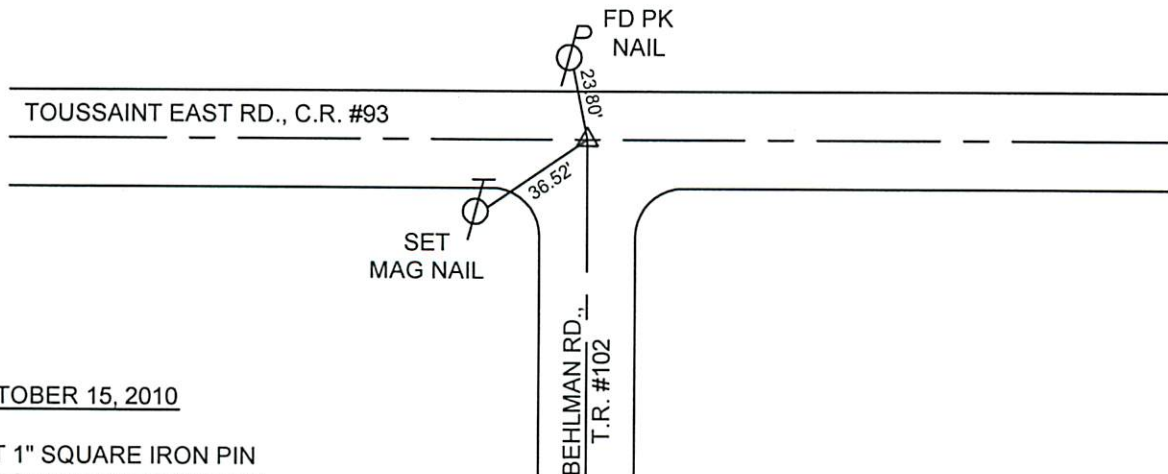

OCTOBER 15, 2010

SET 1" SQUARE IRON PIN
IN MONUMENT BOX OVER
STONE