

# OTTAWA COUNTY ENGINEERS OFFICE

REFERENCE NO. 15-7-15-H  
SOUTH QUARTER POST SEC. 15  
CARROLL TWP.  
SHEET 1 OF 1.

ROUTE: T-95 FICK RD.  
TOWNSHIP: CARROLL  
SECTION: 15  
T 7 NR 15 E.

PERSONNEL:  
M. WITTMAN, P.S.  
J. ALLEN  
L. WALLACE  
A. WEIRICH - BEC ASSOC.

NORTHING:  
EASTING:  
DATUM:

DATE / WEATHER / TEMP:  
JANUARY 16, 2009  
SUNNY S  
26° F



## MONUMENT INFORMATION

MONUMENT TYPE: FD LIMESTONE  
ON SURFACE - BELOW: 1.57'  
LEFT - CL PAV'T - RIGHT: 1.50'  
RECTANGULAR STONE: 6" x 4" x 3"



## MISC. INFORMATION

SET DRILL HOLE IN TOP OF STONE IN THE  
CENTER OF AN EXISTING DEPRESSION.

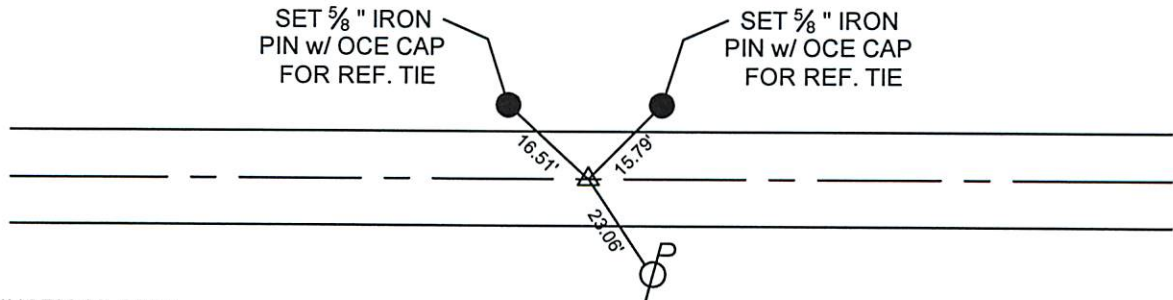

JANUARY 16, 2008

SET 1" SQUARE IRON PIN  
IN MONUMENT BOX OVER  
STONE