

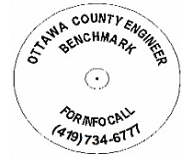

OTTAWA COUNTY BENCHMARK DATA SHEET



CAR 19-0.0

Township	Section	Town	Range	Type of Monument
CARROLL	29	T7N	R15E	3 1/4" Domed Bronze Disk in Concrete (OCE Spec. BM-1)
Set By	Shot By	Calculated	Calculated By	Published
OCE / OCHD	J. Allen	March 8, 2012	M. J. Wittman, P.S.	March 16, 2012

Location

North side of Salem-Carroll Rd., C.R. #98 west of State Route #19

Vertical Control		
Vertical Datum	Method	Elevation (U.S. Survey Feet)
NAVD 88	GPS	588.71

Horizontal Control			
Horizontal Datum	Zone	Northing	Easting
NAD 83 CORS 96	OHIO NORTH 3401	679,828.026	1,791,753.173
Method	Latitude	Longitude	
GPS / CORPSCON	41° 31' 51.02327" N	83° 08' 43.94469" W	
Geoid	Scale Factor	Convergence	
GEOID 09	0.999971763	- 00° 25' 26.71619"	

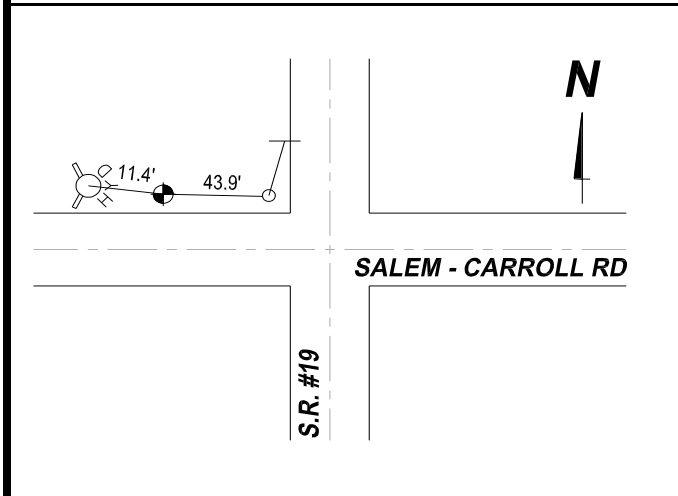

NOTES:

1. Monument set: July 6, 2011
2. Data Collected: 2-2-12, 2-10-12, 2-27-12