

OTTAWA COUNTY ENGINEERS OFFICE

REFERENCE NO. 8-7-14-G
 SW CORNER POST SECTION 8
 BENTON TWP.
SHEET 1 OF 1.

ROUTE: C-208 ELLISTON-TROWBRIDGE RD.
 @ T-67 TROWBRIDGE RD.

TOWNSHIP: BENTON

SECTION: 8

T 7 **NR** 14 **E.**

NORTHING:

EASTING:

DATUM:

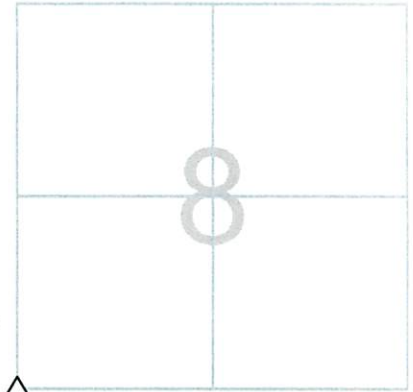

PERSONNEL:

R. NUHFER, P.S.
 M. BROUGH
 K. MOORE
 R. LAJTI
 N. SANTOYA

DATE / WEATHER / TEMP:

JULY 11, 2002
 SUNNY
 78° F

MONUMENT INFORMATION

MONUMENT TYPE: FD BLACK GRANITE STONE
 ON SURFACE - BELOW: 1.25'
 LEFT - CL PAV'T - RIGHT:
 RECTANGULAR STONE: 5" x 12"

 SET 3/8" DRILL HOLE IN CENTER OF STONE



MISC. INFORMATION

FOUND 2" IRON PIPE OVER PIN 4" BELOW
 SURFACE - REMOVED

JULY 22, 2002

SET MONUMENT BOX OVER
 STONE

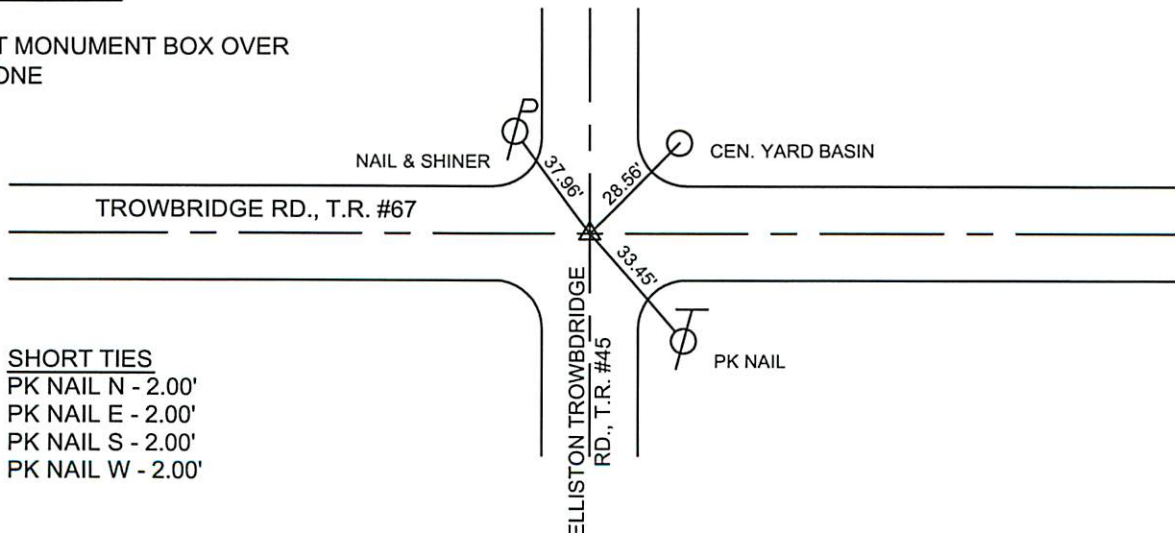

SHORT TIES
 PK NAIL N - 2.00'
 PK NAIL E - 2.00'
 PK NAIL S - 2.00'
 PK NAIL W - 2.00'