

OTTAWA COUNTY ENGINEERS OFFICE

REFERENCE NO. 7-7-14-D
 WEST QUARTER POST SEC. 7
 BENTON TWP.
 SHEET 1 OF 1.

ROUTE: C-213 NISSEN RD.
 TOWNSHIP: BENTON
 SECTION: 7
 T 7 NR 14 E.

PERSONNEL:
 M. WITTMAN, P.S.
 J. ALLEN

NORTHING:
 EASTING:
 DATUM:

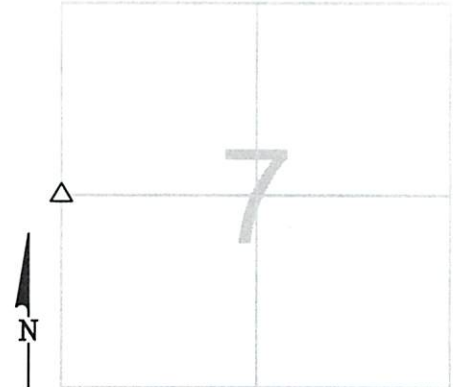

DATE / WEATHER / TEMP:
 NOVEMBER 9, 2009
 SUNNY - SW
 59° F

MONUMENT INFORMATION

MONUMENT TYPE: FD. 6"x10" POINTED LIMESTONE
 ON SURFACE - BELOW: 0.77'
 LEFT - CL PAV'T - RIGHT: 12.00'
 SET DRILL HOLE ON HIGH POINT OF STONE.



MISC. INFORMATION

STONE IS 2.5' EAST OF THE EAST EDGE OF PAVEMENT.

NOVEMBER 9, 2009

SET MONUMENT BOX
 OVER STONE

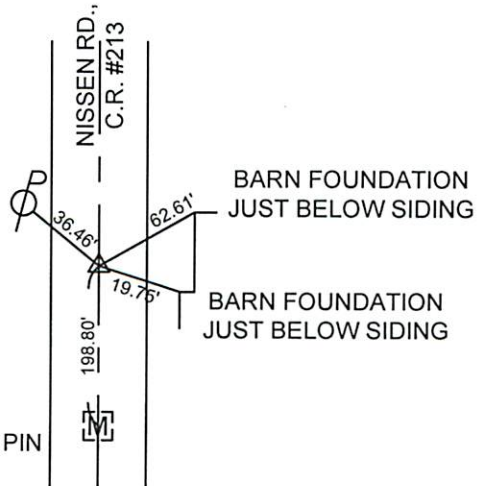

FD. 1" SQ. IRON PIN
 IN MON.BOX
 E 1/4 POST
 ALLEN SEC. 12