

OTTAWA COUNTY ENGINEERS OFFICE

REFERENCE NO. 35-7-14-F
EAST QUARTER POST SEC. 35
BENTON TWP.
SHEET 1 OF 1.

ROUTE: T-22 LICKERT- HARDER RD.
@ T- 79 KOLB RD.

TOWNSHIP: BENTON

SECTION: 35

T 7 NR 14 E.

NORTHING:

EASTING:

DATUM:

PERSONNEL:

M. WITTMAN, P.S.
J. ALLEN
S. ULLRICH
M. ULLRICH

DATE / WEATHER / TEMP:

JUNE 26, 2008
SUNNY S-SW
87° F



MONUMENT INFORMATION

MONUMENT TYPE: FD HARDHEAD STONE
ON SURFACE - BELOW: 1.42'
LEFT - CL PAV'T - RIGHT: 8.35'

RECTANGULAR STONE: 6" x 8"



MISC. INFORMATION

FD. NAIL AND SHINER ON SURFACE W/10 PENNY
NAIL TIES 3.72' E AND 2.75' W. NAIL AND SHINER
WAS 0.92' N AND 0.09' W OF CENTER OF STONE.

SET DRILL HOLE IN CENTER OF STONE AND
USED.

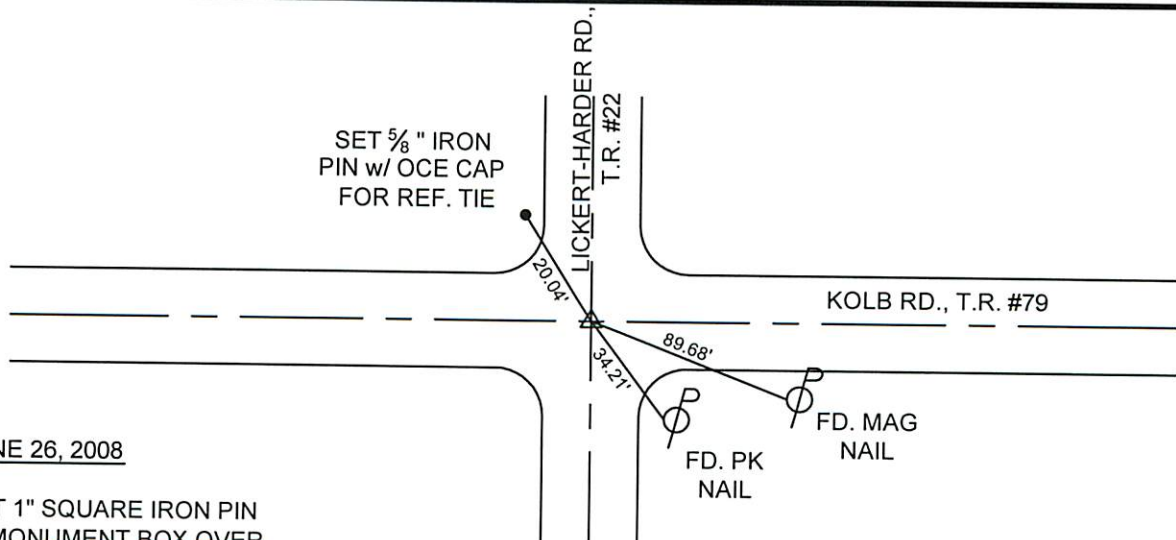

JUNE 26, 2008

SET 1" SQUARE IRON PIN
IN MONUMENT BOX OVER
STONE