

OTTAWA COUNTY ENGINEERS OFFICE

REFERENCE NO. 30-8-14-G
 SW CORNER POST SECTION 30
 BENTON TWP.
 SHEET 1 OF 1.

ROUTE: C-213 NISSEN RD.
 TOWNSHIP: BENTON
 SECTION: 30
 T 8 NR 14 E.

PERSONNEL:
 M. WITTMAN, P.S.
 J. ALLEN

NORTHING:
 EASTING:
 DATUM:

DATE / WEATHER / TEMP:
 JULY 25, 2014
 SUNNY
 74° F

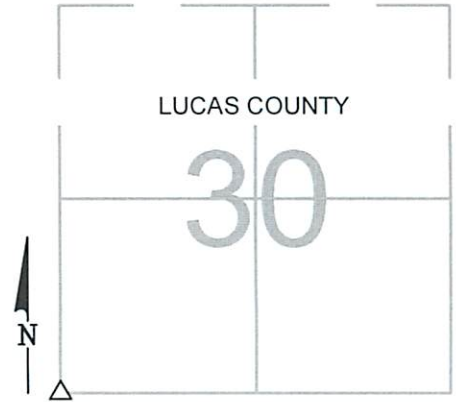

MONUMENT INFORMATION

MONUMENT TYPE: FD 9" X 6" LIMESTONE W/ DH
 ON SURFACE - BELOW: 1.94'
LEFT - CL PAV'T - RIGHT: 7.80'
 USED DH IN STONE.



MISC. INFORMATION

FD. RR SPK 0.42' BELOW SURFACE, TIED W/ X-TIES
 AND DUG FOR STONE.
 RR SPK WAS 0.10' WEST AND 0.04' SOUTH OF DH IN
 STONE.

THIS IS A CLOSING CORNER.

JULY 25, 2014

SET 1" SQUARE IRON PIN
 IN MONUMENT BOX OVER
 STONE

