

# OTTAWA COUNTY ENGINEERS OFFICE

REFERENCE NO. 30-8-14-A  
NW CORNER POST SEC. 30  
BENTON TWP.  
SHEET 1 OF 1.

PERSONNEL:  
M. WITTMAN, P.S.  
J. ALLEN

DATE / WEATHER / TEMP:  
SEPTEMBER 7, 2012  
OVERCAST - NW  
80° F

ROUTE: C-213 NISSEN RD.  
@ OTTAWA - LUCAS CO. LINE

TOWNSHIP: BENTON

SECTION: 30

T 8 NR 14 E.

NORTHING:

EASTING:

DATUM:

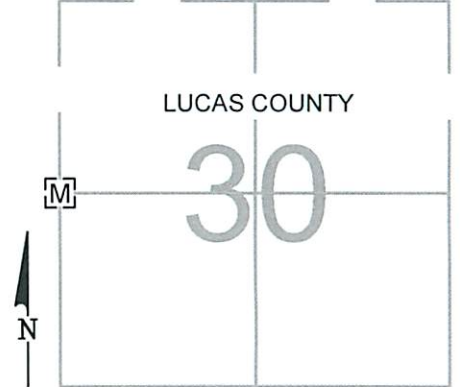

## MONUMENT INFORMATION

MONUMENT TYPE: FD. STONE IN MON BOX  
ON SURFACE - BELOW: 1.13' (STONE)  
LEFT - CL PAV'T - RIGHT: 1.25'

POINTED LIMESTONE 7"x5-1/2" WITH DH



## MISC. INFORMATION

