

OTTAWA COUNTY ENGINEERS OFFICE

REFERENCE NO. 28-8-14-J
 N 1/4 POST NORTHWEST 1/4 SEC. 28
 BENTON TWP.
SHEET 1 OF 1.

ROUTE: T-3 OTTAWA - LUCAS RD.

TOWNSHIP: BENTON

SECTION: 28

T 8 **NR** 14 **E.**

PERSONNEL:
 M. WITTMAN, P.S.
 J. ALLEN

NORTHING:

EASTING:

DATE / WEATHER / TEMP:

MAY 6, 2016
 SUNNY - N
 72° F

DATUM:

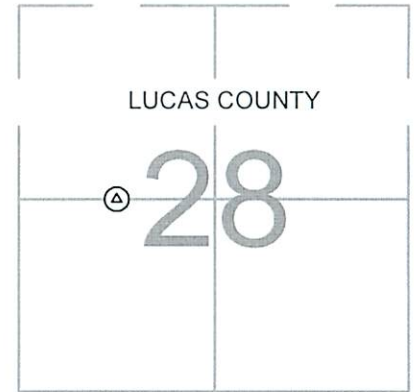

MONUMENT INFORMATION

MONUMENT TYPE: FD. 2-1/2" Ø BRASS DISK
 ON SURFACE - BELOW: 0.56'
 LEFT - CL PAV'T - RIGHT: 1.00'

 BRASS DISK IN 6" SQUARE CONCRETE MONUMENT.

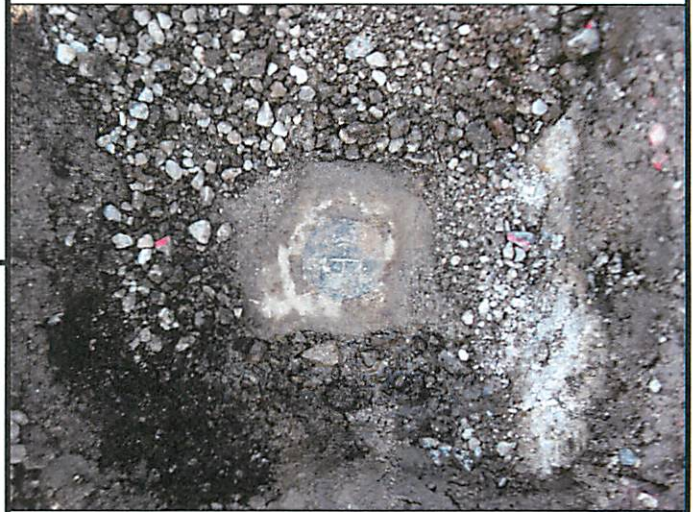

MISC. INFORMATION

MAY 6, 2016

SET MONUMENT BOX OVER
 CONCRETE MONUMENT

