

OTTAWA COUNTY ENGINEERS OFFICE

REFERENCE NO. 21-7-14-B
NORTH QUARTER POST SEC. 21
BENTON TWP.
SHEET 1 OF 1.

ROUTE: T-66 MOLINE MARTIN RD. @
T-20 SUHRBIER RD.

TOWNSHIP: BENTON

SECTION: 21

T 7 NR 14 E.

NORTHING:

EASTING:

DATUM:

PERSONNEL:
M. WITTMAN, P.S.
M. BROUGH
R. STONER

DATE / WEATHER / TEMP:
JULY 16, 2003
SUNNY
85° F



MONUMENT INFORMATION

MONUMENT TYPE: FD POINTED LIMESTONE
ON SURFACE - BELOW: 1.45'
LEFT - CL PAV'T - RIGHT:
RECTANGULAR STONE: 9" x 9"

USED FD DRILL HOLE IN STONE.



MISC. INFORMATION

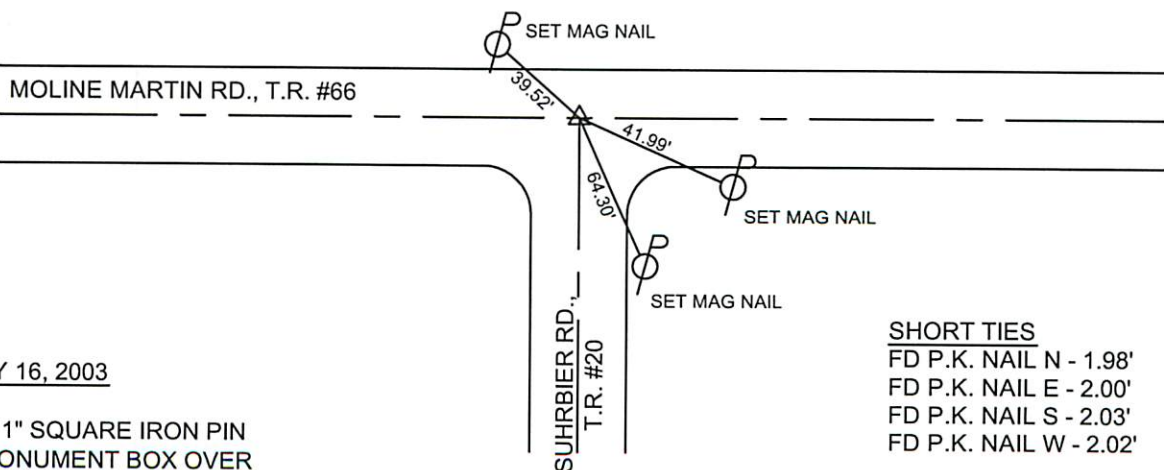

JULY 16, 2003

SET 1" SQUARE IRON PIN
IN MONUMENT BOX OVER
STONE

SHORT TIES

FD P.K. NAIL N - 1.98'
FD P.K. NAIL E - 2.00'
FD P.K. NAIL S - 2.03'
FD P.K. NAIL W - 2.02'