

# OTTAWA COUNTY ENGINEERS OFFICE

**REFERENCE NO.** 19-7-14-C  
 NE CORNER POST SECTION 19  
 BENTON TWP.  
**SHEET** 1 OF 1.

**ROUTE:** C-208 ELLISTON-TROWBRIDGE RD.  
 @ T-66 MOLINE MARTIN RD.

**TOWNSHIP:** BENTON

**SECTION:** 19

T 7 NR 14 E.

**NORTHING:**

**EASTING:**

**DATUM:**



**PERSONNEL:**

- R. NUHFER, P.S.
- M. BROUGH
- K. MOORE
- R. LAJTI
- N. SANTOYA

**DATE / WEATHER / TEMP:**

JULY 11, 2002  
 SUNNY  
 78° F

MONUMENT INFORMATION

MONUMENT TYPE: FD LIMESTONE  
 ON SURFACE - BELOW: 1.08'  
 LEFT - CL PAVT - RIGHT:  
 RECTANGULAR STONE: 21/2" x 5" (TOP)

USED FD DRILL HOLE

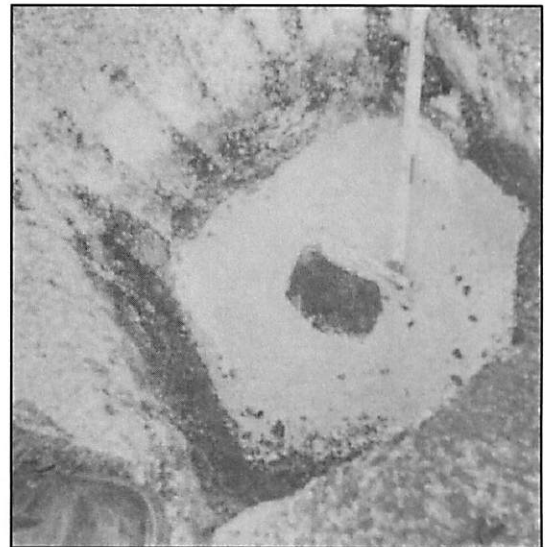

MISC. INFORMATION

JULY 22, 2002

SET MONUMENT BOX OVER  
 STONE

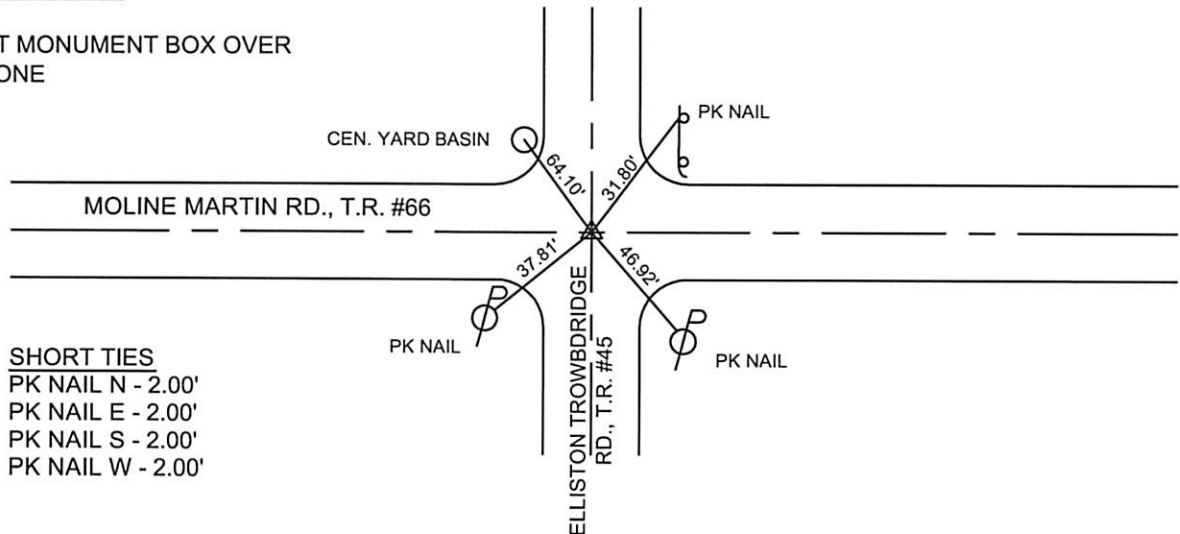

SHORT TIES  
 PK NAIL N - 2.00'  
 PK NAIL E - 2.00'  
 PK NAIL S - 2.00'  
 PK NAIL W - 2.00'