

OTTAWA COUNTY ENGINEERS OFFICE

REFERENCE NO. 18-7-14-1
SE CORNER POST SECTION 18
BENTON TWP.
SHEET 1 OF 1.

ROUTE: C-208 ELLISTON-TROWBRIDGE RD.
@ T-66 MOLINE MARTIN RD.

TOWNSHIP: BENTON

SECTION: 18

T 7 NR 14 E.

NORTHING:

EASTING:

DATUM:

PERSONNEL:

R. NUHFER, P.S.
M. BROUGH
K. MOORE
R. LAJTI
N. SANTOYA

DATE / WEATHER / TEMP:

JULY 11, 2002
SUNNY
78° F



MONUMENT INFORMATION

MONUMENT TYPE: FD LIMESTONE
ON SURFACE - BELOW: 1.08'
LEFT - CL PAV'T - RIGHT:
RECTANGULAR STONE: 21/2" x 5" (TOP)

USED FD DRILL HOLE

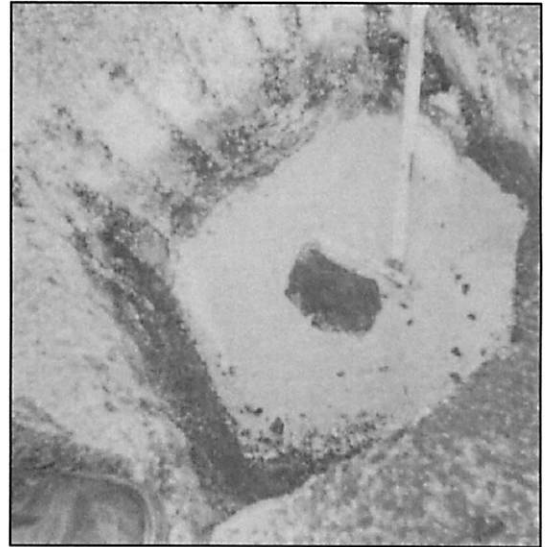

MISC. INFORMATION

JULY 22, 2002

SET MONUMENT BOX OVER
STONE

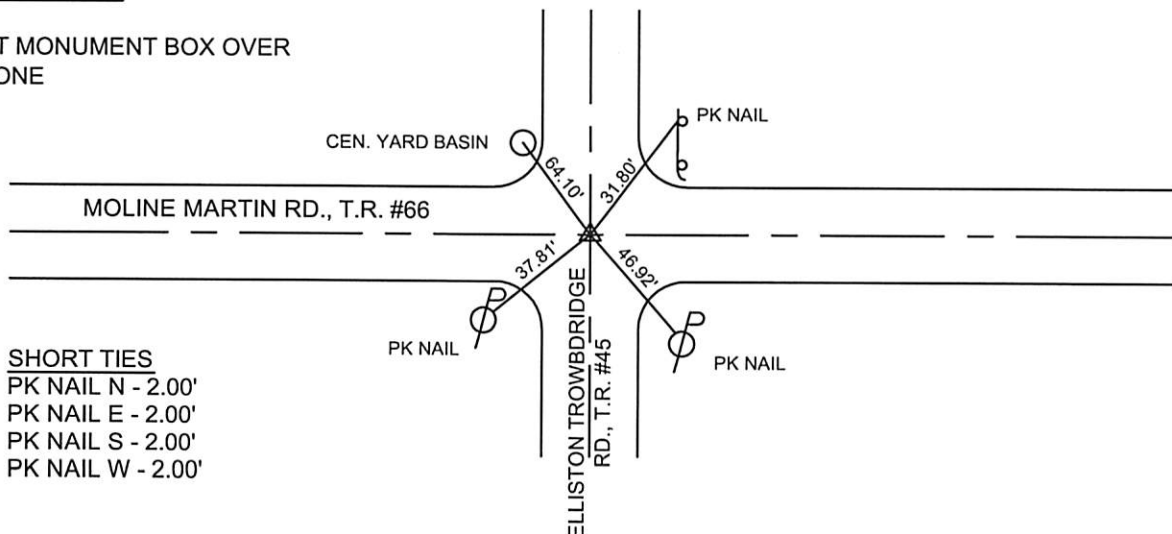

SHORT TIES

PK NAIL N - 2.00'
PK NAIL E - 2.00'
PK NAIL S - 2.00'
PK NAIL W - 2.00'