

OTTAWA COUNTY ENGINEERS OFFICE

REFERENCE NO. 13-7-14-C
NORTHEAST CORNER SEC 13
BENTON TWP.
SHEET 1 OF 1.

ROUTE: C-23 BENTON-CARROLL RD.

TOWNSHIP: BENTON

SECTION: 13

T 7 N R 14 E.

PERSONNEL:
M. WITTMAN, P.S.
J. ALLEN
C. MILLER

NORTHING:

EASTING:

DATUM:

DATE / WEATHER / TEMP:

JUNE 5, 2009
SUNNY N
70° F



MONUMENT INFORMATION

MONUMENT TYPE: FD HARDHEAD STONE
ON SURFACE - BELOW: 1.23'
LEFT - CL PAV'T - RIGHT: 0.60'
RECTANGULAR STONE: 5" x 7"

USED CENTER OF STONE



MISC. INFORMATION

FD. 1 1/2" Ø IRON PIN 0.25' BELOW SURFACE.
TIED WITH CROSS TIES AND DUG FOR STONE.
FD. IRON PIN WAS 10" LONG, 0.13' NORTH AND
0.02' EAST OF CENTER OF STONE.

JUNE 5, 2009

SET 1" SQUARE IRON PIN
IN MONUMENT BOX OVER
STONE

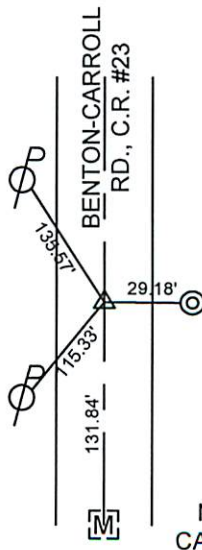

NW CORNER
CARROLL SEC 18