

OTTAWA COUNTY ENGINEERS OFFICE

REFERENCE NO. 11-6-16-H
S QUARTER POST SECTION 11
BAY TWP.
SHEET 1 OF 1.

ROUTE: T-117 HYDE RD.

TOWNSHIP: BAY

SECTION: 11

T 6 NR 16 E.

PERSONNEL:

M. WITTMAN, P.S.
J.D. BARNES

NORTHING:

EASTING:

DATE / WEATHER / TEMP:

APRIL 22, 2007
SUNNY S
74° F

DATUM:

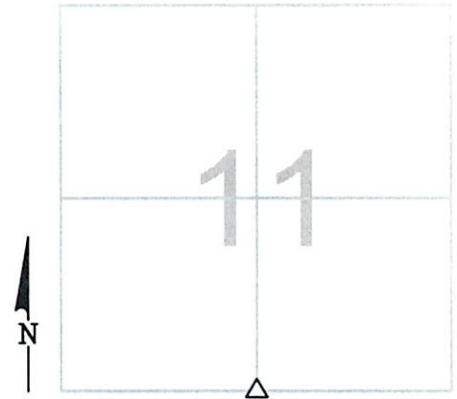

MONUMENT INFORMATION

MONUMENT TYPE: FD STONE
ON SURFACE - BELOW: 1.29'
LEFT - CL PAV'T - RIGHT: 18.50'

RECTANGULAR SANDSTONE: 4- $\frac{1}{2}$ " x 11" W/ DRILL HOLE, HAS A SLANTED 1" SQ. IRON PIN NEXT TO IT



MISC. INFORMATION

MAG NAIL
PO PO #35FD-4-3

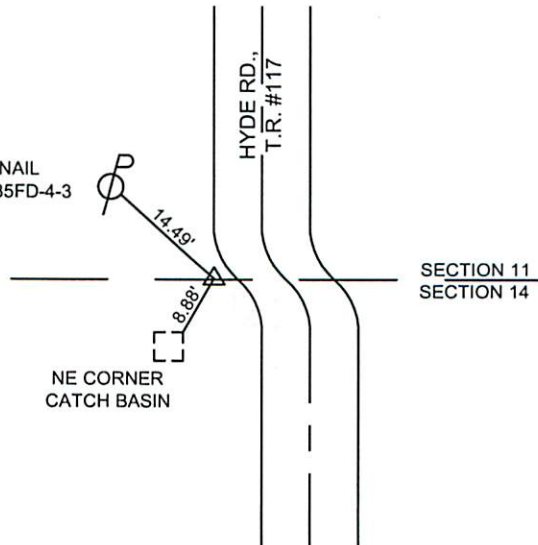

APRIL 22, 2007
ALSO SET ORANGE WITNESS
POST 2.00 WEST OF STONE