

OTTAWA COUNTY ENGINEERS OFFICE

REFERENCE NO. 30-8-13-H
SOUTH QUARTER POST SEC. 30
ALLEN TWP.
SHEET 1 OF 1.

ROUTE: T-70 CURTICE E & W RD.

TOWNSHIP: ALLEN

SECTION: 30

T 8 NR 13 E.

PERSONNEL:

M. WITTMAN, P.S.
J. ALLEN
M. ULLRICH
S. ULLRICH

NORTHING:

EASTING:

DATUM:

DATE / WEATHER / TEMP:

SEPTEMBER 8, 2008
SUNNY
76° F

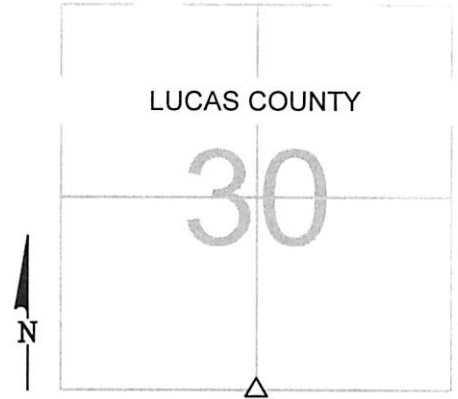

MONUMENT INFORMATION

MONUMENT TYPE: FD 6" X 9" STONE W/ DRILL HOLE
ON SURFACE - BELOW: 1.44'
LEFT - CL PAV'T - RIGHT: 2.80'



MISC. INFORMATION

SEPTEMBER 8, 2008

SET 1" SQUARE IRON PIN
IN MONUMENT BOX OVER
STONE

