

OTTAWA COUNTY ENGINEERS OFFICE

REFERENCE NO. 28-8-13-G
SW CORNER POST SECTION 28
ALLEN TWP.
SHEET 1 OF 1.

ROUTE: T-70 CURTICE E-W RD. AT
T-53 REIMAN RD.

TOWNSHIP: ALLEN

SECTION: 28

T 8 N R 13 E.

NORTHING:

EASTING:

DATUM:

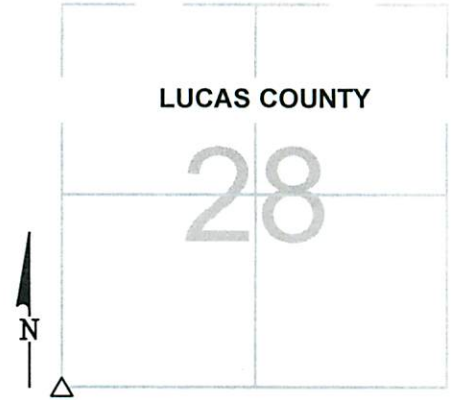

PERSONNEL:
M. WITTMAN, P.S.
J. ALLEN
K. SMITH
S. ULLRICH

DATE / WEATHER / TEMP:
JULY 13, 2007
SUNNY W-NW
77° F

MONUMENT INFORMATION

MONUMENT TYPE: FD STONE W/ DRILL HOLE
ON SURFACE - BELOW: 0.61'
LEFT - CL PAV'T - RIGHT: 2.0'

ROUND TOP GRANITE STONE 7" X 8"



MISC. INFORMATION

STONE TOO SHALLOW FOR A PIN

ENHANCED DRILL HOLE

