

OTTAWA COUNTY ENGINEERS OFFICE

REFERENCE NO. 26-8-13-G
SW CORNER POST SEC. 26
ALLEN TWP.
SHEET 1 OF 1.

PERSONNEL:
M. WITTMAN, P.S.
J. ALLEN
J. RACE
K. TOMOR

DATE / WEATHER / TEMP:
MAY 31, 2023
SUNNY - HOT - NE
90° F

ROUTE: T-7 MARTIN-WILLISTON RD.
@ T-70 CURTICE E/W RD.

TOWNSHIP: ALLEN

SECTION: 26

T 8 NR 13 E.

NORTHING:

EASTING:

DATUM:

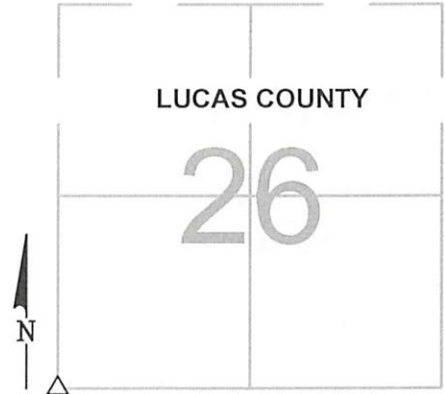

MONUMENT INFORMATION

MONUMENT TYPE: FD 5" x 6" x 3" STONE
ON SURFACE - BELOW: 1.76'
LEFT - CL PAV'T - RIGHT: 4.45' MARTIN-WILLISTON
LEFT - CL PAV'T - RIGHT: 2.70' CURTICE E/W

TRIANGULAR STONE - USED CENTER OF STONE



MISC. INFORMATION

FD PK NAIL 0.34' BELOW SURFACE, SHOT WITH
GPS AND DUG FOR STONE. PK NAIL WAS 0.03'
EAST AND 0.02' NORTH OF CENTER OF STONE.

MAY 31, 2023

SET 1" SQUARE IRON PIN
IN MONUMENT BOX OVER
STONE

