

OTTAWA COUNTY ENGINEERS OFFICE

REFERENCE NO. 26-8-13-A
 NW CORNER POST SEC. 26
 ALLEN TWP.
 SHEET 1 OF 1.

PERSONNEL:
 M. WITTMAN, P.S.
 J. ALLEN
 J. TIMMONS

DATE / WEATHER / TEMP:
 MAY 25, 2016
 SUNNY
 82° F - HUMID

ROUTE: T-7 MARTIN WILLISTON RD.

TOWNSHIP: ALLEN

SECTION: 26

T 8 NR 13 E.

NORTHING:

EASTING:

DATUM:

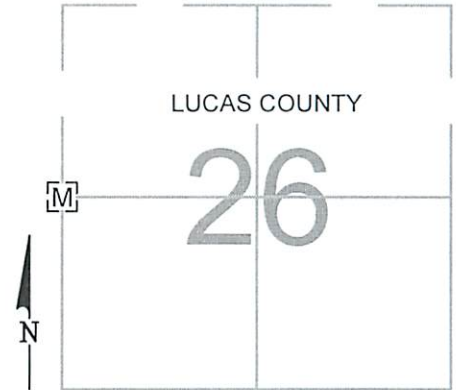

MONUMENT INFORMATION

MONUMENT TYPE: FD. 1-1/2" Ø SQ. HEAD BOLT
ON SURFACE - BELOW:
LEFT - CL PAV'T - RIGHT: 0.70'
 FD. IN LUCAS COUNTY MONUMENT BOX.



MISC. INFORMATION

JULY 18, 2016

SET 1" SQUARE IRON PIN IN
 MONUMENT BOX OVER STONE.

