

# OTTAWA COUNTY ENGINEERS OFFICE

**REFERENCE NO.** 25-8-13-G  
 SW CORNER POST SEC. 25  
 ALLEN TWP.  
**SHEET** 1 OF 1.

**ROUTE:** T-70 CURTICE EAST AND WEST RD.  
 @ T-214 OPFER-LENTZ RD.

**TOWNSHIP:** ALLEN

**SECTION:** 25

**T** 8 **NR** 13 **E.**

**NORTHING:**

**EASTING:**

**DATUM:**

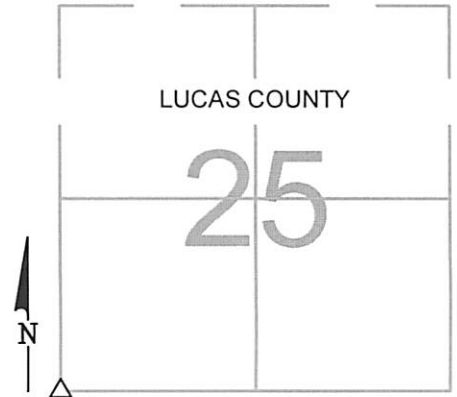

**PERSONNEL:**  
 M. WITTMAN, P.S.  
 J. ALLEN  
 C. MILLER

**DATE / WEATHER / TEMP:**  
 APRIL 26, 2013  
 SUNNY - SW  
 57° F

### MONUMENT INFORMATION

MONUMENT TYPE: FD 5" x 9" HARDHEAD STONE  
 ON SURFACE - BELOW: 1.70'  
LEFT - CL PAV'T - RIGHT: 5.60' (T.R. 214)  
 4.00' R (T.R. 70)

STONE IS 5" N/S AND 9" E/W  
 USED DRILL HOLE FOUND IN STONE



### MISC. INFORMATION

FD 5/8" HEX HEAD BOLT 0.11' BELOW SURFACE,  
 TIED W/ X-TIES AND DUG FOR STONE. HEX HEAD  
 BOLT WAS DRIVEN INTO A 7/8" O.D. PIPE.

BOLT WAS 0.20' WEST AND 0.09' NORTH OF  
 DRILL HOLE IN STONE.

MARCH 26, 2013

SET 1" SQUARE IRON PIN  
 IN MONUMENT BOX OVER  
 STONE

