

OTTAWA COUNTY ENGINEERS OFFICE

REFERENCE NO. 17-7-13-I
SOUTHEAST CORNER SEC. 17
ALLEN TWP.
SHEET 1 OF 1.

ROUTE: C-66 MOLINE-MARTIN RD. @
T- 53 REIMAN RD.

TOWNSHIP: ALLEN

SECTION: 17

T 7 NR 13 E.

PERSONNEL:

M. WITTMAN, P.S.
J. ALLEN
E.KOCH, C.MILLER
T. RAHM, D. BROUGH - GARAGE

NORTHING:

EASTING:

DATUM:

DATE / WEATHER / TEMP:

JULY 13, 2009
SUNNY W
70° F

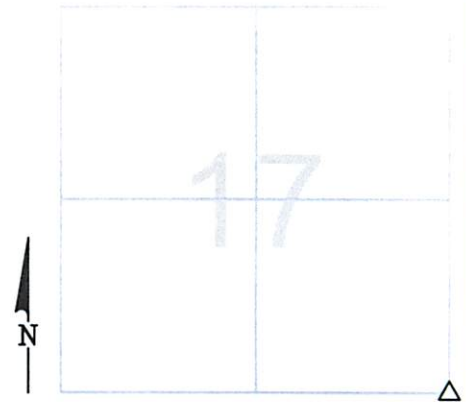

MONUMENT INFORMATION

MONUMENT TYPE: FD LIMESTONE
ON SURFACE - BELOW: 2.32'
LEFT - CL PAV'T - RIGHT: 3.00'
TRIANGULAR STONE: 9" x 9"

USED CENTER OF STONE.



MISC. INFORMATION

FD. PK NAIL ON SURFACEW/ 2'-0" TIES NORTH,
SOUTH AND EAST. TIED W/ CROSS TIES AND
SUG FOR STONE. PK NAIL WAS 0.11' NORTH
AND 0.10' WEST OF CENTER OF STONE.

JULY 13, 2009

SET 1" SQUARE IRON PIN
IN MONUMENT BOX OVER
STONE

